





LULU Tub spout for wall-mounted installation - Chrome

13 801 710    Product version from 3/31/2009



- 7-7/8" Projection
- Round aerator
- 1-1/2" hole diameter
- 1/2" connection
- Plug-in connection mounting
- Water flow rate limited to max. 6.2 gpm

	Chrome	13 801 710-00
	Brushed Platinum	13 801 710-06

Required article

	<b>Rough-in adapter -</b>	35 080 970-90 0010
---	---------------------------	-----------------------

# LULU Tub spout for wall-mounted installation - Chrome

13 801 710    Product version from 3/31/2009

mm [inches]

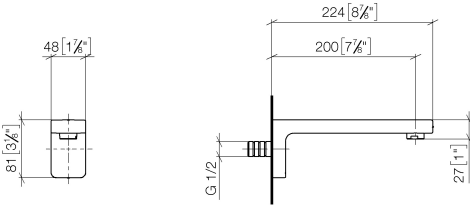

Flow rate chart

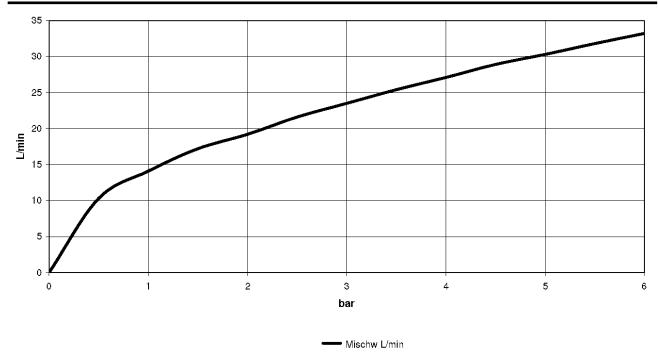

## Codes & Standards

ASME A112.18.1	ASME A112.18.1/CSA B125.1	cUPC	DIN 4109
ISO 3822	Scottish Water Byelaws	UK Water Supply Regulations	Ü-Zeichen



# LULU Tub spout for wall-mounted installation - Chrome

---

13 801 710 Product version from 3/31/2009

## Certificates

---

LGA_9	IAPMO_4976	WRAS_2305
-------	------------	-----------

# LULU Tub spout for wall-mounted installation - Chrome

13 801 710    Product version from 3/31/2009

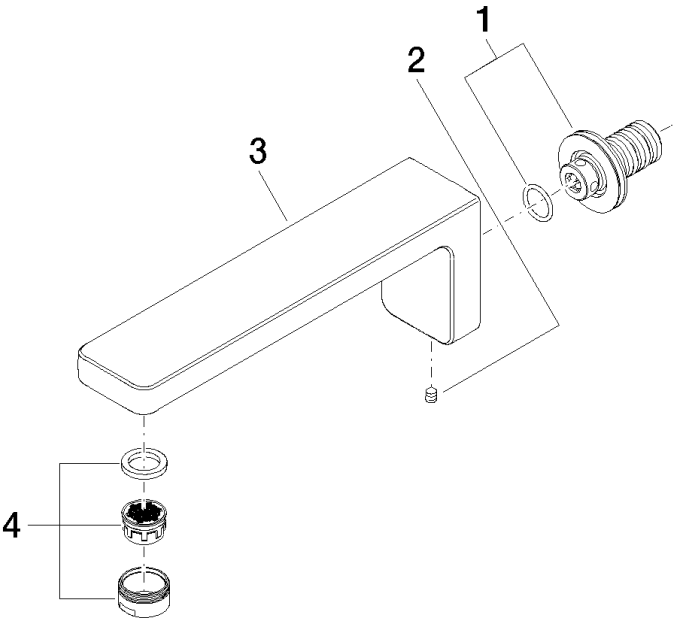

## Spare parts list

Number	Item Number	Designation	Number of units	Lead time
1	90 24 03 108 00 90	nipple set	1	2
2	90 31 11 004 00 90	pin	1	2
3	09 11 71 090 10-00	spout	1	10
4	90 23 01 118 00-00	aerator	1	10