

LISSÉ Tub spout for wall-mounted installation - Chrome







LISSÉ

13 801 845

Product version from 3/9/2016

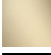

- 8-1/4" Projection
- Round aerator
- 1-1/2" hole diameter
- 1/2" connection
- Plug-in connection mounting
- Water flow rate limited to max. 5.7 gpm

	Chrome	13 801 845-00
	Brushed Platinum	13 801 845-06
	Dark Chrome	13 801 845-19
	Brushed Light Gold	13 801 845-27
	Matte Black	13 801 845-33
	Brushed Chrome	13 801 845-93
	Brushed Dark Platinum	13 801 845-99

Required article

	Rough-in adapter -	35 080 970-90 0010
---	---------------------------	-----------------------

mm [inches]

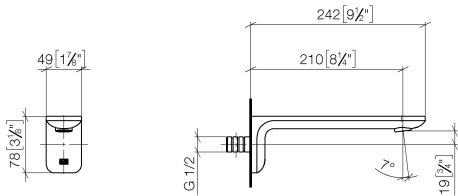

Flow rate chart

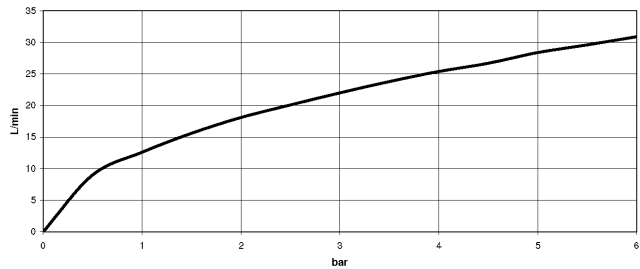

Codes & Standards

ASME A112.18.1	cUPC	DIN 4109	ISO 3822
Scottish Water Byelaws	UK Water Supply Regulations	Ü-Zeichen	



LISSE Tub spout for wall-mounted installation - Chrome

LISSE

13 801 845 Product version from 3/9/2016

Certificates and sustainability

IAPMO_4976 LGA_29 WRAS_2207

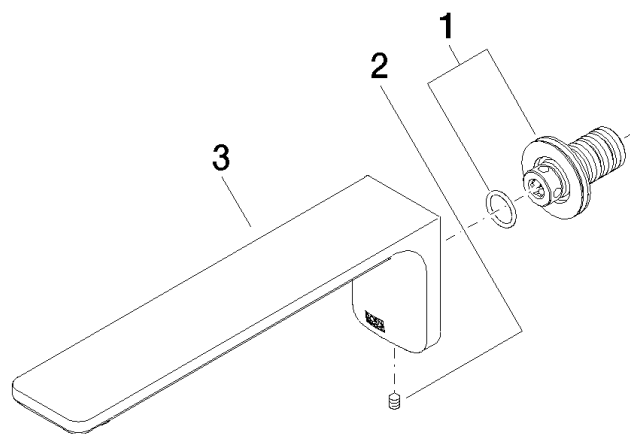

Spare parts list

Number	Item Number	Designation	Number of units	Lead time
1	90 24 03 108 00 90	nipple set	1.00	2
3	90 11 84 014 02-00	spout	1.00	10
2	90 31 11 004 00 90	pin	1.00	2