









LISSE Tub spout for wall-mounted installation - Dark Chrome

LISSE

13 801 845    Product version from 3/9/2016

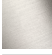

- 8-1/4" Projection
- Round aerator
- 1-1/2" hole diameter
- 1/2" connection
- Plug-in connection mounting
- Water flow rate limited to max. 5.7 gpm

|   |                       |               |
|---|-----------------------|---------------|
|  | Dark Chrome           | 13 801 845-19 |
|  | Chrome                | 13 801 845-00 |
|  | Brushed Platinum      | 13 801 845-06 |
|  | Brushed Light Gold    | 13 801 845-27 |
|  | Matte Black           | 13 801 845-33 |
|  | Brushed Chrome        | 13 801 845-93 |
|  | Brushed Dark Platinum | 13 801 845-99 |

mm [inches]

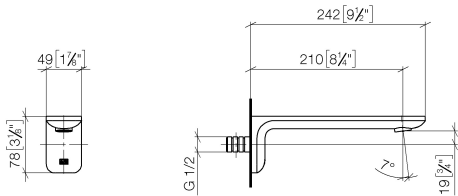

Flow rate chart



### Codes & Standards

|                        |                             |           |          |
|------------------------|-----------------------------|-----------|----------|
| ASME A112.18.1         | cUPC                        | DIN 4109  | ISO 3822 |
| Scottish Water Byelaws | UK Water Supply Regulations | Ü-Zeichen |          |



## LISSE Tub spout for wall-mounted installation - Dark Chrome

LISSE

13 801 845 Product version from 3/9/2016

### Certificates and sustainability

IAPMO\_4976

LGA\_29

WRAS\_2207

Parts for other  
finishes can be found  
here: [Chrome](#)

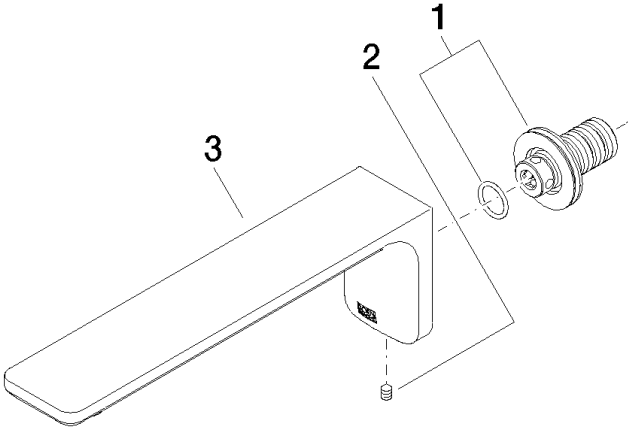

Spare parts list

| Number | Item Number        | Designation | Number of units | Lead time |
|--------|--------------------|-------------|-----------------|-----------|
| 3      | 90 11 84 014 02-19 | spout       | 1.00            | 20        |
| 1      | 90 24 03 108 00 90 | nipple set  | 1.00            | 2         |
| 2      | 90 31 11 004 00 90 | pin         | 1.00            | 2         |