



META Pillar tap cold water only - Brushed Dark Brass

META

17 500 662 Product version from 5/1/2022



- 4-7/8" Projection
 - Rigid spout
 - Round aerated stream
 - Total height 9-1/8"
 - Height to aerator/spout outlet 6-1/4"
 - 1-3/8" hole diameter
 - 1/2" connection
 - Flange diameter 2-3/8"
 - Water flow rate limited to max. 1.2 gpm
 - lead-free
 - This product can help a building meet the requirements of Green Building Rating Systems, e.g. LEED®, BREEAM®, DGNB
- (ADA)

	Brushed Dark Brass	17 500 662-39 0010
	Chrome	17 500 662-00 0010
	Brushed Platinum	17 500 662-06 0010
	Light gold	17 500 662-26 0010
	Brushed Light Gold	17 500 662-27 0010
	Matte Black	17 500 662-33 0010
	Brushed Bronze	17 500 662-42 0010
	Brushed Champagne (22kt Gold)	17 500 662-46 0010
	Champagne (22kt Gold)	17 500 662-47 0010
	Brushed Chrome	17 500 662-93 0010
	Brushed Dark Platinum	17 500 662-99 0010

17 500 662 Product version from 5/1/2022

mm [inches]

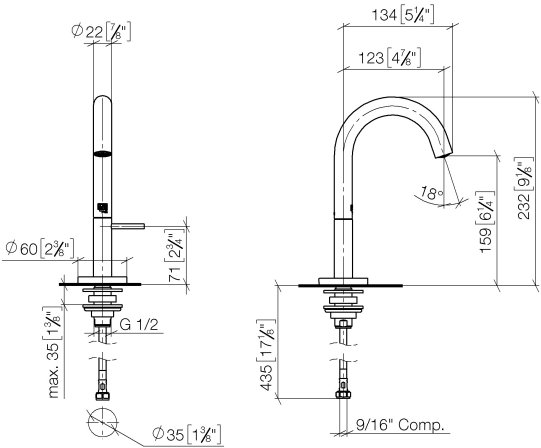

Codes & Standards

ADA	California Energy Commission (CEC)	NSF372	NSF61
-----	------------------------------------	--------	-------

Certificates and sustainability

IAPMO_N-4	IAPMO_6
-----------	---------

Parts for other
finishes can be found
here: [Chrome](#)

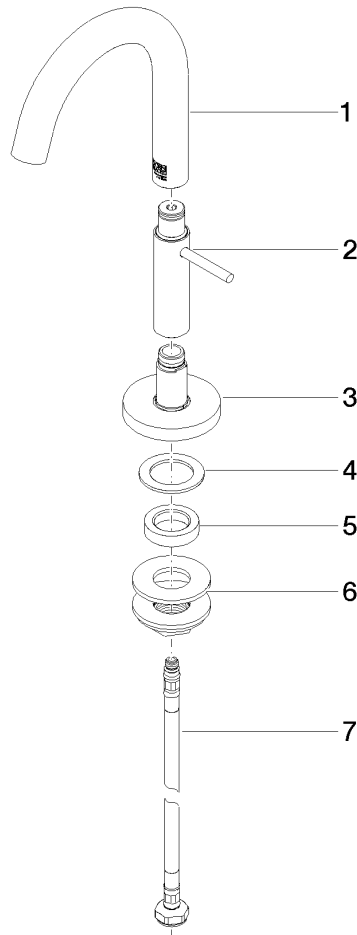

Spare parts list

Number	Item Number	Designation	Number of units	Lead time
2	90 20 66 024 10-39	handle	1.00	30
5	09 28 10 079 90	ring	1.00	60
3	90 27 66 020 00-39	rosette	1.00	30
6	04 23 10 017 00 90	fixing set	1.00	60
1	90 28 22 389 00-39	spout	1.00	30
4	09 14 05 015 90	seal	1.00	2
7	04 30 04 102 00 90	Flexible supply line 3/8" -	1.00	2