







IMO Pillar tap cold water only - Brushed Dark Platinum

IMO

17 500 671 Product version from 4/1/2024



- 4-1/8" Projection
- Rigid spout
- Rectangular aerated stream
- Total height 5"
- Height to aerator/spout outlet 2-5/8"
- 1-3/8" hole diameter
- 1/2" connection
- Flanges, diameter 2"
- Water flow rate limited to max. 1.2 gpm
- lead-free

	Brushed Dark Platinum	17 500 671-99 0010
	Chrome	17 500 671-00 0010
	Brushed Platinum	17 500 671-06 0010
	Dark Chrome	17 500 671-19 0010
	Brushed Light Gold	17 500 671-27 0010
	Matte Black	17 500 671-33 0010
	Brushed Chrome	17 500 671-93 0010

mm [inches]

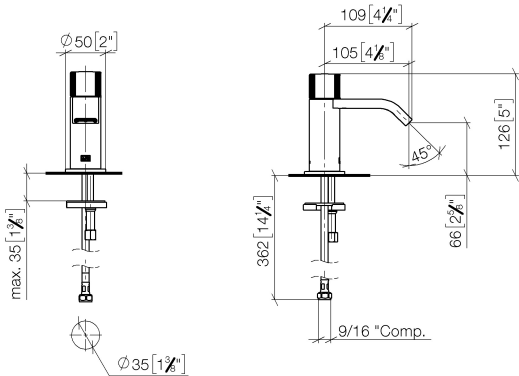

Codes & Standards

ASME A112.18.1	cUPC	EPA WaterSense	NSF372
NSF61	WaterSense		

Certificates and sustainability

IAPMO_N-4976	IAPMO_6397	IAPMO_8834	IAPMO_4976 (
--------------	------------	------------	--------------

Parts for other  
finishes can be found  
here: [Chrome](#)

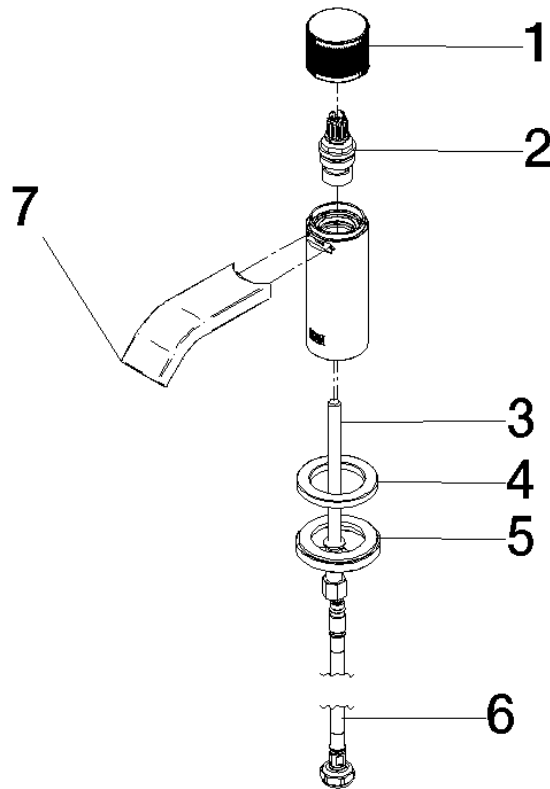

## Spare parts list

Number	Item Number	Designation	Number of units	Lead time
2	90 90 03 135 00 90	top	1.00	2
7	90 28 22 402 00-99	spout	1.00	20
3	09 31 11 012 90	pin	1.00	2
4	09 27 66 006-99	rosette	1.00	20
5	04 30 11 038 00 90	fixing set	1.00	2
6	04 30 04 102 00 90	Flexible supply line 3/8" -	1.00	2
1	09 20 66 012-99	handle	1.00	60