



LOT HOT & COLD WATER DISPENSER - Chrome

LOT

17 861 680 Product version from 4/1/2014 to 5/27/2021



- 5-3/4" Projection
- Rigid, thermally insulated spout
- Laminar stream
- Total height 9-1/8"
- 8-3/8" height to aerator/spout outlet
- 1-3/8" hole diameter
- Provides filtered, hot water, 199°F max. temperature
- Provides filtered, cold water (not chilled)
- Water flow rate limited to max. 0.5 gpm
- control unit for wall assembly (5-3/8" x 6-1/4" x 2-3/8")
- electronic valve
- plug-in power supply, 100-230 V, 50-60 Hz, 18 W, incl. country-specific adaptor set
- lead-free
- One lever for hot and cold water
- Spout ring cannot be removed.
- This product can help a building meet the requirements of Green Building Rating Systems, e.g. LEED®, BREEAM®, DGNB

(ADA)

NOTE: Not compatible with Reverse Osmosis

Compatible with Insinkerator® hot water tank HWT300-F3000S. Tank and filter not supplied from Dornbracht. More information on tank and filter at www.inksinkerator.com.

The installation must be above a kitchen sink.

We recommend replacing the filter cartridge every six months. Please see the installation manual for more information.

Specification and technical data sheets can be found on www.dornbracht.com/professional

	Chrome	17 861 680-00
	Brushed Platinum	17 861 680-06
	Platinum	17 861 680-08
	Dark Chrome	17 861 680-19
	Brushed Durabrass (23kt Gold)	17 861 680-28
	Brushed Champagne (22kt Gold)	17 861 680-46
	Champagne (22kt Gold)	17 861 680-47
	Brushed Dark Platinum	17 861 680-99

LOT HOT & COLD WATER DISPENSER - Chrome

LOT

17 861 680 Product version from 4/1/2014 to 5/27/2021

mm [inches]

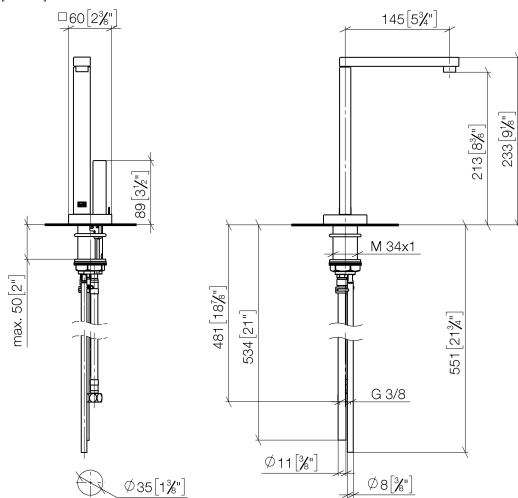

Flow rate chart



Codes & Standards

ADA	ASME A112.18.1	California Energy Commission (CEC)	cUPC
DIN 4109	ISO 3822	NSF372	NSF61

Ü-Zeichen



LOT HOT & COLD WATER DISPENSER - Chrome

LOT

17 861 680 Product version from 4/1/2014 to 5/27/2021

Certificates and sustainability

IAPMO_N-4	IAPMO_4976	LGA_28	IAPMO_6
-----------	------------	--------	---------

LOT HOT & COLD WATER DISPENSER - Chrome

LOT

17 861 680 Product version from 4/1/2014 to 5/27/2021

Parts for other
finishes can be found
here: Brushed
Platinum

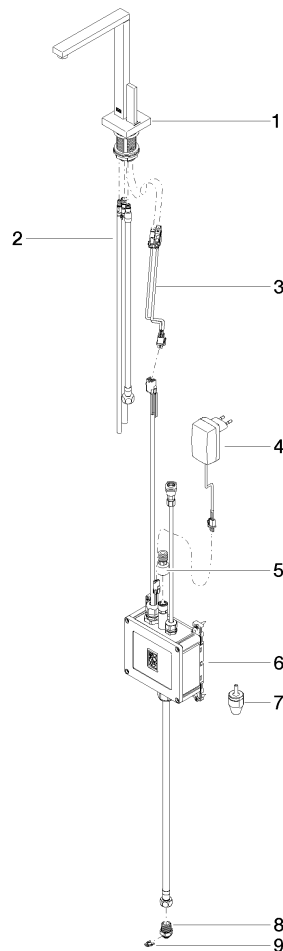

Spare parts list

Number	Item Number	Designation	Number of units	Lead time
9	09 16 01 045 90	ring	1.00	2
4	04 10 01 050 00 90	power supply	1.00	60
1	90 17 85 100 03-00	fitting	1.00	10
7	90 24 04 291 00 90	insert	1.00	2
8	09 24 04 293 90	nipple	1.00	2
3	90 10 01 048 00 90	electronic accessories	1.00	2
5	12 866 970 90	Adapter Flow reducer HCWD 3/8" -	1.00	2
2	90 30 04 067 00 90	hose	1.00	2
6	90 11 11 064 01 90	electronic accessories	1.00	2