



MEM Deck valve counter-clockwise closing hot - Chrome

20 000 783 Product version from 3/10/2014



- 1-1/4" hole diameter
 - Flange 2-3/8" x 2-3/8"
 - with marking for hot
- (ADA)

	Chrome	20 000 783-00
	Brushed Platinum	20 000 783-06
	Platinum	20 000 783-08
	Dark Chrome	20 000 783-19
	Brushed Durabronze (23kt Gold)	20 000 783-28
	Brushed Champagne (22kt Gold)	20 000 783-46
	Champagne (22kt Gold)	20 000 783-47
	Brushed Dark Platinum	20 000 783-99

MEM Deck valve counter-clockwise closing hot - Chrome

20 000 783 Product version from 3/10/2014

mm [inches]

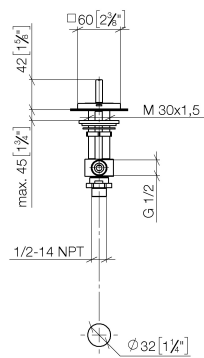

Flow rate chart

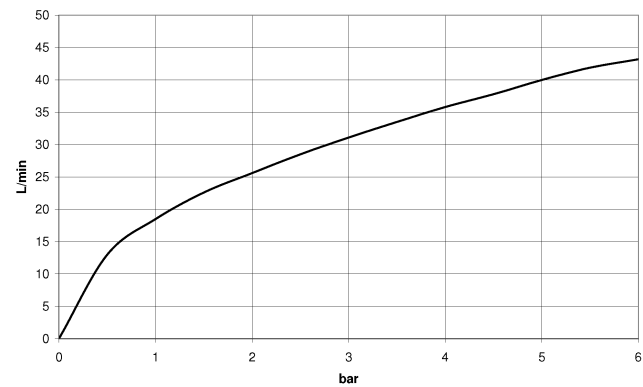

Codes & Standards

ADA	ASME A112.18.1	ASME A112.18.1/CSA B125.1	cUPC
Scottish Water Byelaws	UK Water Supply Regulations		



MEM Deck valve counter-clockwise closing hot - Chrome

20 000 783 Product version from 3/10/2014

Certificates

IAPMO_4976

WRAS_2103

MEM Deck valve counter-clockwise closing hot - Chrome

20 000 783 Product version from 3/10/2014

Parts for other
finishes can be found
here: Brushed
Platinum

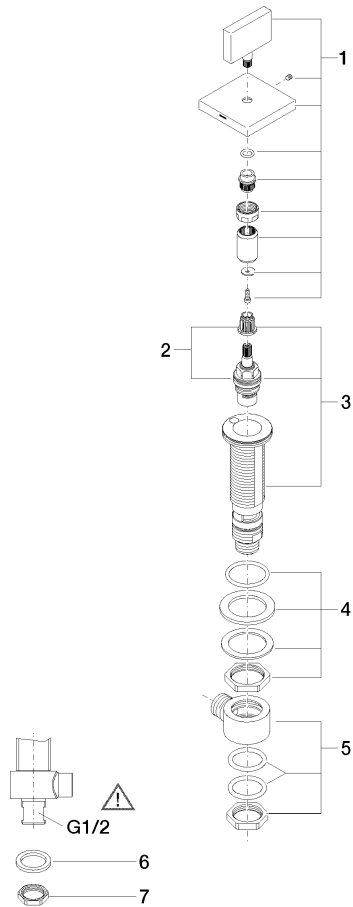

Spare parts list

Number	Item Number	Designation	Number of units	Lead time
1	90 20 78 002 05-00	handle (hot)	1	10
2	90 90 03 132 00 90	top	1	2
3	04 17 11 058 32 90	side panel	1	2
4	04 23 10 032 78 90	fixing set	1	2
5	04 17 11 023 10 90	distributor	1	2
6	09 30 11 059 90	disc	1	2
7	09 23 10 012 90	nut	1	2