



MEM Three-hole lavatory mixer with drain - Dark Chrome

MEM

20 713 782



- 6-1/2" Projection
- US drain with overflow
- Rigid spout
- Rectangular aerated stream
- Total height 10-7/8"
- Height to aerator/spout outlet 6-3/4"
- Spout hole diameter 1-3/8"
- Valve hole diameter 1-1/4"
- Flange 2-3/8" x 2-3/8"
- 2x 3/8" flexible supply lines
- Water flow rate limited to max. 1.2 gpm
- lead-free
- This product can help a building meet the requirements of Green Building Rating Systems, e.g. LEED®, BREEAM®, DGNB

(ADA)

Suitable only for basins with overflow.

|   |                                |                    |
|---|--------------------------------|--------------------|
|  | Dark Chrome                    | 20 713 782-19 0010 |
|  | Chrome                         | 20 713 782-00 0010 |
|  | Brushed Platinum               | 20 713 782-06 0010 |
|  | Platinum                       | 20 713 782-08 0010 |
|  | Brushed Durabronze (23kt Gold) | 20 713 782-28 0010 |
|  | Brushed Champagne (22kt Gold)  | 20 713 782-46 0010 |
|  | Champagne (22kt Gold)          | 20 713 782-47 0010 |
|  | Brushed Dark Platinum          | 20 713 782-99 0010 |

20 713 782

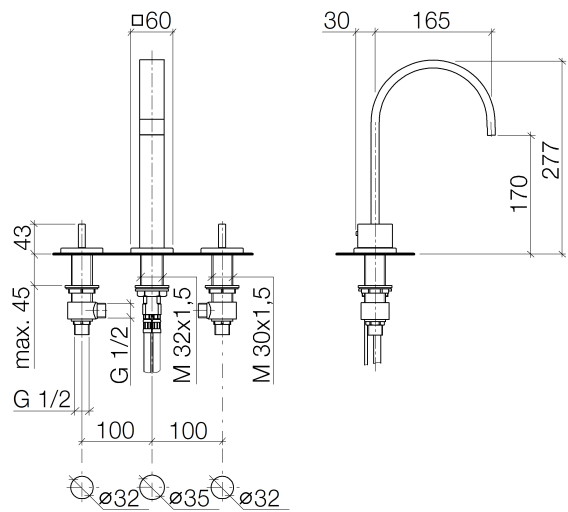

| Codes & Standards |                |                                    |      |
|-------------------|----------------|------------------------------------|------|
| ADA               | ASME A112.18.1 | California Energy Commission (CEC) | cUPC |
| NSF372            | NSF61          |                                    |      |

| Certificates and sustainability |            |         |
|---------------------------------|------------|---------|
| IAPMO_N-4                       | IAPMO_4976 | IAPMO_6 |

# MEM Three-hole lavatory mixer with drain - Dark Chrome

MEM

20 713 782

Parts for other  
finishes can be found  
here: [Chrome](#)

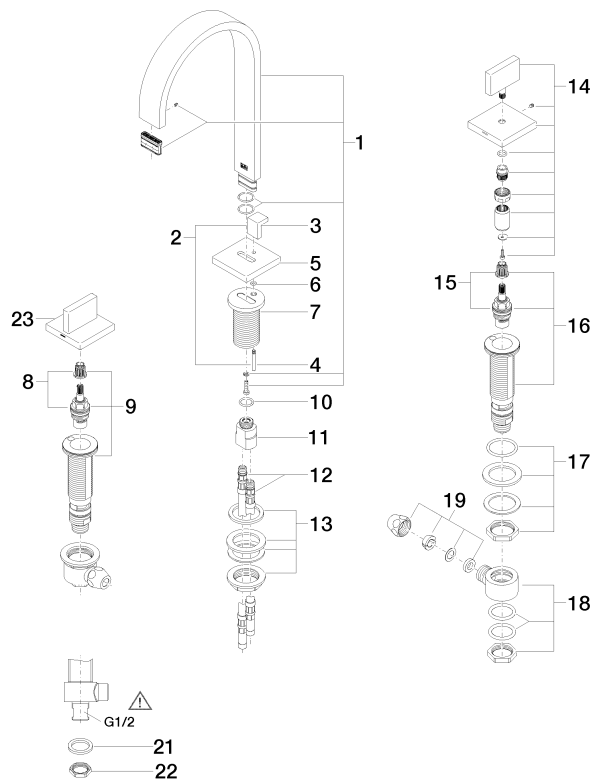

20 Abbildungscode 94.11.01.002.00-0