



CYO Three-hole lavatory mixer with drain - Durabrand / Brushed Durabrand
(23kt Gold)

CYO

20 713 811



- 6-5/8" Projection
 - US drain with overflow
 - Rigid spout
 - Rectangular aerated stream
 - Total height 7-3/4"
 - Height to aerator/spout outlet 5-1/4"
 - Spout hole diameter 1-3/8"
 - Valve hole diameter 1-1/4"
 - Handle Ø 2-3/8"
 - Water flow rate limited to max. 1.2 gpm
 - lead-free
 - This product can help a building meet the requirements of Green Building Rating Systems, e.g. LEED®, BREEAM®, DGNB
- NOTE: Handle inserts are sold separately!

| | | |
|---|--|--------------------|
|  | Durabrand / Brushed Durabrand (23kt Gold) | 20 713 811-38 0010 |
|  | Chrome | 20 713 811-00 0010 |
|  | Brushed Platinum | 20 713 811-06 0010 |
|  | Dark Chrome | 20 713 811-19 0010 |
|  | Brushed Durabrand (23kt Gold) | 20 713 811-28 0010 |
|  | Platinum / Brushed Platinum | 20 713 811-36 0010 |
|  | Brushed Dark Platinum | 20 713 811-99 0010 |



CYO Three-hole lavatory mixer with drain - Durabronss / Brushed Durabronss
(23kt Gold)

CYO

20 713 811
mm [inches]

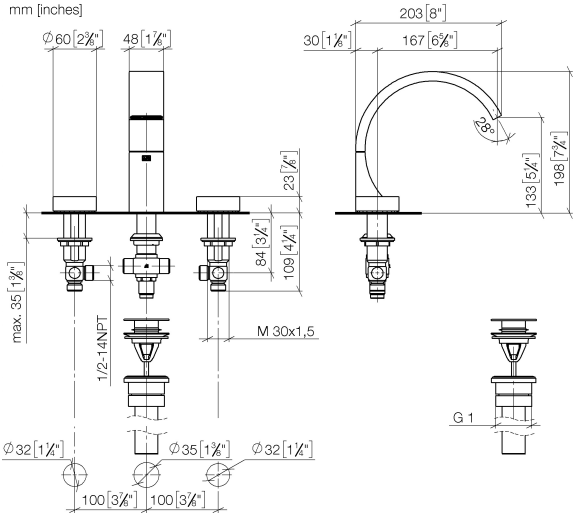

Codes & Standards

| | | |
|--|--------|-------|
| California Energy Commission (CEC) | NSF372 | NSF61 |
|--|--------|-------|

Certificates and sustainability

| | |
|-----------|---------|
| IAPMO_N-4 | IAPMO_6 |
|-----------|---------|

CYO Three-hole lavatory mixer with drain - Durabronss / Brushed Durabronss (23kt Gold)

CYO

20 713 811

Parts for other
finishes can be found
here: Chrome

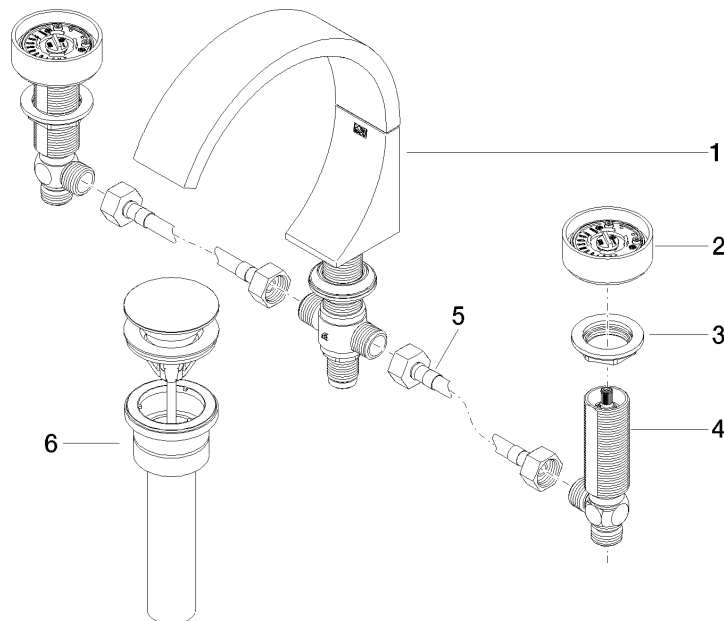

Spare parts list

| Number | Item Number | Designation | Number of units | Lead time |
|--|--------------------|---|-----------------|-----------|
| 3 | 04 30 11 038 67 90 | fixing set | 2.00 | 2 |
| 6 | 10 125 970-38 0010 | pop-up waste | 1.00 | - |
| Spare part can no longer be ordered, please order the replacement item | | | | |
| 4 | 04 17 11 055 61 90 | side panel | 2.00 | 2 |
| 1 | 13 717 811-38 | CYO Lavatory spout, deck-mounted without drain - Durabronss / Brushed Durabronss (23kt Gold) | 1.00 | 20 |
| 2 | 90 18 40 290 00-38 | handle | 2.00 | 20 |
| 5 | 04 30 04 096 00 90 | hose | 2.00 | 2 |