





DORNBRACHT YAMOU Three-hole lavatory mixer with drain - Chrome

DORNBRACHT
YAMOU

20 713 831 Product version from 1/1/2023



- 4-7/8" Projection
- US drain with overflow
- Round aerated stream
- Total height 3-7/8"
- Height to aerator/spout outlet 3-3/8"
- Valve hole diameter 1-1/4"
- Spout hole diameter 1-3/8"
- Flange diameter 2-3/8"
- Water flow rate limited to max. 1.2 gpm
- Flange diameter 2-3/8"

	Chrome	20 713 831-00 0010
	Soft Black	20 713 831-69 0010

20 713 831 Product version from 1/1/2023

mm [inches]

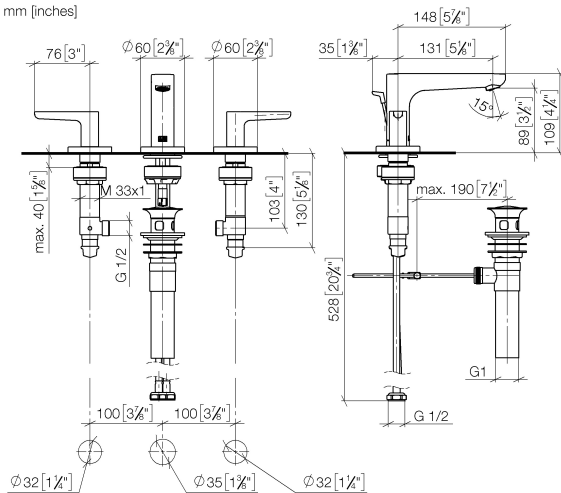

Codes & Standards

ADA	ASME A112.18.1	California Energy Commission (CEC)	cUPC
EPA WaterSense	NSF372	NSF61	WaterSense



Certificates and sustainability

IAPMO_8834	IAPMO_N-4976	IAPMO_6397	IAPMO_4976 (
------------	--------------	------------	--------------

Parts for other finishes can be found here: [Soft Black](#)

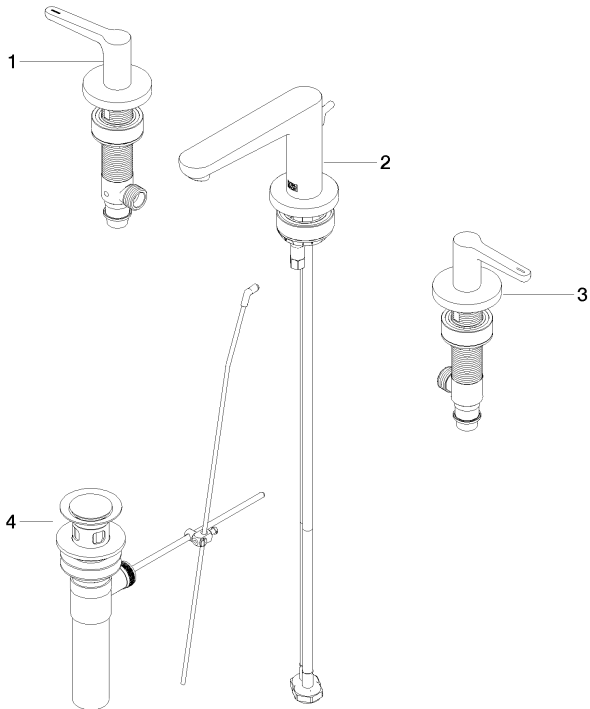

Spare parts list

Number	Item Number	Designation	Number of units	Lead time
1	90 20 83 067 00-00	handle (hot)	1.00	2
2	90 19 83 015 00-00	spout	1.00	2
3	90 20 83 066 00-00	handle (cold)	1.00	2
4	90 11 01 200 01-00	pop-up waste	1.00	2