



MEM Three-hole lavatory mixer with drain - Brushed Dark Platinum

MEM

20 715 782 Product version from 3/10/2014



- 7-7/8" Projection
  - Rigid spout
  - US drain with overflow
  - Rectangular aerated stream
  - Total height 12-5/8"
  - Height to aerator/spout outlet 7-5/8"
  - Spout hole diameter 1-3/8"
  - Valve hole diameter 1-1/4"
  - Flange 2-3/8" x 2-3/8"
  - 2x 3/8" flexible supply lines
  - Water flow rate limited to max. 1.2 gpm
  - lead-free
  - This product can help a building meet the requirements of Green Building Rating Systems, e.g. LEED®, BREEAM®, DGNB
- (ADA)
- Suitable only for basins with overflow.

	Brushed Dark Platinum	20 715 782-99 0010
	Chrome	20 715 782-00 0010
	Brushed Platinum	20 715 782-06 0010
	Platinum	20 715 782-08 0010
	Dark Chrome	20 715 782-19 0010
	Brushed Durabronze (23kt Gold)	20 715 782-28 0010
	Brushed Champagne (22kt Gold)	20 715 782-46 0010
	Champagne (22kt Gold)	20 715 782-47 0010

## MEM Three-hole lavatory mixer with drain - Brushed Dark Platinum

MEM

20 715 782 Product version from 3/10/2014

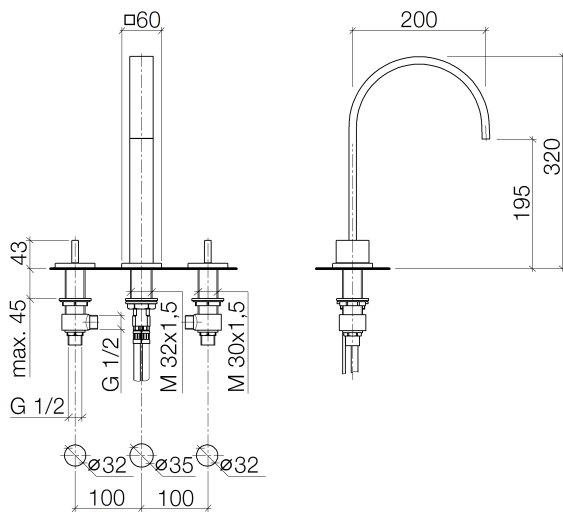

### Codes & Standards

ADA	ASME A112.18.1	California Energy Commission (CEC)	cUPC
EPA WaterSense	NSF372	NSF61	WaterSense



### Certificates and sustainability

IAPMO_8834	IAPMO_N-4	IAPMO_4976	IAPMO_6
------------	-----------	------------	---------

MEM Three-hole lavatory mixer with drain - Brushed Dark Platinum

MEM

20 715 782 Product version from 3/10/2014

Parts for other finishes can be found here: [Chrome](#)

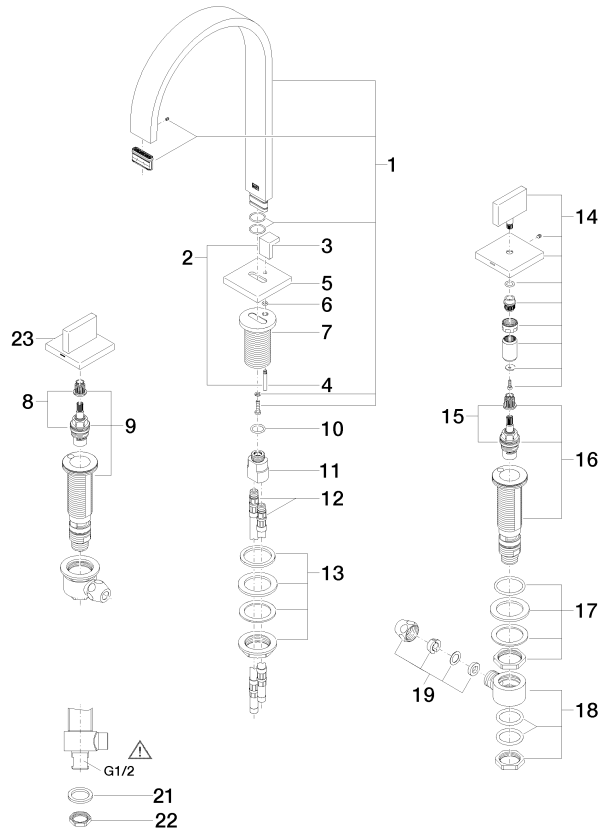

20 ————— Abrechnung vom 04.11.2013.00-V



## MEM Three-hole lavatory mixer with drain - Brushed Dark Platinum

MEM

20 715 782 Product version from 3/10/2014

### Spare parts list

Number	Item Number	Designation	Number of units	Lead time
9	04 17 11 058 52 90	side panel	1.00	2
1	90 28 22 155 02-99	spout	1.00	20
2	04 20 78 030 80-99	pull-rod	1.00	20
10	09 14 10 130 90	seal	1.00	2
3	09 20 78 030-99	handle	1.00	20
7	09 11 10 054 10 90	connection	1.00	2
4	09 31 09 080-99	pull-rod	1.00	20
6	09 14 10 166 90	seal	1.00	2
5	09 27 78 032-99	rosette	1.00	20
8	90 90 03 152 00 90	top	1.00	2
21	09 30 11 059 90	disc	2.00	2
15	90 90 03 153 00 90	top	1.00	2
20	90 11 01 023 00-99	pop-up waste	1.00	20
17	04 23 10 032 78 90	fixing set	1.00	2
16	04 17 11 058 53 90	side panel	1.00	2
12	04 30 04 016 00 90	hose	1.00	60
19	90 23 30 040 00-99	threaded connector	1.00	20
22	09 23 10 012 90	nut	2.00	2
18	04 17 11 023 10 90	distributor	1.00	2
14	90 20 78 002 04-99	handle ( cold )	1.00	20
23	90 20 78 002 05-99	handle ( hot )	1.00	20
11	09 11 10 055 10 90	connection	1.00	2
13	04 23 10 009 01 90	fixing set	1.00	2