

TARA Three-hole mixer - Chrome

TARA

20 816 892 Product version from 4/1/2024



- 9-1/4" Projection
- Swiveling spout 360°
- Aerated stream
- Total height 14-5/8"
- Height to aerator/spout outlet 8-3/8"
- Spout hole diameter 1-3/8"
- Valve hole diameter 1-1/4"
- Water flow rate limited to max. 1.5 gpm
- lead-free
- This product can help a building meet the requirements of Green Building Rating Systems, e.g. LEED®, BREEAM®, DGNB

(ADA)

| | | |
|---|--------------------------------|--------------------|
|  | Chrome | 20 816 892-00 0010 |
|  | Brushed Platinum | 20 816 892-06 0010 |
|  | Platinum | 20 816 892-08 0010 |
|  | Durabronze (23kt Gold) | 20 816 892-09 0010 |
|  | Dark Chrome | 20 816 892-19 0010 |
|  | Brushed Durabronze (23kt Gold) | 20 816 892-28 0010 |
|  | Matte Black | 20 816 892-33 0010 |
|  | Brushed Bronze | 20 816 892-42 0010 |
|  | Brushed Champagne (22kt Gold) | 20 816 892-46 0010 |
|  | Champagne (22kt Gold) | 20 816 892-47 0010 |
|  | Brushed Chrome | 20 816 892-93 0010 |
|  | Brushed Dark Platinum | 20 816 892-99 0010 |

Recommended article

AIR SWITCH operating button, trim parts only - Chrome

10 713 970-00



Recommended article

Soap dispenser with flange - Chrome

82 444 970-00



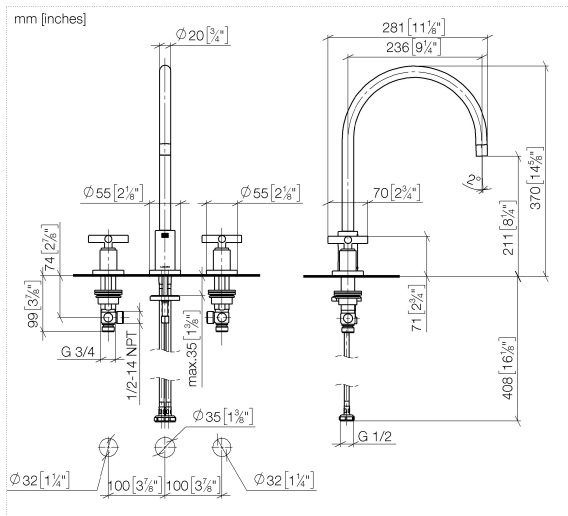

Codes & Standards

ADA

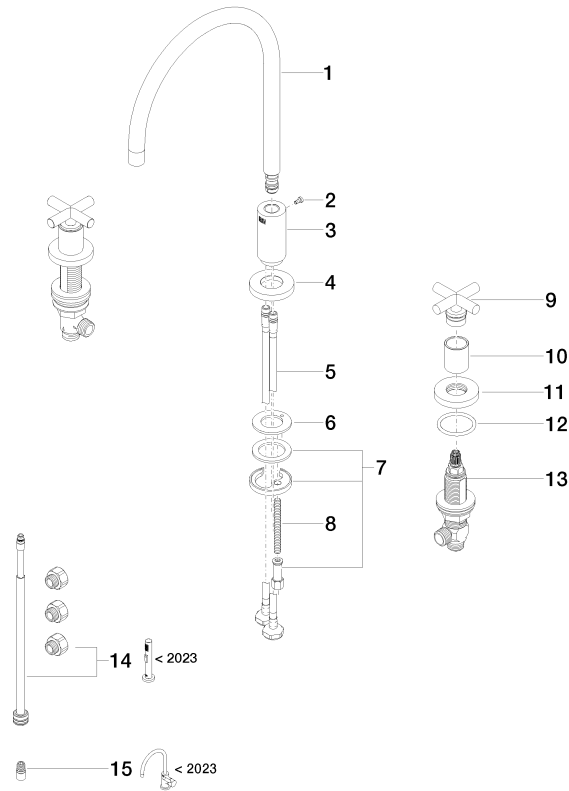

Spare parts list

| Number | Item Number | Designation | Number of units | Lead time |
|--------|--------------------|----------------|-----------------|-----------|
| 5 | 04 30 04 019 00 90 | hose | 2.00 | 2 |
| 15 | 90 24 03 537 01 90 | adaptor | 1.00 | 2 |
| 1 | 90 28 22 226 02-00 | spout | 1.00 | 10 |
| 12 | 90 14 10 043 00 90 | seal | 2.00 | 2 |
| 3 | 09 11 10 036-00 | connection | 1.00 | 10 |
| 7 | 04 30 11 038 00 90 | fixing set | 1.00 | 2 |
| 13 | 90 17 11 040 51 90 | side panel | 2.00 | 2 |
| 6 | 09 14 05 047 90 | seal | 1.00 | 2 |
| 4 | 09 28 10 140-00 | ring | 1.00 | 10 |
| 11 | 09 27 89 105-00 | rosette | 2.00 | 10 |
| 2 | 09 30 30 057 90 | screw | 1.00 | 2 |
| 14 | 90 17 09 046 13 90 | conversion kit | 1.00 | 2 |
| 10 | 09 21 02 140-00 | sleeve | 2.00 | 10 |
| 9 | 90 20 89 010 10-00 | handle | 2.00 | 10 |
| 8 | 09 31 11 011 90 | pin | 1.00 | 2 |