

TARA Three-hole mixer - Brushed Durabronze (23kt Gold)

TARA

20 816 892 Product version from 4/1/2024



- 9-1/4" Projection
- Swiveling spout 360°
- Aerated stream
- Total height 14-5/8"
- Height to aerator/spout outlet 8-3/8"
- Spout hole diameter 1-3/8"
- Valve hole diameter 1-1/4"
- Water flow rate limited to max. 1.5 gpm
- lead-free
- This product can help a building meet the requirements of Green Building Rating Systems, e.g. LEED®, BREEAM®, DGNB

(ADA)

	Brushed Durabronze (23kt Gold)	20 816 892-28 0010
	Chrome	20 816 892-00 0010
	Brushed Platinum	20 816 892-06 0010
	Platinum	20 816 892-08 0010
	Durabronze (23kt Gold)	20 816 892-09 0010
	Dark Chrome	20 816 892-19 0010
	Matte Black	20 816 892-33 0010
	Brushed Bronze	20 816 892-42 0010
	Brushed Champagne (22kt Gold)	20 816 892-46 0010
	Champagne (22kt Gold)	20 816 892-47 0010
	Brushed Chrome	20 816 892-93 0010
	Brushed Dark Platinum	20 816 892-99 0010

Recommended article

AIR SWITCH operating button, trim parts only - Brushed Durabronze (23kt Gold)

10 713 970-28



Recommended article

Soap dispenser with flange - Brushed Durabronze (23kt Gold)

82 444 970-28



TARA Three-hole mixer - Brushed Durabrass (23kt Gold)

TARA

20 816 892 Product version from 4/1/2024

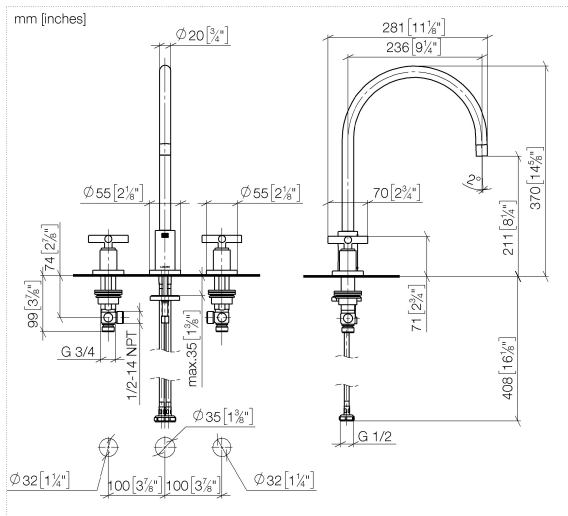

Codes & Standards

ADA

20 816 892 Product version from 4/1/2024

Parts for other
finishes can be found
here: [Chrome](#)

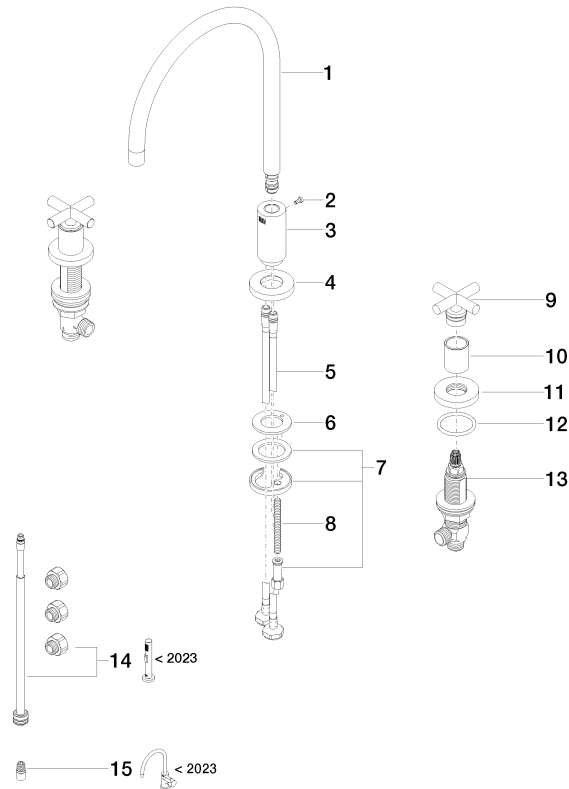

Spare parts list

Number	Item Number	Designation	Number of units	Lead time
1	90 28 22 226 02-28	spout	1.00	20
9	90 20 89 010 10-28	handle	2.00	20
5	04 30 04 019 00 90	hose	2.00	2
4	09 28 10 140-28	ring	1.00	20
2	09 30 30 057 90	screw	1.00	2
7	04 30 11 038 00 90	fixing set	1.00	2
14	90 17 09 046 13 90	conversion kit	1.00	2
13	90 17 11 040 51 90	side panel	2.00	2
11	09 27 89 105-28	rosette	2.00	20
12	90 14 10 043 00 90	seal	2.00	2
15	90 24 03 537 01 90	adaptor	1.00	2
10	09 21 02 140-28	sleeve	2.00	20
6	09 14 05 047 90	seal	1.00	2
3	09 11 10 036-28	connection	1.00	60
8	09 31 11 011 90	pin	1.00	2