

Slide bar set without hand shower - Matte Black

26 413 625 Product version from 10/1/2023



- Slide bar
- Pipe diameter 3/4"
- Flange diameter 2-1/8"
- Center to center 31-1/2"
- Metal shower hose 68-7/8" with anti-twist device
- Shower hose connection 3/8"

This article does not include a hand shower!

NOTE: Hand shower sold separately. Please see hand shower options under the miscellaneous articles section of each series.

	Matte Black	26 413 625-33
	Chrome	26 413 625-00
	Brushed Platinum	26 413 625-06
	Platinum	26 413 625-08
	Dark Chrome	26 413 625-19
	Light gold	26 413 625-26
	Brushed Light Gold	26 413 625-27
	Brushed Durabronze (23kt Gold)	26 413 625-28
	Brushed Bronze	26 413 625-42
	Brushed Champagne (22kt Gold)	26 413 625-46
	Champagne (22kt Gold)	26 413 625-47
	Brushed Chrome	26 413 625-93
	Brushed Dark Platinum	26 413 625-99

Recommended article

	Rough-in adapter - •Please order rough-in adapter 35 080 970-90 0010 if installed with wall elbow.	35 080 970-90 0010
--	--	--------------------

Required article

	Hand shower FlowReduce - Matte Black	28 016 979-33 0010
--	---	--------------------

Required article

	Hand shower FlowReduce - Matte Black	28 018 979-33 0010
--	---	--------------------

Required article

	SERIES-VARIOUS Hand shower FlowReduce - Matte Black	28 027 979-33 0010
--	--	--------------------

Recommended article

	Wall elbow - Matte Black	28 450 625-33
--	---------------------------------	---------------

Required article

	Hand shower FlowReduce - Matte Black	28 012 979-33 0010
--	---	--------------------

Required article

	SERIES-VARIOUS Hand shower FlowReduce - Matte Black	28 029 979-33 0010
--	--	--------------------

Required article

	SERIES-VARIOUS Hand shower FlowReduce - Matte Black	28 025 979-33 0010
--	--	--------------------

Slide bar set without hand shower - Matte Black

26 413 625 Product version from 10/1/2023

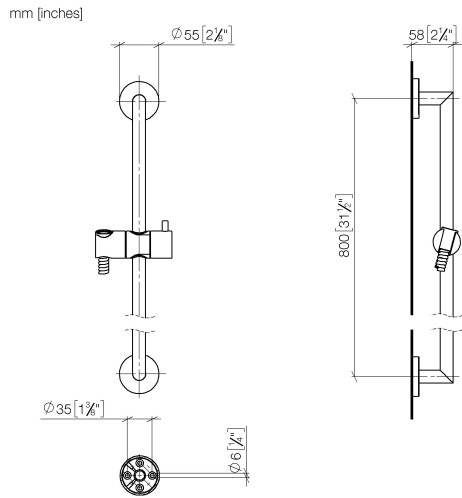

Codes & Standards

ASME A112.18.1	cUPC	Scottish Water Byelaws	UK Water Supply Regulations
XP P 41-280			

Certificates

WRAS_2009	ACS_20 ACC LY	IAPMO_4976
-----------	---------------	------------

Slide bar set without hand shower - Matte Black

26 413 625 Product version from 10/1/2023

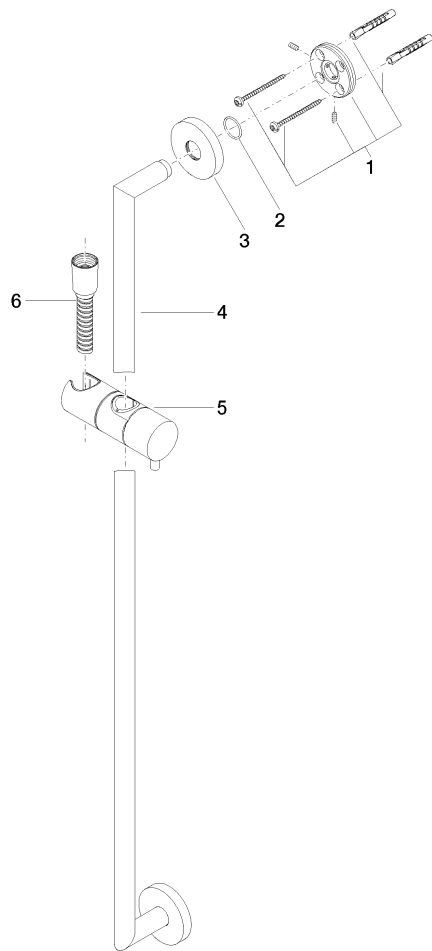

Spare parts list

Number	Item Number	Designation	Number of units	Lead time
1	05 17 62 500 00 90	fixing set	2	2
2	90 14 10 032 00 90	seal	2	2
3	08 27 62 500-33	rosette	2	30
4	05 28 22 590 01-33	bar	1	30
5	12 580 970-33	Slider - Matte Black	1	10
6	28 322 970-33	Metal shower hose 1/2" x 3/8" x 68-7/8" - Matte Black	1	2