

VAIA Slide bar set without hand shower - Brushed Platinum

26 413 809



- Slide bar
- Flange diameter 2-3/8"
- Center to center 31-1/2"
- Metal shower hose 66-7/8" with anti-twist device
- Shower hose connection 3/8"
- Pipe diameter 3/4"

This article does not include a hand shower!

NOTE: Hand shower sold separately. Please see hand shower options under the miscellaneous articles section of each series.

| | | |
|---|--------------------------------|---------------|
|  | Brushed Platinum | 26 413 809-06 |
|  | Chrome | 26 413 809-00 |
|  | Platinum | 26 413 809-08 |
|  | Dark Chrome | 26 413 809-19 |
|  | Brushed Durabronze (23kt Gold) | 26 413 809-28 |
|  | Brushed Bronze | 26 413 809-42 |
|  | Brushed Champagne (22kt Gold) | 26 413 809-46 |
|  | Champagne (22kt Gold) | 26 413 809-47 |
|  | Brushed Dark Platinum | 26 413 809-99 |

Recommended article

| | | |
|---|---|--------------------|
|  | Rough-in adapter - • Please order rough-in adapter 35 080 970-90 0010 if installed with wall elbow. | 35 080 970-90 0010 |
|---|---|--------------------|

Recommended article

| | | |
|---|---|---------------|
|  | VAIA Wall elbow - Brushed Platinum | 28 450 809-06 |
|---|---|---------------|

Required article

| | | |
|---|--|--------------------|
|  | Hand shower FlowReduce - Brushed Platinum | 28 016 979-06 0010 |
|---|--|--------------------|

Required article

| | | |
|---|--|--------------------|
|  | Hand shower FlowReduce - Brushed Platinum | 28 018 979-06 0010 |
|---|--|--------------------|

Required article

| | | |
|---|---|--------------------|
|  | SERIES-VARIOUS Hand shower FlowReduce - Brushed Platinum | 28 025 979-06 0010 |
|---|---|--------------------|

Recommended article

| | | |
|---|---------------------------|--------------------|
|  | Rough-in adapter - | 35 080 970-90 0010 |
|---|---------------------------|--------------------|

Recommended article

| | | |
|---|---|---------------|
|  | VAIA Wall elbow - Brushed Platinum | 28 450 809-06 |
|---|---|---------------|

Required article

| | | |
|---|--|--------------------|
|  | Hand shower FlowReduce - Brushed Platinum | 28 012 979-06 0010 |
|---|--|--------------------|

Required article

| | | |
|---|---|--------------------|
|  | SERIES-VARIOUS Hand shower FlowReduce - Brushed Platinum | 28 027 979-06 0010 |
|---|---|--------------------|

VAIA Slide bar set without hand shower - Brushed Platinum

26 413 809

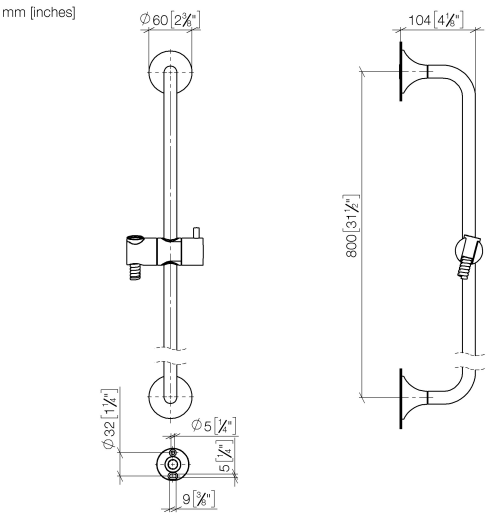

Codes & Standards

| | | | |
|----------------|------|---------------------------|--------------------------------|
| ASME A112.18.1 | cUPC | Scottish Water Byelaws | UK Water Supply Regulations |
| XP P 41-280 | | | |

Certificates

| | | | |
|-----------|---------------|------------|--|
| WRAS_2009 | ACS_20 ACC LY | IAPMO_4976 | |
|-----------|---------------|------------|--|

VAIA Slide bar set without hand shower - Brushed Platinum

26 413 809

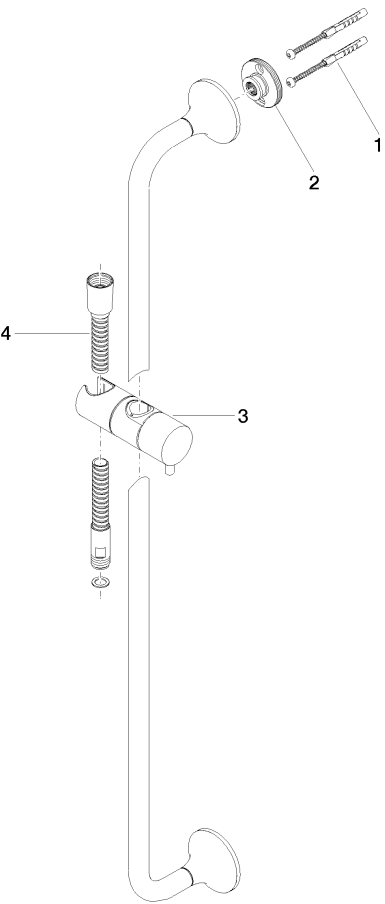

Spare parts list

| Number | Item Number | Designation | Number of units | Lead time |
|--------|--------------------|--|-----------------|-----------|
| 1 | 05 30 31 025 00 90 | fixing set | 2 | 2 |
| 2 | 90 17 20 759 00 90 | disc | 2 | 2 |
| 3 | 12 580 970-06 | Slider - Brushed Platinum | 1 | 10 |
| 4 | 28 322 970-06 | Metal shower hose 1/2" x 3/8" x 68-7/8" - Brushed Platinum | 1 | 2 |