

VAIA Slide bar set without hand shower - Platinum

VAIA

26 413 809 Product version from 4/1/2025



- Shower hose connection 3/8"
- Metal shower hose 66-7/8" with anti-twist device
- Slide bar

Technical data:

- Center to center 31-1/2"
- Flange diameter 2-3/8"
- Pipe diameter 3/4"

Notes:

This article does not include a hand shower!

NOTE: Hand shower sold separately. Please see hand shower options under the miscellaneous articles section of each series.

	Platinum	26 413 809-08
	Chrome	26 413 809-00
	Brushed Platinum	26 413 809-06
	Dark Chrome	26 413 809-19
	Brushed Durabronze (23kt Gold)	26 413 809-28
	Brushed Dark Brass	26 413 809-39
	Brushed Bronze	26 413 809-42
	Brushed Champagne (22kt Gold)	26 413 809-46
	Champagne (22kt Gold)	26 413 809-47
	Brushed Dark Platinum	26 413 809-99

Recommended article

	Rough-in adapter - •Please order rough-in adapter 35 080 970-90 0010 if installed with wall elbow.	35 080 970-90 0010
---	--	--------------------

Recommended article

	VAIA Wall elbow - Platinum	28 450 809-08
---	-----------------------------------	---------------

Required article

	Hand shower FlowReduce - Platinum	28 016 979-08 0010
---	--	--------------------

Required article

	Hand shower FlowReduce - Platinum	28 018 979-08 0010
---	--	--------------------

Required article

	SERIES-VARIOUS Hand shower FlowReduce - Platinum	28 027 979-08 0010
---	---	--------------------

Recommended article

	Rough-in adapter -	35 080 970-90 0010
---	---------------------------	--------------------

Required article

	Hand shower FlowReduce - Platinum	28 012 979-08 0010
---	--	--------------------

Recommended article

	VAIA Wall elbow - Platinum	28 450 809-08
---	-----------------------------------	---------------

Required article

	SERIES-VARIOUS Hand shower FlowReduce - Platinum	28 025 979-08 0010
---	---	--------------------

26 413 809
Product version from 4/1/2025

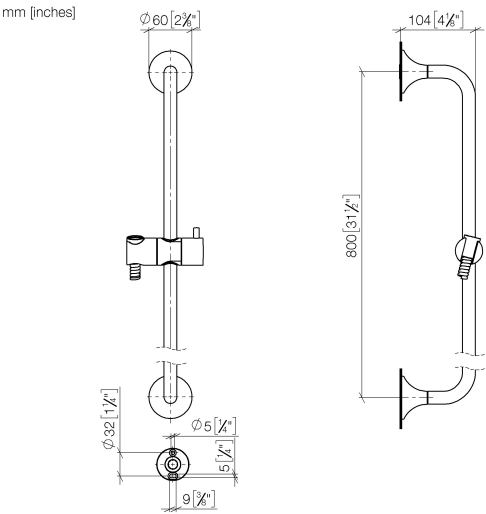

Codes & Standards

ASME A112.18.1	cUPC	Scottish Water Byelaws	UK Water Supply Regulations
XP P 41-280			

Certificates and sustainability

WRAS_2009	ACS_20 ACC LY	IAPMO_4976
-----------	---------------	------------

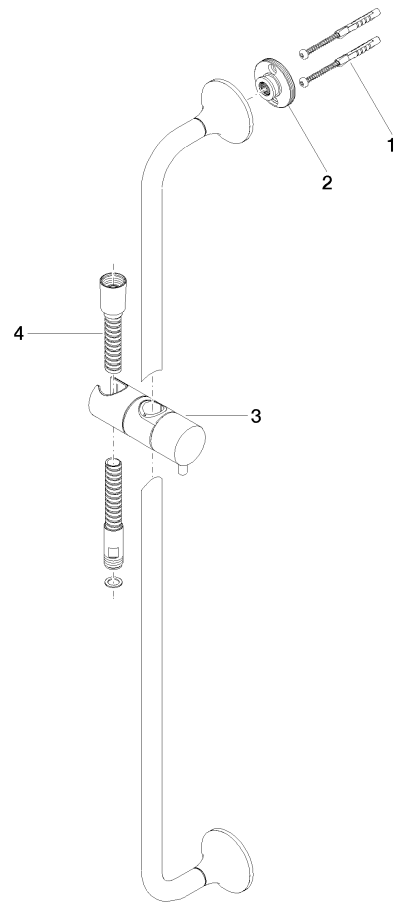

Spare parts list

Number	Item Number	Designation	Number of units	Lead time
4	28 322 970-08	Metal shower hose 1/2" x 3/8" x 68-7/8" - Platinum	1.00	40
3	12 580 970-08	Slider - Platinum	1.00	40
2	90 17 20 759 00 90	disc	2.00	2
1	05 30 31 025 00 90	fixing set	2.00	2