











MEM Three-hole single-lever tub mixer for deck-mounted tub installation -  
Brushed Durabrass (23kt Gold)

MEM

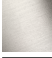
27 412 782



- 8-5/8" Projection
  - Spout: Rectangular aerator
  - Water flow rate limited to max. 5.4 gpm
  - Hand-held shower: COMPACT RAIN, flow rate max. 1.8 gpm (at 3 bar)
  - Hand shower set with anti-scale technology
  - Integrated diverter
  - Total height 11-3/4"
  - Height to aerator/spout outlet 6-3/4"
  - Spout hole diameter 1-1/4"
  - Single-lever mixer hole diameter 1-3/8"
  - Hole diameter for hand shower set 1-1/4"
  - Flange for mixer 2-3/8" x 2-3/8"
  - 2-3/8" x 2-3/8" flange for spout
  - Hand shower set with flange 2-3/8" x 2-3/8"
  - Metal shower hose 88-5/8" with anti-twist device
- NOTE: Local building codes may require the use of an anti-scald device. Please refer to remote pressure balance valve (35 914 970 90)
- Internal backflow preventer.

	Brushed Durabrass (23kt Gold)	27 412 782-28
	Chrome	27 412 782-00
	Brushed Platinum	27 412 782-06
	Platinum	27 412 782-08
	Dark Chrome	27 412 782-19
	Brushed Champagne (22kt Gold)	27 412 782-46
	Champagne (22kt Gold)	27 412 782-47
	Brushed Dark Platinum	27 412 782-99

MEM Three-hole single-lever tub mixer for deck-mounted tub installation -  
Brushed Durabrass (23kt Gold)

MEM

27 412 782  
mm [inches]

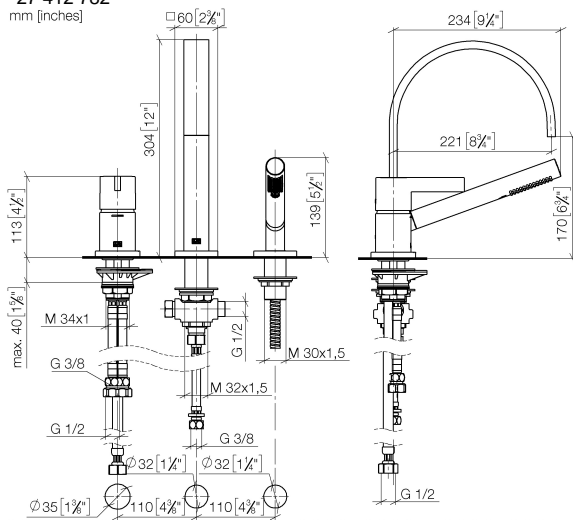

### Flow rate chart



## Codes & Standards

California Energy  
Commission  
(CEC)

## Ü-Zeichen

DIN 4109

EN 1717

ISO 3822



## MEM Three-hole single-lever tub mixer for deck-mounted tub installation - Brushed Durabrass (23kt Gold)

---

MEM

27 412 782

Certificates and sustainability

---

LGA\_29

Belgaqua\_24-008-2

## MEM Three-hole single-lever tub mixer for deck-mounted tub installation - Brushed Durabron (23kt Gold)

MEM

27 412 782

Parts for other  
finishes can be found  
here: Chrome

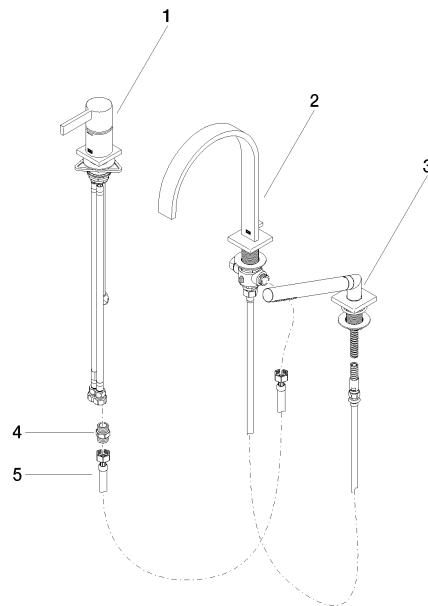

### Spare parts list

Number	Item Number	Designation	Number of units	Lead time
5	12 502 970 90	Flexible supply line 1/2" x 1/2" x 15-3/4" -	1.00	2
3	27 702 980-28	Hand shower set for deck-mounted tub installation - Brushed Durabron (23kt Gold)	1.00	20
1	29 300 670-28	Single-lever tub mixer for deck-mounted tub installation - Brushed Durabron (23kt Gold)	1.00	20
4	90 24 03 168 00 90	nipple	1.00	2
2	90 28 22 268 00-28	90282226800-28	1.00	-

Spare part can no longer be ordered, please order the replacement item