









LISSÉ Three-hole single-lever tub mixer for deck-mounted tub installation - Dark Chrome

27 412 845 Product version from 4/1/2024



- Spout: Round aerated stream
  - Water flow rate limited to max. 4.5 gpm
  - Hand-held shower: COMPACT RAIN, flow rate max. 1.8 gpm (at 3 bar)
  - Hand shower set with anti-scale technology
  - 7-7/8" Projection
  - Integrated diverter
  - Total height 5-1/2"
  - Height to aerator/spout outlet 3-1/2"
  - Spout hole diameter 1-1/4"
  - Hole diameter single-lever mixer 1-3/8"
  - Hole diameter for hand shower set 1-1/4"
  - Hand shower set with flange Ø 2"
  - Metal shower hose 68-7/8" with anti-twist device
- NOTE: Local building codes may require the use of an anti-scald device. Please refer to remote pressure balance valve (35 914 970 90)
- Internal backflow preventer.

|   |                       |               |
|---|-----------------------|---------------|
|  | Dark Chrome           | 27 412 845-19 |
|  | Chrome                | 27 412 845-00 |
|  | Brushed Platinum      | 27 412 845-06 |
|  | Brushed Light Gold    | 27 412 845-27 |
|  | Matte Black           | 27 412 845-33 |
|  | Brushed Chrome        | 27 412 845-93 |
|  | Brushed Dark Platinum | 27 412 845-99 |



LISSÉ Three-hole single-lever tub mixer for deck-mounted tub installation - Dark Chrome

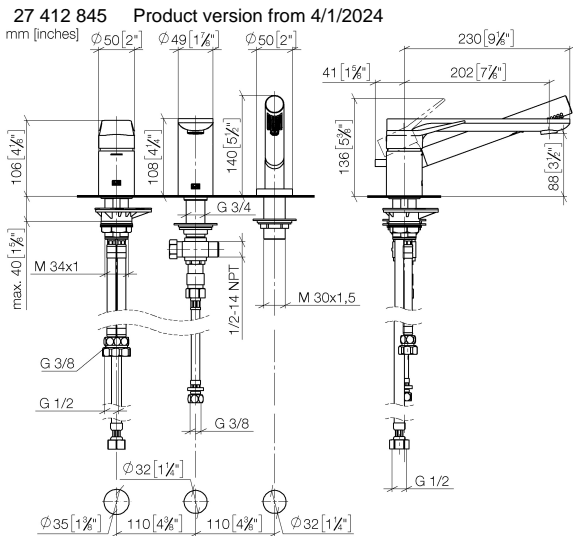

Flow rate chart

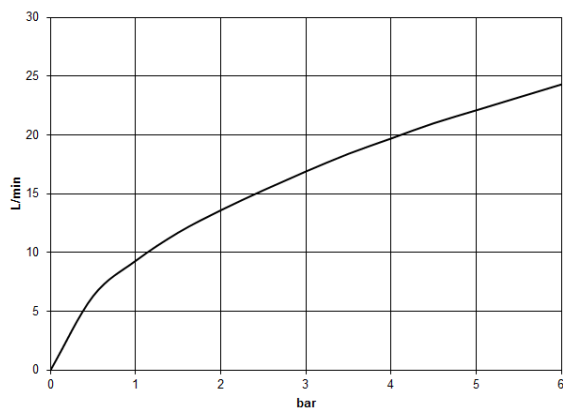

Codes & Standards

|                |                           |                                    |      |
|----------------|---------------------------|------------------------------------|------|
| ASME A112.18.1 | ASME A112.18.1/CSA B125.1 | California Energy Commission (CEC) | cUPC |
| EN 1717        |                           |                                    |      |



## LISSE Three-hole single-lever tub mixer for deck-mounted tub installation - Dark Chrome

---

27 412 845 Product version from 4/1/2024

### Certificates

---

IAPMO\_4976

Belgaqua\_24-008-2

LISSÉ Three-hole single-lever tub mixer for deck-mounted tub installation - Dark Chrome

27 412 845    Product version from 4/1/2024

Parts for other finishes can be found here: [Chrome](#)

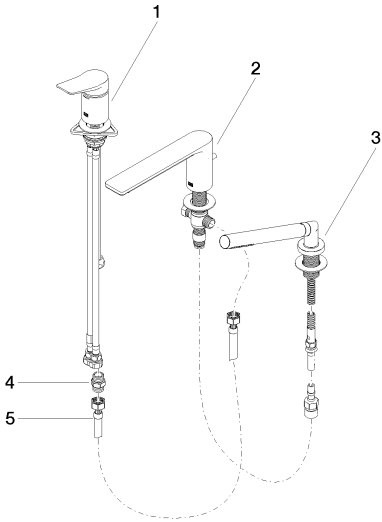

Spare parts list

| Number   | Item Number        | Designation   | Number of units | Lead time |
|--|--------------------|---|-----------------|-----------|
| 1  | 29 300 845-19      | connection  | 1               | -         |
| Spare part can no longer be ordered, please order the replacement item |                    |   |                 |           |
| 2  | 13 512 845-19      | spout   | 1               | -         |
| Spare part can no longer be ordered, please order the replacement item |                    |   |                 |           |
| 3  | 27 702 979-19      | Hand shower set for deck-mounted tub installation - Dark Chrome | 1               | 20        |
| 4  | 90 24 03 168 00 90 | nipple  | 1               | 2         |
| 5  | 12 502 970 90      | Flexible supply line 1/2" x 1/2" x 15-3/4" -                    | 1               | 2         |