









LISSE Three-hole single-lever tub mixer for deck-mounted tub installation -  
Matte Black

LISSE

27 412 845    Product version from 4/1/2024

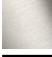

- Spout: Round aerated stream
  - Water flow rate limited to max. 4.5 gpm
  - Hand-held shower: COMPACT RAIN, flow rate max. 1.8 gpm (at 3 bar)
  - Hand shower set with anti-scale technology
  - 7-7/8" Projection
  - Integrated diverter
  - Total height 5-1/2"
  - Height to aerator/spout outlet 3-1/2"
  - Spout hole diameter 1-1/4"
  - Hole diameter single-lever mixer 1-3/8"
  - Hole diameter for hand shower set 1-1/4"
  - Hand shower set with flange Ø 2"
  - Metal shower hose 68-7/8" with anti-twist device
- NOTE: Local building codes may require the use of an anti-scald device. Please refer to remote pressure balance valve (35 914 970 90)
- Internal backflow preventer.

	Matte Black	27 412 845-33
	Chrome	27 412 845-00
	Brushed Platinum	27 412 845-06
	Dark Chrome	27 412 845-19
	Brushed Light Gold	27 412 845-27
	Brushed Chrome	27 412 845-93
	Brushed Dark Platinum	27 412 845-99



LISSE Three-hole single-lever tub mixer for deck-mounted tub installation -  
Matte Black

LISSE

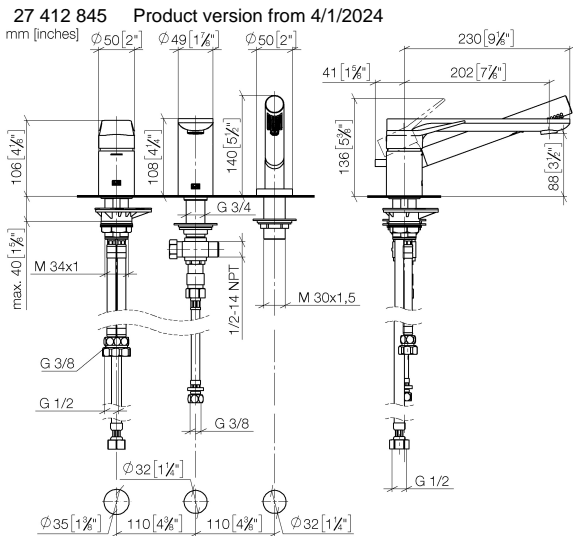

Flow rate chart

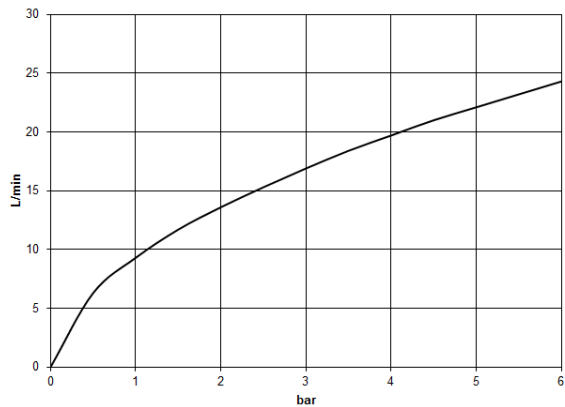

Codes & Standards

ASME A112.18.1	California Energy Commission (CEC)	cUPC	EN 1717
----------------	------------------------------------	------	---------



## LISSE Three-hole single-lever tub mixer for deck-mounted tub installation - Matte Black

---

LISSE

27 412 845 Product version from 4/1/2024

Certificates and sustainability

---

Belgaqua\_24-008-2 IAPMO\_4976 (

## LISSÉ Three-hole single-lever tub mixer for deck-mounted tub installation - Matte Black

LISSÉ

27 412 845 Product version from 4/1/2024

Parts for other  
finishes can be found  
here: [Chrome](#)

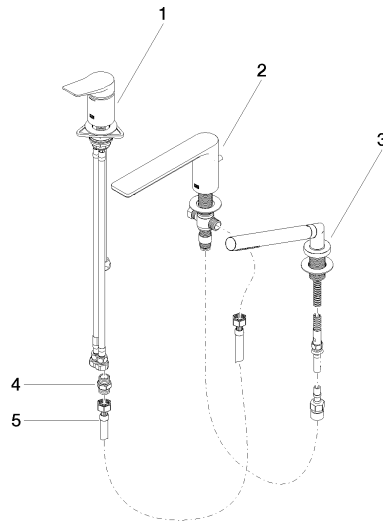

### Spare parts list

Number	Item Number	Designation	Number of units	Lead time
3	27 702 979-33	Hand shower set for deck-mounted tub installation - Matte Black	1.00	10
1	29 300 845-33	connection	1.00	-
Spare part can no longer be ordered, please order the replacement item				
5	12 502 970 90	Flexible supply line 1/2" x 1/2" x 15-3/4" -	1.00	2
2	13 512 845-33	spout	1.00	-
Spare part can no longer be ordered, please order the replacement item				
4	90 24 03 168 00 90	nipple	1.00	2