







LISSE Three-hole single-lever tub mixer for deck-mounted tub installation -
Brushed Dark Platinum

LISSE

27 412 845 Product version from 4/1/2024

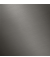
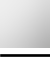

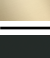
- Spout: Round aerated stream
 - Water flow rate limited to max. 4.5 gpm
 - Hand-held shower: COMPACT RAIN, flow rate max. 1.8 gpm (at 3 bar)
 - Hand shower set with anti-scale technology
 - 7-7/8" Projection
 - Integrated diverter
 - Total height 5-1/2"
 - Height to aerator/spout outlet 3-1/2"
 - Spout hole diameter 1-1/4"
 - Hole diameter single-lever mixer 1-3/8"
 - Hole diameter for hand shower set 1-1/4"
 - Hand shower set with flange Ø 2"
 - Metal shower hose 68-7/8" with anti-twist device
- NOTE: Local building codes may require the use of an anti-scald device. Please refer to remote pressure balance valve (35 914 970 90)
- Internal backflow preventer.

	Brushed Dark Platinum	27 412 845-99
	Chrome	27 412 845-00
	Brushed Platinum	27 412 845-06
	Dark Chrome	27 412 845-19
	Brushed Light Gold	27 412 845-27
	Matte Black	27 412 845-33
	Brushed Chrome	27 412 845-93

LISSÉ Three-hole single-lever tub mixer for deck-mounted tub installation -
Brushed Dark Platinum

LISSÉ

27 412 845 Product version from 4/1/2024

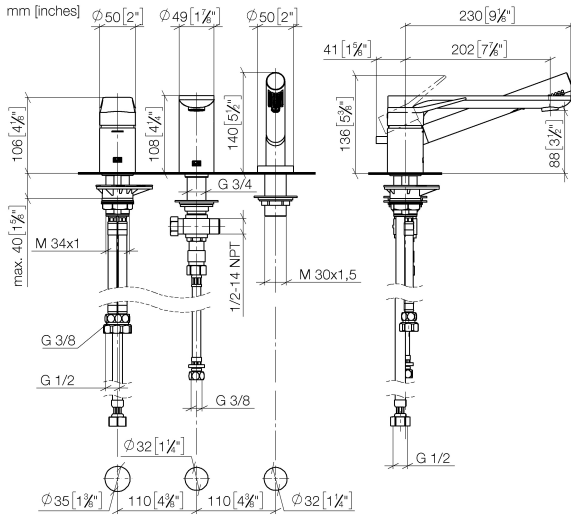

Flow rate chart



Codes & Standards

ASME A112.18.1

California Energy
Commission
(CEC)

cUPC

EN 1717



LISSE Three-hole single-lever tub mixer for deck-mounted tub installation - Brushed Dark Platinum

LISSE

27 412 845 Product version from 4/1/2024

Certificates and sustainability

Belgaqua_24-008-2 IAPMO_4976 (

LISSÉ Three-hole single-lever tub mixer for deck-mounted tub installation - Brushed Dark Platinum

LISSÉ

27 412 845 Product version from 4/1/2024

Parts for other
finishes can be found
here: [Chrome](#)

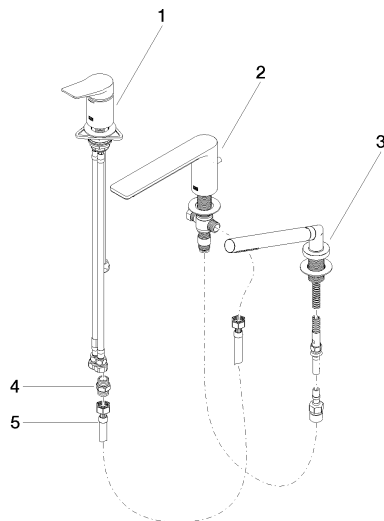

Spare parts list

Number	Item Number	Designation	Number of units	Lead time
3	27 702 979-99	Hand shower set for deck-mounted tub installation - Brushed Dark Platinum	1.00	20
5	12 502 970 90	Flexible supply line 1/2" x 1/2" x 15-3/4" -	1.00	2
1	29 300 845-99	connection	1.00	-
Spare part can no longer be ordered, please order the replacement item				
2	13 512 845-99	spout	1.00	-
Spare part can no longer be ordered, please order the replacement item				
4	90 24 03 168 00 90	nipple	1.00	2