

## VAIA Five hole tub set for deck-mounted tub installation with diverter - Chrome

27 522 819 Product version from 3/13/2017



- Spout: Round aerated stream
- Water flow rate limited to max. 5.7 gpm
- Hand-held shower: COMPACT RAIN, flow rate max. 1.8 gpm (at 3 bar)
- Hand shower set with anti-scale technology
- Integrated diverter
- 8-5/8" Projection
- Total height 13-5/8"
- Height to aerator/spout outlet 9-5/8"
- Spout hole diameter 1-1/4"
- Valve hole diameter 1-1/4"
- Hole diameter for hand shower set 1-1/4"
- 2-1/8" diameter flange for spout
- Hand shower set with flange Ø 2-3/8"
- Valve with flange Ø 2-3/8"
- Metal shower hose 68-7/8" with anti-twist device

Internal backflow preventer.

NOTE: Local building codes may require the use of an anti-scald device. Please refer to remote pressure balance valve (35 914 970 90)

|   |                               |               |
|---|-------------------------------|---------------|
|  | Chrome                        | 27 522 819-00 |
|  | Brushed Platinum              | 27 522 819-06 |
|  | Platinum                      | 27 522 819-08 |
|  | Dark Chrome                   | 27 522 819-19 |
|  | Brushed Durabrass (23kt Gold) | 27 522 819-28 |
|  | Brushed Bronze                | 27 522 819-42 |
|  | Brushed Champagne (22kt Gold) | 27 522 819-46 |
|  | Champagne (22kt Gold)         | 27 522 819-47 |
|  | Brushed Dark Platinum         | 27 522 819-99 |

VAIA Five hole tub set for deck-mounted tub installation with diverter - Chrome

27 522 819 Product version from 3/13/2017

mm [inches]  
M 1:10

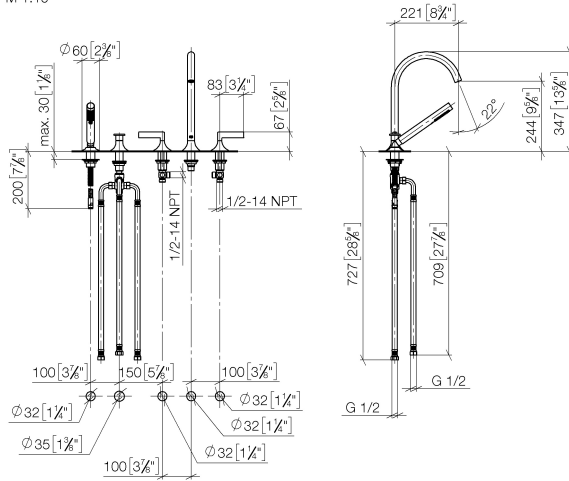

### Flow rate chart



## Codes & Standards

|                |                                 |  |          |
|----------------|---------------------------------|--|----------|
| ASME A112.18.1 | ASME<br>A112.18.1/CSA<br>B125.1 | California Energy<br>Commission<br>(CEC) | cUPC     |
| DIN 4109       | EN 1717                         | Executive Order<br>no. 1007              | ISO 3822 |

## Ü-Zeichen



## VAIA Five hole tub set for deck-mounted tub installation with diverter - Chrome

---

27 522 819 Product version from 3/13/2017

### Certificates

---

IAPMO\_4976

Belgaqua\_22\_278\_2 WRAS\_2310

LGA\_29

## VAIA Five hole tub set for deck-mounted tub installation with diverter - Chrome

27 522 819 Product version from 3/13/2017

Parts for other  
finishes can be found  
here: Brushed  
Platinum

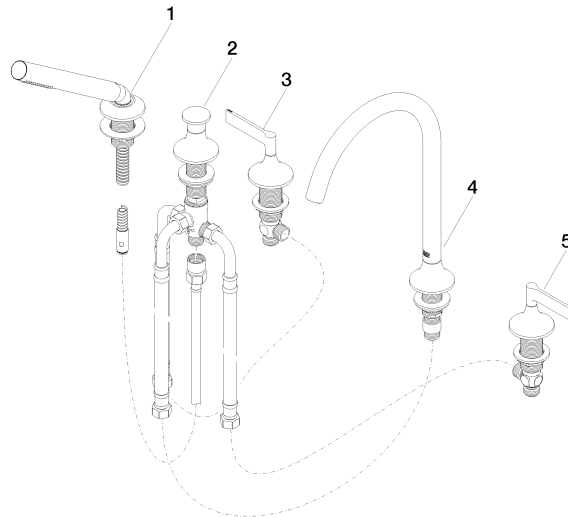

### Spare parts list

| Number   | Item Number   | Designation  | Number of units | Lead time |
|--|---------------|--|-----------------|-----------|
| 1  | 27 702 809-00 | VAIA Hand shower set for deck-mounted tub installation - Chrome        | 1               | 10        |
| 2  | 29 140 809-00 | VAIA Two-way diverter for deck-mounted tub installation - Chrome       | 1               | 10        |
| 3  | 20 000 818-00 | VAIA Deck valve clockwise-closing hot - Chrome                         | 1               | -         |
| Spare part can no longer be ordered, please order the replacement item |               |  |                 |           |
| 4  | 13 612 809-00 | VAIA Tub spout without diverter for deck-mounted installation - Chrome | 1               | -         |
| Spare part can no longer be ordered, please order the replacement item |               |  |                 |           |
| 5  | 20 000 819-00 | VAIA Deck valve counter-clockwise closing cold - Chrome                | 1               | -         |
| Spare part can no longer be ordered, please order the replacement item |               |  |                 |           |