

VAIA Five hole tub set for deck-mounted tub installation with diverter - Brushed Champagne (22kt Gold)

VAIA



27 522 819 Product version from 3/13/2017



- Spout: Round aerated stream
- Water flow rate limited to max. 5.7 gpm
- Hand-held shower: COMPACT RAIN, flow rate max. 1.8 gpm (at 3 bar)
- Hand shower set with anti-scale technology
- Integrated diverter
- 8-5/8" Projection
- Total height 13-5/8"
- Height to aerator/spout outlet 9-5/8"
- Spout hole diameter 1-1/4"
- Valve hole diameter 1-1/4"
- Hole diameter for hand shower set 1-1/4"
- 2-1/8" diameter flange for spout
- Hand shower set with flange Ø 2-3/8"
- Valve with flange Ø 2-3/8"
- Metal shower hose 68-7/8" with anti-twist device

Internal backflow preventer.

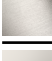
NOTE: Local building codes may require the use of an anti-scald device. Please refer to remote pressure balance valve (35 914 970 90)

	Brushed Champagne (22kt Gold)	27 522 819-46
	Chrome	27 522 819-00
	Brushed Platinum	27 522 819-06
	Platinum	27 522 819-08
	Dark Chrome	27 522 819-19
	Brushed Durabronze (23kt Gold)	27 522 819-28
	Brushed Dark Brass	27 522 819-39
	Brushed Bronze	27 522 819-42
	Champagne (22kt Gold)	27 522 819-47
	Brushed Dark Platinum	27 522 819-99

VAIA Five hole tub set for deck-mounted tub installation with diverter - Brushed Champagne (22kt Gold)

VAIA

27 522 819 Product version from 3/13/2017
mm [inches]
M 1:10



Flow rate chart



Codes & Standards

ASME A112.18.1	California Energy Commission (CEC)	cUPC	DIN 4109
EN 1717	Executive Order no. 1007	ISO 3822	Ü-Zeichen



VAIA Five hole tub set for deck-mounted tub installation with diverter - Brushed
Champagne (22kt Gold)

VAIA

27 522 819 Product version from 3/13/2017

Certificates and sustainability

IAPMO_4976 Belgaqua_22_278_2 WRAS_2310 LGA_29

VAIA Five hole tub set for deck-mounted tub installation with diverter - Brushed Champagne (22kt Gold)

VAIA

27 522 819 Product version from 3/13/2017

Parts for other
finishes can be found
here: [Chrome](#)

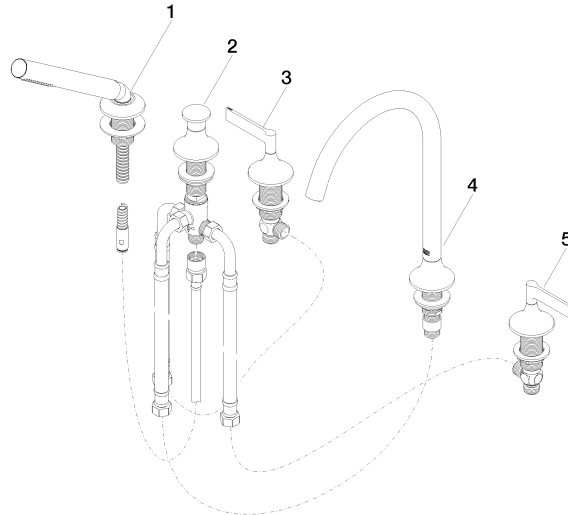

Spare parts list

Number	Item Number	Designation	Number of units	Lead time
1	27 702 809-46	VAIA Hand shower set for deck-mounted tub installation - Brushed Champagne (22kt Gold)	1.00	30
2	29 140 809-46	VAIA Two-way diverter for deck-mounted tub installation - Brushed Champagne (22kt Gold)	1.00	30
3	20 000 818-46	handle (hot)	1.00	-
Spare part can no longer be ordered, please order the replacement item				
5	20 000 819-46	handle (hot)	1.00	-
Spare part can no longer be ordered, please order the replacement item				
4	13 612 809-46	spout	1.00	-
Spare part can no longer be ordered, please order the replacement item				