

## META Deck-mounted tub mixer, with hand shower set for deck-mounted tub installation - Brushed Platinum

META

27 632 661 Product version from 7/1/2023



- Spout: Round aerated stream
- Water flow rate limited to max. 6.2 gpm
- Hand-held shower: COMPACT RAIN, flow rate max. 1.8 gpm (at 3 bar)
- Hand shower set with anti-scale technology
- Integrated diverter
- 8-3/4" Projection
- Total height 12-1/2"
- Height to aerator/spout outlet 8-1/2"
- Spout hole diameter 1-3/8"
- Hole diameter single-lever mixer 1-3/8"
- Hole diameter for hand shower set 1-1/4"
- 2-1/8" diameter flange for spout
- Mixer with flange Ø 2-1/8"
- Hand shower set with flange Ø 2-3/8"
- Metal shower hose 68-7/8" with anti-twist device

Internal backflow preventer.

NOTE: Local building codes may require the use of an anti-scald device. Please refer to remote pressure balance valve (35 914 970 90)

|   |                               |               |
|---|-------------------------------|---------------|
|    | Brushed Platinum              | 27 632 661-06 |
|    | Chrome                        | 27 632 661-00 |
|    | Dark Chrome                   | 27 632 661-19 |
|    | Light gold                    | 27 632 661-26 |
|    | Brushed Light Gold            | 27 632 661-27 |
|    | Matte Black                   | 27 632 661-33 |
|    | Brushed Bronze                | 27 632 661-42 |
|    | Brushed Champagne (22kt Gold) | 27 632 661-46 |
|    | Champagne (22kt Gold)         | 27 632 661-47 |
|   | Brushed Chrome                | 27 632 661-93 |
|  | Brushed Dark Platinum         | 27 632 661-99 |

# META Deck-mounted tub mixer, with hand shower set for deck-mounted tub installation - Brushed Platinum

META

27 632 661 Product version from 7/1/2023  
mm [inches]

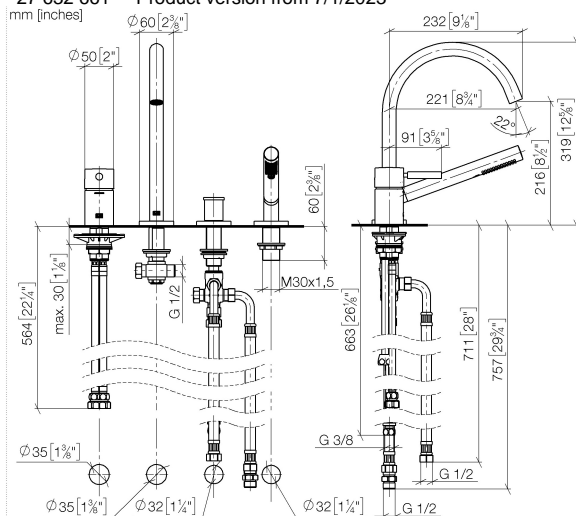

Flow rate chart



## Codes & Standards

|                |                                    |                        |                             |
|----------------|------------------------------------|------------------------|-----------------------------|
| ASME A112.18.1 | California Energy Commission (CEC) | cUPC                   | DIN 4109                    |
| EN 1717        | ISO 3822                           | Scottish Water Byelaws | UK Water Supply Regulations |

Ü-Zeichen



META Deck-mounted tub mixer, with hand shower set for deck-mounted tub installation - Brushed Platinum

META

27 632 661 Product version from 7/1/2023

Certificates and sustainability

|        |           |            |                   |
|--------|-----------|------------|-------------------|
| LGA_38 | WRAS_2207 | IAPMO_4976 | Belgaqua_21-026-2 |
|--------|-----------|------------|-------------------|

## META Deck-mounted tub mixer, with hand shower set for deck-mounted tub installation - Brushed Platinum

META

27 632 661 Product version from 7/1/2023

Parts for other  
finishes can be found  
here: [Chrome](#)

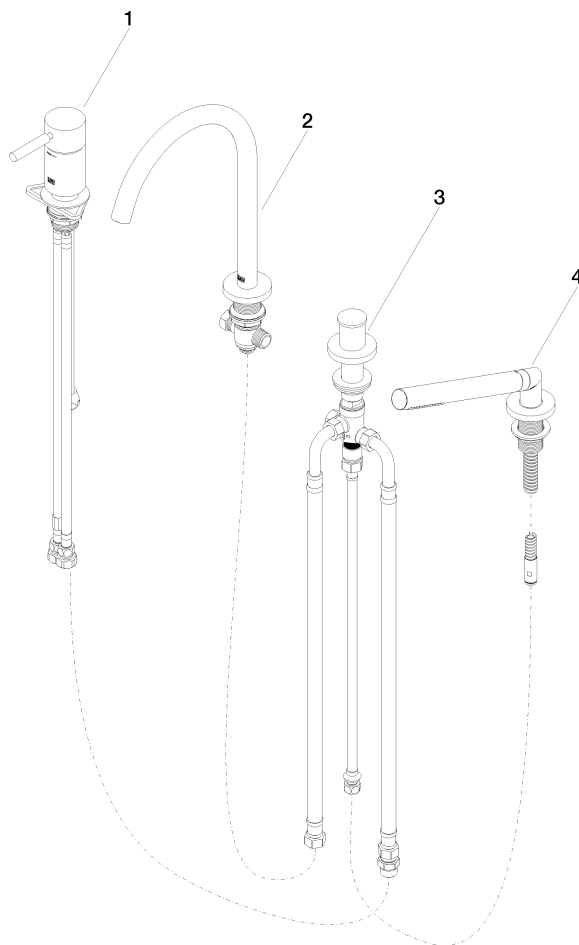

### Spare parts list

| Number | Item Number   | Designation  | Number of units | Lead time |
|--------|---------------|--|-----------------|-----------|
| 2      | 13 512 661-06 | spout  | 1.00            | 60        |
| 4      | 27 702 660-06 | META Hand shower set for deck-mounted tub installation - Brushed Platinum        | 1.00            | 10        |
| 3      | 29 140 660-06 | META Two-way diverter for deck-mounted tub installation - Brushed Platinum       | 1.00            | 10        |
| 1      | 29 300 660-06 | META Single-lever tub mixer for deck-mounted tub installation - Brushed Platinum | 1.00            | 10        |