



META Deck-mounted tub mixer, with hand shower set for deck-mounted tub installation - Matte Black

27 632 661 Product version from 7/1/2023



- Spout: Round aerated stream
- Water flow rate limited to max. 6.2 gpm
- Hand-held shower: COMPACT RAIN, flow rate max. 1.8 gpm (at 3 bar)
- Hand shower set with anti-scale technology
- Integrated diverter
- 8-3/4" Projection
- Total height 12-1/2"
- Height to aerator/spout outlet 8-1/2"
- Spout hole diameter 1-3/8"
- Hole diameter single-lever mixer 1-3/8"
- Hole diameter for hand shower set 1-1/4"
- 2-1/8" diameter flange for spout
- Mixer with flange Ø 2-1/8"
- Hand shower set with flange Ø 2-3/8"
- Metal shower hose 68-7/8" with anti-twist device

Internal backflow preventer.

NOTE: Local building codes may require the use of an anti-scald device. Please refer to remote pressure balance valve (35 914 970 90)

	Matte Black	27 632 661-33
	Chrome	27 632 661-00
	Brushed Platinum	27 632 661-06
	Dark Chrome	27 632 661-19
	Light gold	27 632 661-26
	Brushed Light Gold	27 632 661-27
	Brushed Bronze	27 632 661-42
	Brushed Champagne (22kt Gold)	27 632 661-46
	Champagne (22kt Gold)	27 632 661-47
	Brushed Chrome	27 632 661-93
	Brushed Dark Platinum	27 632 661-99

META Deck-mounted tub mixer, with hand shower set for deck-mounted tub installation - Matte Black

27 632 661 Product version from 7/1/2023
mm [inches]

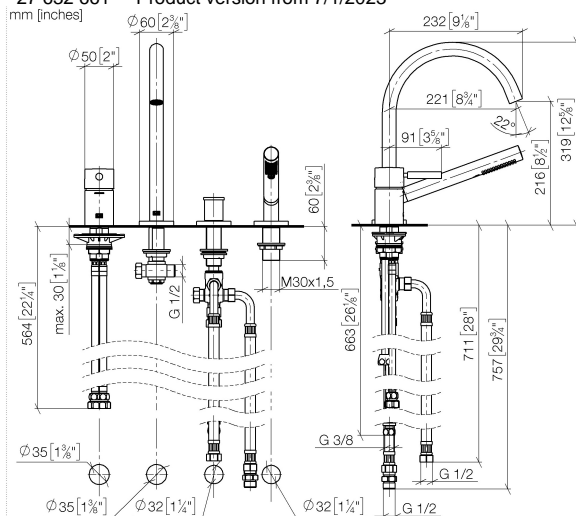

Flow rate chart

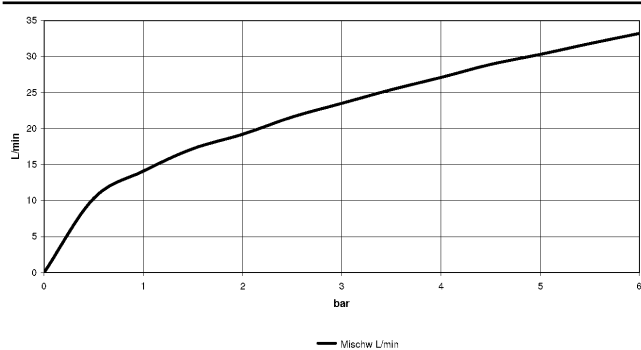

Codes & Standards

ASME
A112.18.1/CSA
B125.1

ISO 3822

California Energy
Commission
(CEC)

Scottish Water
Byelaws

DIN 4109

UK Water Supply
Regulations

EN 1717

Ü-Zeichen



META Deck-mounted tub mixer, with hand shower set for deck-mounted tub installation - Matte Black

27 632 661 Product version from 7/1/2023

Certificates

LGA_38	WRAS_2207	Belgaqua_21-026-2
--------	-----------	-------------------

META Deck-mounted tub mixer, with hand shower set for deck-mounted tub installation - Matte Black

27 632 661

Product version from 7/1/2023

Parts for other finishes can be found here: [Chrome](#)

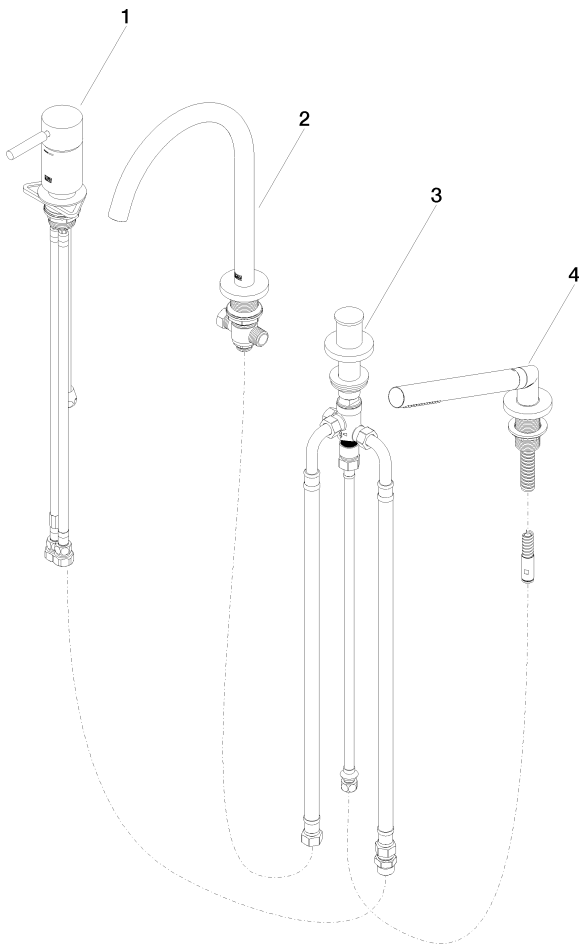

Spare parts list

Number	Item Number	Designation	Number of units	Lead time
1	29 300 660-33	META Single-lever tub mixer for deck-mounted tub installation - Matte Black	1	30
2	13 512 661-33	spout	1	60
3	29 140 660-33	META Two-way diverter for deck-mounted tub installation - Matte Black	1	30
4	27 702 660-33	META Hand shower set for deck-mounted tub installation - Matte Black	1	10