

VAIA Deck-mounted tub mixer, with hand shower set for deck-mounted tub installation - Brushed Bronze

VAIA

27 632 809 Product version from 4/1/2025



- Spout: Round aerated stream
- Water flow rate limited to max. 6.5 gpm
- Hand-held shower: COMPACT RAIN, flow rate max. 1.8 gpm (at 3 bar)
- Hand shower set with anti-scale technology
- Integrated diverter
- 8-5/8" Projection
- Total height 13-5/8"
- Height to aerator/spout outlet 9-5/8"
- Spout hole diameter 1-1/4"
- Hole diameter single-lever mixer 1-3/8"
- Hole diameter for hand shower set 1-1/4"
- 2-1/8" diameter flange for spout
- Mixer with flange Ø 2-1/8"
- Hand shower set with flange Ø 2-3/8"
- Metal shower hose 68-7/8" with anti-twist device

Internal backflow preventer.

NOTE: Local building codes may require the use of an anti-scald device. Please refer to remote pressure balance valve (35 914 970 90)

	Brushed Bronze	27 632 809-42
	Chrome	27 632 809-00
	Brushed Platinum	27 632 809-06
	Platinum	27 632 809-08
	Dark Chrome	27 632 809-19
	Brushed Durabronze (23kt Gold)	27 632 809-28
	Brushed Dark Brass	27 632 809-39
	Brushed Champagne (22kt Gold)	27 632 809-46
	Champagne (22kt Gold)	27 632 809-47
	Brushed Dark Platinum	27 632 809-99

VAIA Deck-mounted tub mixer, with hand shower set for deck-mounted tub installation - Brushed Bronze

VAIA

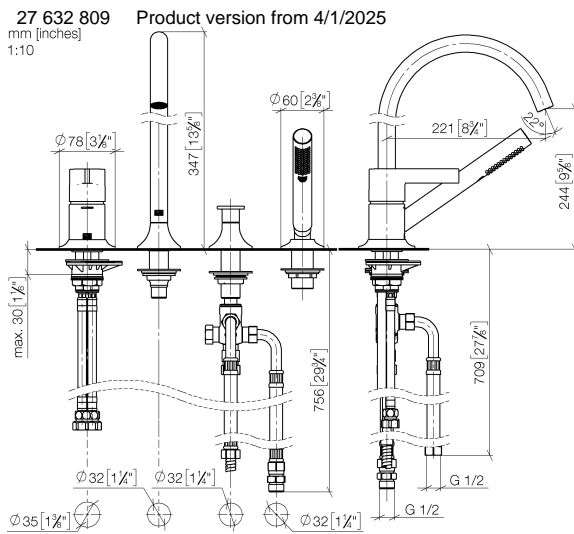

Flow rate chart

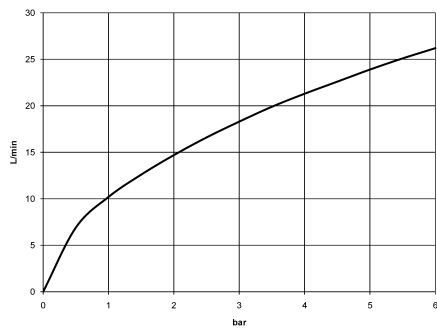

Codes & Standards

ASME A112.18.1	California Energy Commission (CEC)	cUPC	DIN 4109
ISO 3822	Ü-Zeichen		



VAIA Deck-mounted tub mixer, with hand shower set for deck-mounted tub installation - Brushed Bronze

VAIA

27 632 809 Product version from 4/1/2025

Certificates and sustainability

IAPMO_4976

LGA_29

VAIA Deck-mounted tub mixer, with hand shower set for deck-mounted tub installation - Brushed Bronze

VAIA

27 632 809 Product version from 4/1/2025

Parts for other
finishes can be found
here: [Chrome](#)

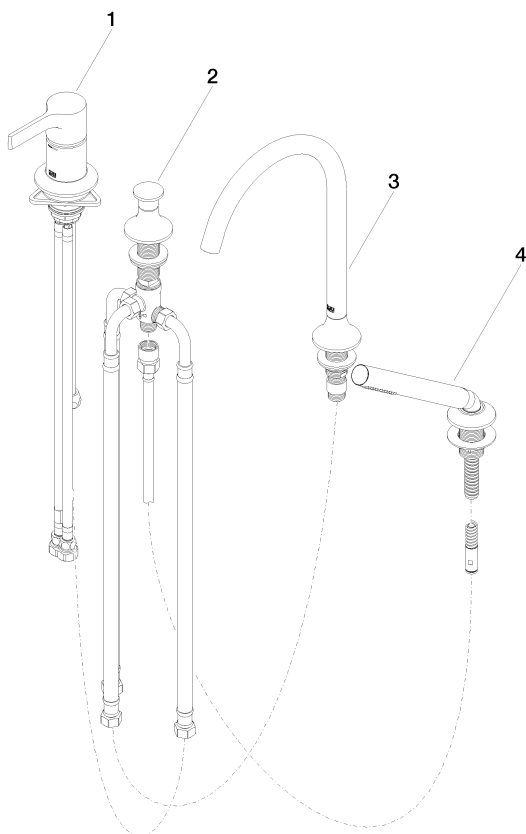

Spare parts list

Number	Item Number	Designation	Number of units	Lead time
3	13 612 809-42	spout	1.00	-
Spare part can no longer be ordered, please order the replacement item				
1	29 300 809-42	connection	1.00	30
4	27 702 809-42	VAIA Hand shower set for deck-mounted tub installation - Brushed Bronze	1.00	30
2	29 140 809-42	VAIA Two-way diverter for deck-mounted tub installation - Brushed Bronze	1.00	30