



LISSÉ Hand shower set with individual flanges FlowReduce - Brushed Platinum

LISSÉ

27 803 845 Product version from 4/1/2024



- 3-way or 5-way adjustable: COMPACT RAIN, COMPACT SOFT FLOW, COMPACT AQUAPRESSURE FLOW, flow rate max. 1.8 gpm (at 3 bar)
- Metal shower hose 49-1/4" with anti-twist device
- 3/8" Shower outlet
- Descaling system





Technical data:

- Flange for wall elbow 2-3/8" x 3-1/8"
- Wall bracket with flange 2-3/8" x 3-1/8"
- 1/2" wall elbow

Notes:

Internal backflow preventer.

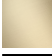
Internal backflow preventer.

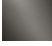
	Brushed Platinum	27 803 845-06 0010
	Chrome	27 803 845-00 0010
	Dark Chrome	27 803 845-19 0010
	Brushed Light Gold	27 803 845-27 0010
	Matte Black	27 803 845-33 0010
	Brushed Chrome	27 803 845-93 0010
	Brushed Dark Platinum	27 803 845-99 0010

Required article

Rough-in adapter -

35 080 970-90
0010



mm [inches]

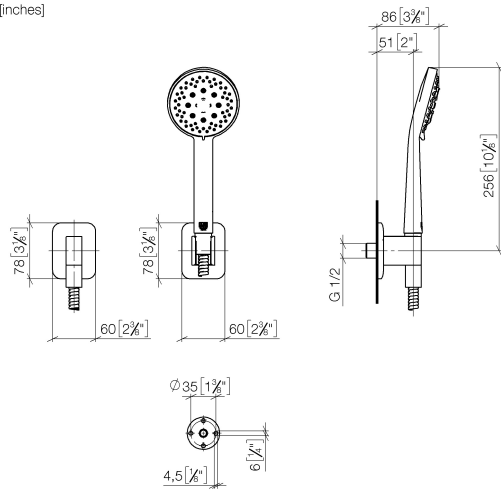

Codes & Standards

ASME A112.18.1	California Energy Commission (CEC)	cUPC	DIN 4109
ISO 3822	Ü-Zeichen		

Certificates and sustainability

LGA_29	IAPMO_4976
--------	------------

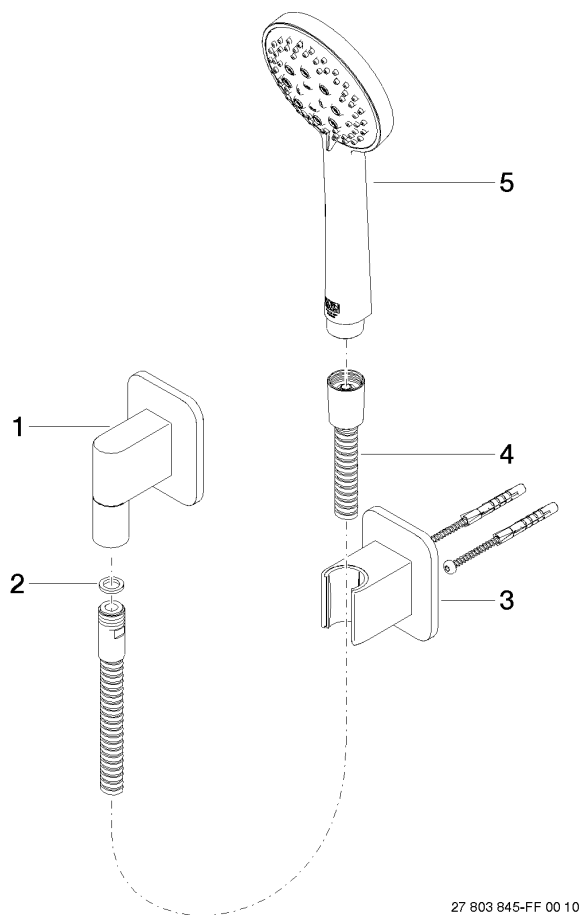

27 803 845-FF 00 10

Spare parts list

Number	Item Number	Designation	Number of units	Lead time
3	28 050 845-06	LISSÉ Wall bracket - Brushed Platinum	1.00	10
5	28 014 979-06 0010	Hand shower - Brushed Platinum	1.00	-
Spare part can no longer be ordered, please order the replacement item				
	28018979-060010	Hand shower FlowReduce - Brushed Platinum		
1	28 450 845-06	LISSÉ Wall elbow - Brushed Platinum	1.00	10
4	90 30 02 072 00-06	Metal shower hose 1/2" x 3/8" x 49-1/4" - Brushed Platinum	1.00	10
2	90 14 20 026 00 90	seal	1.00	2