



LISSÉ Hand shower set with individual flanges FlowReduce - Brushed Light Gold

LISSÉ

27 803 845 Product version from 4/1/2024



- 3-way or 5-way adjustable: COMPACT RAIN, COMPACT SOFT FLOW, COMPACT AQUAPRESSURE FLOW, flow rate max. 1.8 gpm (at 3 bar)
- Metal shower hose 49-1/4" with anti-twist device
- 3/8" Shower outlet
- Descaling system







Technical dimensions:

- Flange for wall elbow 2-3/8" x 3-1/8"
- Wall bracket with flange 2-3/8" x 3-1/8"
- 1/2" wall elbow

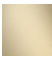
Notes:

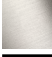
Internal backflow preventer.

Internal backflow preventer.

	Brushed Light Gold	27 803 845-27 0010
	Chrome	27 803 845-00 0010
	Brushed Platinum	27 803 845-06 0010
	Dark Chrome	27 803 845-19 0010
	Matte Black	27 803 845-33 0010
	Brushed Chrome	27 803 845-93 0010
	Brushed Dark Platinum	27 803 845-99 0010

Required article

Rough-in adapter -

35 080 970-90
0010



LISSÉ Hand shower set with individual flanges FlowReduce - Brushed Light Gold

LISSÉ

27 803 845 Product version from 4/1/2024
mm [inches]

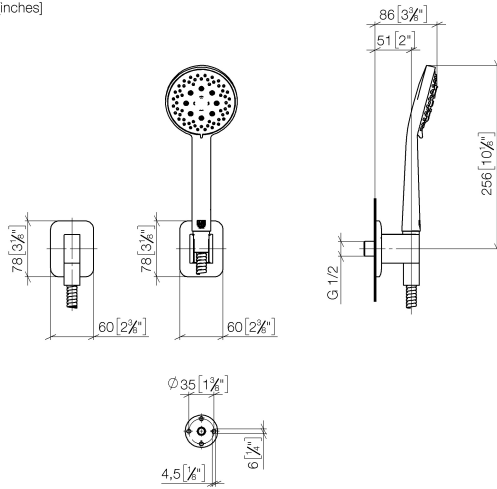

Codes & Standards

California Energy Commission (CEC)	DIN 4109	ISO 3822	Ü-Zeichen
------------------------------------	----------	----------	-----------

Certificates and sustainability

LGA_29

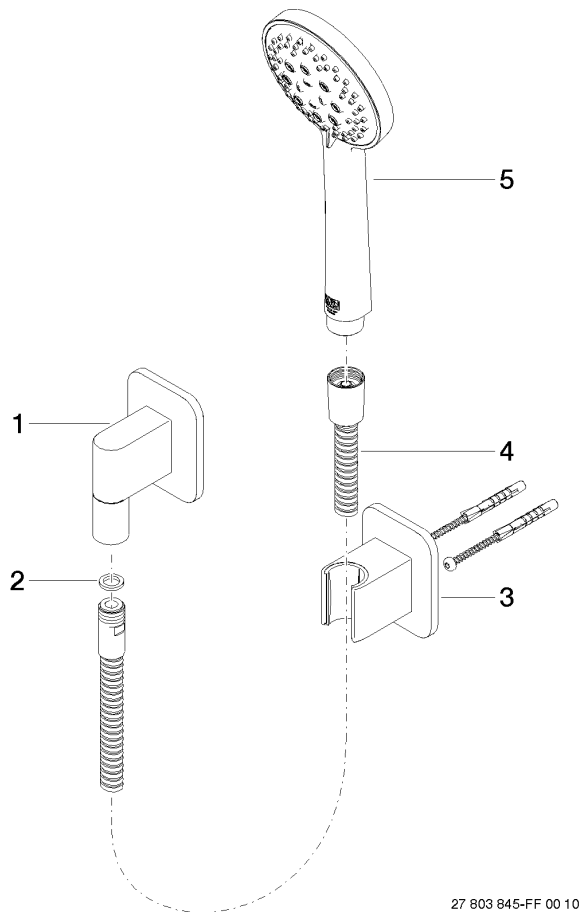

27 803 845-FF 00 10

Spare parts list

Number	Item Number	Designation	Number of units	Lead time
4	90 30 02 072 00-27	Metal shower hose 1/2" x 3/8" x 49-1/4" - Brushed Light Gold	1.00	30
3	28 050 845-27	LISSÉ Wall bracket - Brushed Light Gold	1.00	30
5	28 014 979-27 0010	shower	1.00	-
Spare part can no longer be ordered, please order the replacement item				
1	28 450 845-27	LISSÉ Wall elbow - Brushed Light Gold	1.00	30
2	90 14 20 026 00 90	seal	1.00	2