

## TARA Hand shower set with individual flanges FlowReduce - Chrome

TARA

27 803 892 Product version from 6/30/2015 to 7/11/2018



- 3-way or 5-way adjustable: COMPACT RAIN, COMPACT SOFT FLOW, COMPACT AQUAPRESSURE FLOW, flow rate max. 1.8 gpm (at 3 bar)
- Descaling system
- Metal shower hose 49-1/4" with anti-twist device
- 1/2" Shower outlet

### Technical data:

- Wall elbow with flange Ø 2-1/8"
- Wall bracket with flange Ø 2-1/8"
- 1/2" wall elbow

### Internal backflow preventer.

Internal backflow preventer.

|   |                               |                    |
|---|-------------------------------|--------------------|
|    | Chrome                        | 27 803 892-00 0010 |
|    | Brushed Platinum              | 27 803 892-06 0010 |
|    | Platinum                      | 27 803 892-08 0010 |
|    | Dark Chrome                   | 27 803 892-19 0010 |
|    | Brushed Durabrass (23kt Gold) | 27 803 892-28 0010 |
|    | Matte Black                   | 27 803 892-33 0010 |
|    | Brushed Dark Brass            | 27 803 892-39 0010 |
|    | Brushed Bronze                | 27 803 892-42 0010 |
|    | Brushed Champagne (22kt Gold) | 27 803 892-46 0010 |
|   | Champagne (22kt Gold)         | 27 803 892-47 0010 |
|  | Brushed Chrome                | 27 803 892-93 0010 |
|  | Brushed Dark Platinum         | 27 803 892-99 0010 |

### Required article

**Rough-in adapter -**

35 080 970-90  
0010



## TARA Hand shower set with individual flanges FlowReduce - Chrome

TARA

27 803 892 Product version from 6/30/2015 to 7/11/2018

mm [inches]

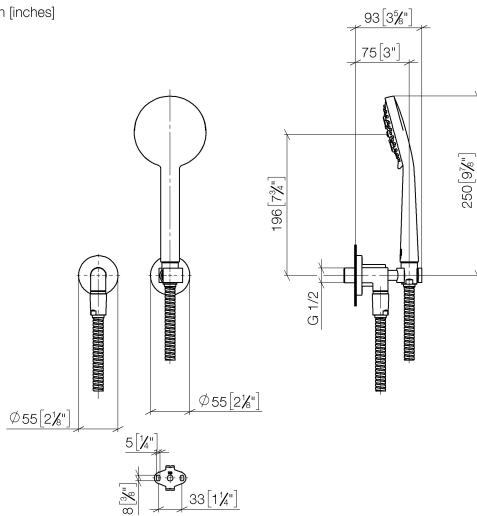

### Codes & Standards

|                |                                    |      |          |
|----------------|------------------------------------|------|----------|
| ASME A112.18.1 | California Energy Commission (CEC) | cUPC | DIN 4109 |
| ISO 3822       | Ü-Zeichen                          |      |          |

### Certificates and sustainability

LGA\_29 IAPMO\_4976

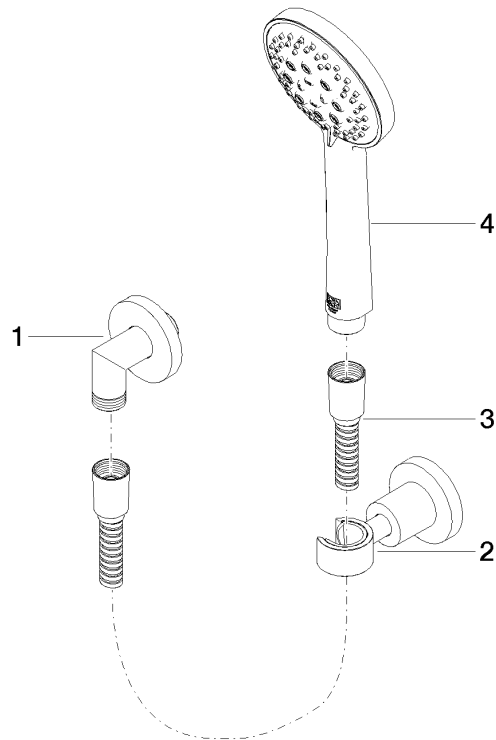

## Spare parts list

| Number   | Item Number        | Designation                                      | Number of units | Lead time |
|--|--------------------|--|-----------------|-----------|
| 2  | 28 050 892-00      | TARA Wall bracket - Chrome                       | 1.00            | 10        |
| 3  | 28 104 970-00      | Metal shower hose 1/2" x 1/2" x 49-1/4" - Chrome | 1.00            | 2         |
| 1  | 28 450 892-00      | connection                                       | 1.00            | 60        |
| 4  | 28 014 979-00 0010 | Hand shower - Chrome                             | 1.00            | -         |
| Spare part can no longer be ordered, please order the replacement item |                    |  |                 |           |
|  | 28018979-000010    | Hand shower FlowReduce - Chrome                  |                 |           |