

Rain shower flush mounted 11-3/4" x 9-1/2" - Platinum

28 043 980 Product version from 5/1/2022

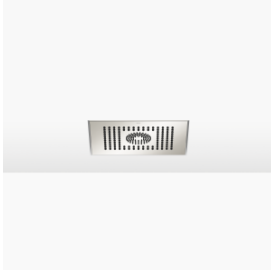

- 11-3/4" x 9-1/2" Rain showerhead
- PURE RAIN, flow rate max. 1.8 gpm (at 3 bar)
- PURIFY RAIN, flow rate max. 1.6 gpm (at 3 bar)
- Min. rough in depth 5-3/8"
- Descaling system
- This product can help a building meet the requirements of Green Building Rating Systems, e.g. LEED®, BREEAM®, DGNB
- Not suitable for use in a steam room.

To meet the North American plumbing standards, this application must be installed with a diverter (rough included).

To meet the North American plumbing standards, this application must be installed with a diverter (rough included).

| | | |
|---|--------------------------------|--------------------|
|  | Platinum | 28 043 980-08 0010 |
|  | Chrome | 28 043 980-00 0010 |
|  | Brushed Platinum | 28 043 980-06 0010 |
|  | Dark Chrome | 28 043 980-19 0010 |
|  | Brushed Light Gold | 28 043 980-27 0010 |
|  | Brushed Durabronze (23kt Gold) | 28 043 980-28 0010 |
|  | Matte Black | 28 043 980-33 0010 |
|  | Brushed Champagne (22kt Gold) | 28 043 980-46 0010 |
|  | Champagne (22kt Gold) | 28 043 980-47 0010 |
|  | Brushed Chrome | 28 043 980-93 0010 |
|  | Brushed Dark Platinum | 28 043 980-99 0010 |

Required article



- Installation rough flush mounted - 35 043 970-90 0010**
- Installation depth "
 - Pre-assembly kit for three-way diverter included



Rain shower flush mounted 11-3/4" x 9-1/2" - Platinum

28 043 980 Product version from 5/1/2022

mm [inches]

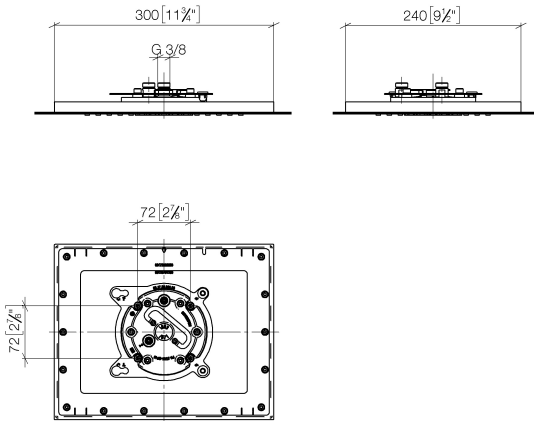

Flow rate chart

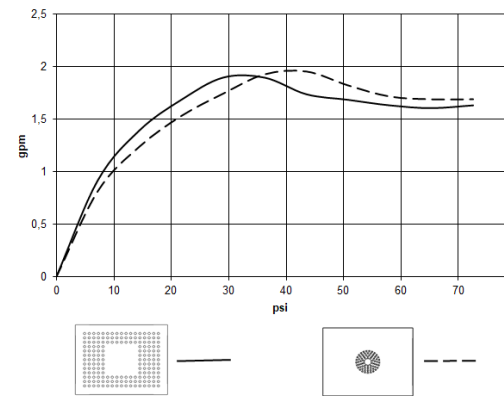

Codes & Standards

| | | | |
|----------------|------------------------------------|---|----------------|
| ASME A112.18.1 | California Energy Commission (CEC) | cUPC | EPA WaterSense |
| Water Sense | WaterSense |  | |



Rain shower flush mounted 11-3/4" x 9-1/2" - Platinum

28 043 980 Product version from 5/1/2022

Certificates

IAPMO_11777

IAPMO_4976

Rain shower flush mounted 11-3/4" x 9-1/2" - Platinum

28 043 980 Product version from 5/1/2022

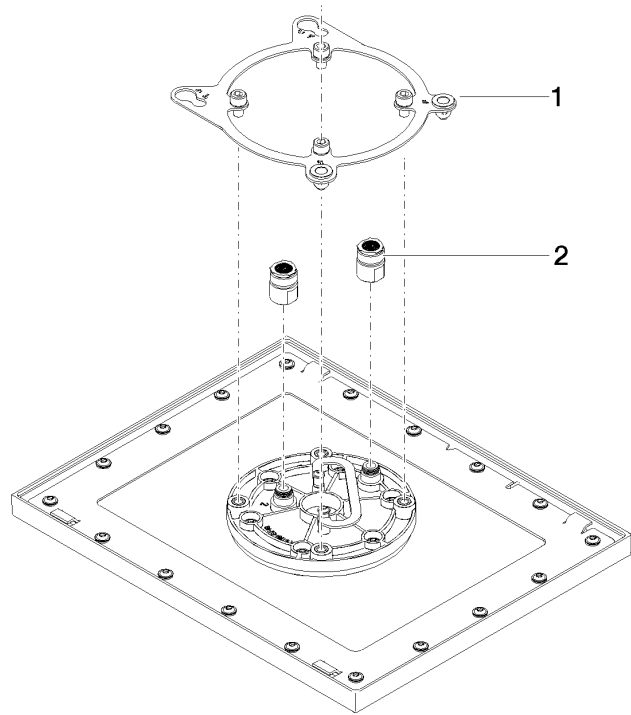

Spare parts list

| Number | Item Number | Designation | Number of units | Lead time |
|--------|--------------------|-------------|-----------------|-----------|
| 1 | 90 17 20 260 00 90 | flange | 1 | 2 |
| 2 | 90 24 03 309 02 90 | connection | 1 | 2 |