



28 050 626

- Flange diameter 2-1/8"



| | | |
|---|----------------|---------------|
|  | Brushed Chrome | 28 050 626-93 |
|  | Chrome | 28 050 626-00 |
|  | Matte Black | 28 050 626-33 |

28 050 626

mm [inches]

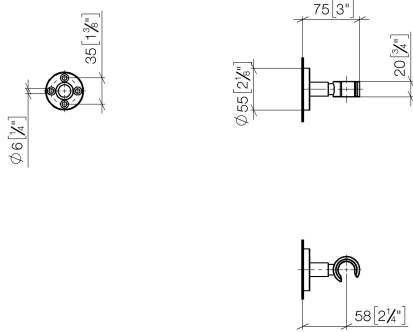

28 050 626

Parts for other
finishes can be found
here: [Chrome](#)

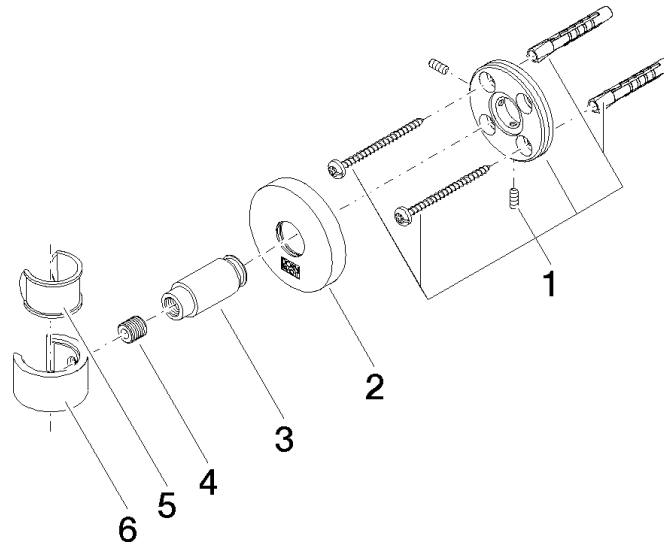

Spare parts list

| Number | Item Number | Designation | Number of units | Lead time |
|--|--------------------|-------------|-----------------|-----------|
| 1 | 05 17 62 500 00 90 | fixing set | 1.00 | 2 |
| 6 | 09 17 20 014-93 | holder | 1.00 | 20 |
| 3 | 08 17 62 550-93 | holder | 1.00 | 20 |
| 2 | 90 27 62 502 00-93 | rosette | 1.00 | - |
| Spare part can no longer be ordered, please order the replacement item | | | | |
| 4 | 08 18 50 585 90 | screw | 1.00 | 2 |
| 5 | 90 18 40 035 00 90 | sleeve | 1.00 | 2 |