



DORNBRAUCHT YAMOU Showerhead - Chrome

DORNBRAUCHT
YAMOU

28 504 831 Product version from 1/1/2023



- 7-1/8"-8-1/4" Projection
- Ball-joint pivotable through 30°
- Standard spray mode
- Descaling system
- Ø 3-7/8"
- Flange diameter 2-1/8"
- 1/2" connection
- Water flow rate limited to max. 2 gpm
- Flange diameter 2-1/8"

	Chrome	28 504 831-00 0010
	Soft Black	28 504 831-69 0010

Recommended article



Concealed wall elbow - 35 085 970-90
0010



DORNBRACHT YAMOU Showerhead - Chrome

DORNBRACHT
YAMOU

28 504 831 Product version from 1/1/2023

mm [inches]

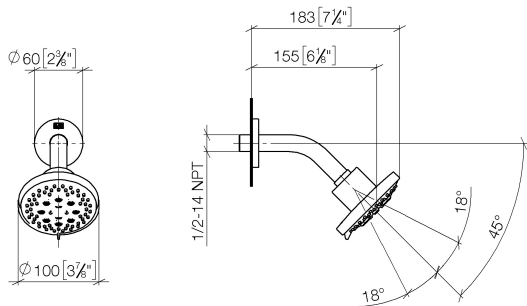

Codes & Standards

ASME A112.18.1 California Energy Commission (CEC) cUPC EPA WaterSense

WaterSense



Certificates and sustainability

IAPMO_4976 IAPMO_11777

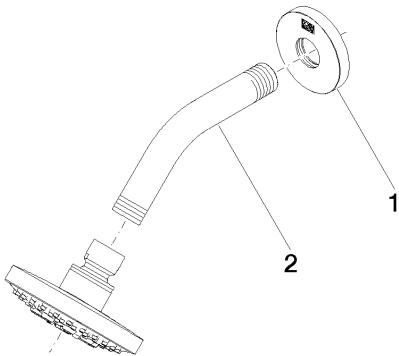

Spare parts list

Number	Item Number	Designation	Number of units	Lead time
1	90 27 83 018 00-00	rosette	1.00	2
2	90 11 03 011 11-00	connection	1.00	2