





MADISON Rain shower ceiling-mounted 7-7/8" - Chrome

MADISON

28 565 977 Product version up to 12/5/2019

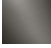

- Rain shower diameter 7-7/8"
- PURE RAIN, flow rate max. 1.8 gpm (at 3 bar)
- 7-1/4" distance between ceiling and bottom of showerhead
- Flange diameter 2-1/8"
- 1/2" connection
- Descaling system
- This product reduces water consumption by 28% (compared to requirements of EPAct '92)
- This product can help a building meet the requirements of Green Building Rating Systems, e.g. LEED®, BREEAM®, DGNB

	Chrome	28 565 977-00 0010
	Brushed Platinum	28 565 977-06 0010
	Platinum	28 565 977-08 0010
	Durabrand (23kt Gold)	28 565 977-09 0010
	Brushed Durabrand (23kt Gold)	28 565 977-28 0010
	Brushed Dark Platinum	28 565 977-99 0010

Required article

	Concealed wall elbow -	35 085 970-90
	<ul style="list-style-type: none"> •Max. rough in depth 6-3/8" •Min. rough in depth 3-1/2" 	0010



MADISON Rain shower ceiling-mounted 7-7/8" - Chrome

MADISON

28 565 977 Product version up to 12/5/2019

mm [inches]

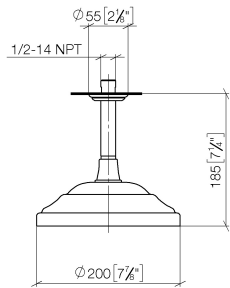

Codes & Standards

ASME A112.18.1	California Energy Commission (CEC)	cUPC	EPA WaterSense
WaterSense			

Certificates and sustainability

IAPMO_4976	IAPMO_11777
------------	-------------

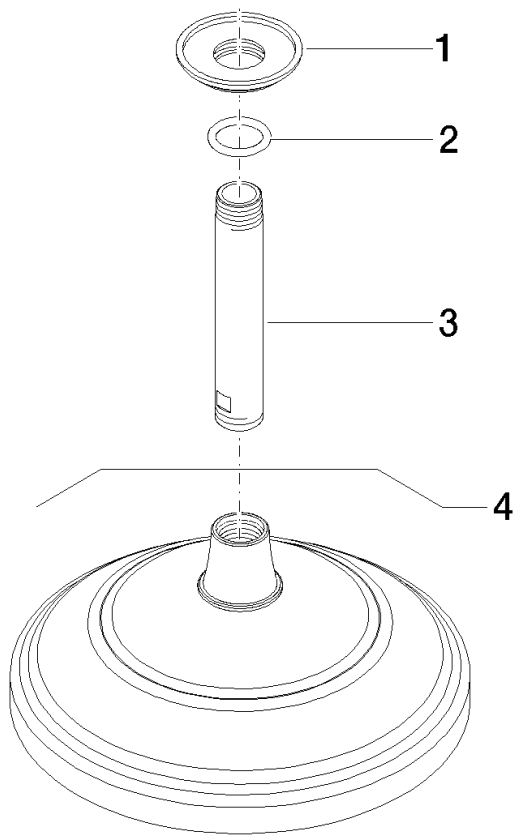

Spare parts list

Number	Item Number	Designation	Number of units	Lead time
4	28 535 977-00 0010	shower	1.00	60
3	09 11 03 018-00	connection	1.00	10
1	09 27 35 003-00	rosette	1.00	10
2	90 14 10 026 00 90	seal	1.00	2