



VAIA Pillar-tap, wall-mounted cold water only without drain - Brushed Dark Brass

VAIA

30 010 809 Product version from 4/1/2025



- 6" Projection
 - Rigid spout
 - Round aerated stream
 - Adapter, male thread 3/4"
 - 1-3/8" hole diameter
 - Flange diameter 2-3/8"
 - Water flow rate limited to max. 1.2 gpm
 - lead-free
 - This product can help a building meet the requirements of Green Building Rating Systems, e.g. LEED®, BREEAM®, DGNB
- (ADA)

| | | |
|------------------------------------------------------------------------------------|--------------------------------|--------------------|
|  | Brushed Dark Brass | 30 010 809-39 0010 |
|  | Chrome | 30 010 809-00 0010 |
|  | Brushed Platinum | 30 010 809-06 0010 |
|  | Platinum | 30 010 809-08 0010 |
|  | Dark Chrome | 30 010 809-19 0010 |
|  | Brushed Durabronze (23kt Gold) | 30 010 809-28 0010 |
|  | Brushed Bronze | 30 010 809-42 0010 |
|  | Brushed Champagne (22kt Gold) | 30 010 809-46 0010 |
|  | Champagne (22kt Gold) | 30 010 809-47 0010 |
|  | Brushed Dark Platinum | 30 010 809-99 0010 |



VAIA Pillar-tap, wall-mounted cold water only without drain - Brushed Dark Brass

VAIA

30 010 809 Product version from 4/1/2025

mm [inches]

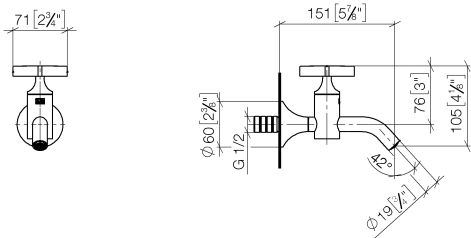

Codes & Standards

| | | | |
|-----|------------------------------------|--------|-------|
| ADA | California Energy Commission (CEC) | NSF372 | NSF61 |
|-----|------------------------------------|--------|-------|

Certificates and sustainability

IAPMO_6397

IAPMO_N-4976

VAIA Pillar-tap, wall-mounted cold water only without drain - Brushed Dark Brass

VAIA

30 010 809 Product version from 4/1/2025

Parts for other
finishes can be found
here: [Chrome](#)

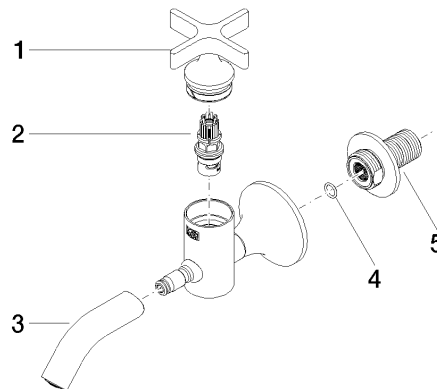

Spare parts list

| Number | Item Number | Designation | Number of units | Lead time |
|--------|--------------------|-------------|-----------------|-----------|
| 4 | 90 14 10 060 00 90 | seal | 1.00 | 2 |
| 3 | 90 28 22 381 01-39 | spout | 1.00 | 30 |
| 2 | 90 90 03 175 00 90 | top | 1.00 | 2 |
| 5 | 09 24 03 269 90 | nipple | 1.00 | 2 |
| 1 | 90 20 66 025 00-39 | handle | 1.00 | 30 |