



TARA Pillar-tap, wall-mounted cold water only without drain - Dark Chrome

30 010 892



- 5-1/2" Projection
- Rigid spout
- Round aerated stream
- Adapter, male thread 3/4"
- 1-1/4" hole diameter
- Flange diameter 2-1/8"
- Water flow rate limited to max. 1.2 gpm
- lead-free
- This product can help a building meet the requirements of Green Building Rating Systems, e.g. LEED®, BREEAM®, DGNB

(ADA)



TARA Pillar-tap, wall-mounted cold water only without drain - Dark Chrome

30 010 892

mm [inches]

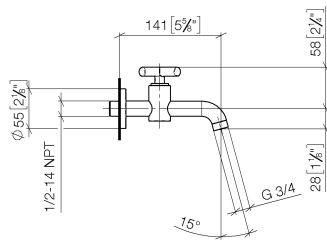

Codes & Standards

ADA

California Energy
Commission
(CEC)

NSF/ANSI 372

NSF372

Certificates

IAPMO_6

TARA Pillar-tap, wall-mounted cold water only without drain - Dark Chrome

30 010 892

