



LISSE Single-lever tub mixer for wall-mounted installation without hand shower set - Brushed Dark Platinum

LISSE

33 200 845 Product version from 4/1/2024



- 7-1/2"-7-7/8" Projection
 - Round aerator
 - Integrated diverter
 - 3/8" Shower outlet
 - Flanges Ø 2-3/8"
 - 1/2" connection
 - Center to center 5-7/8" ± 5/8"
 - Water flow rate limited to max. 3.6 gpm
- Internal backflow preventer.**

NOTE: Local building codes may require the use of an anti-scald device. Please refer to remote pressure balance valve (35 914 970 90)
NOTE: Hand shower sold separately. For more hand shower options, please see the miscellaneous articles section of each series.

Internal backflow preventer.

NOTE: Local building codes may require the use of an anti-scald device. Please refer to remote pressure balance valve (35 914 970 90)

NOTE: Hand shower sold separately. For more hand shower options, please see the miscellaneous articles section of each series.

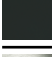
	Brushed Dark Platinum	33 200 845-99
	Chrome	33 200 845-00
	Brushed Platinum	33 200 845-06
	Dark Chrome	33 200 845-19
	Brushed Light Gold	33 200 845-27
	Matte Black	33 200 845-33
	Brushed Chrome	33 200 845-93

Required article



- Rough-in adapter -** 35 080 970-90
•Please order 2 adapters 0010

LISSÉ Single-lever tub mixer for wall-mounted installation without hand shower set - Brushed Dark Platinum

LISSÉ

33 200 845 Product version from 4/1/2024
mm [inches]

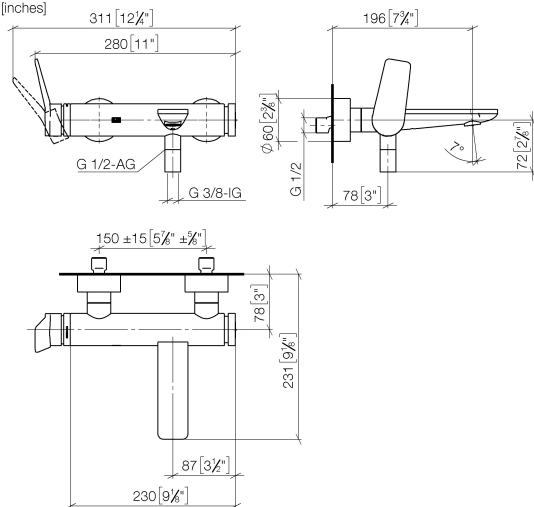

Flow rate chart



Codes & Standards

ASME A112.18.1	California Energy Commission (CEC)	cUPC	DIN 4109
ISO 3822	Scottish Water Byelaws	UK Water Supply Regulations	Ü-Zeichen



LISSE Single-lever tub mixer for wall-mounted installation without hand shower
set - Brushed Dark Platinum

LISSE

33 200 845 Product version from 4/1/2024

Certificates and sustainability

LGA_9

WRAS_2311

IAPMO_4976 (

LISSÉ Single-lever tub mixer for wall-mounted installation without hand shower set - Brushed Dark Platinum

LISSÉ

33 200 845 Product version from 4/1/2024

