



IMO Single-lever lavatory mixer with extended shank without drain - Brushed Light Gold





IMO

33 537 671 Product version from 4/1/2024

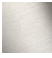

- 6-3/4" Projection
- Rigid spout
- Rectangular aerated stream
- Total height 11-3/4"
- Height to aerator/spout outlet 9"
- 1-3/8" hole diameter
- 2 x pressure hose with 3/8" compression fitting
- Water flow rate limited to max. 1.2 gpm
- lead-free
- This product can help a building meet the requirements of Green Building Rating Systems, e.g. LEED®, BREEAM®, DGNB

(ADA)

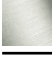
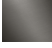
	Brushed Light Gold	33 537 671-27 0010
	Chrome	33 537 671-00 0010
	Brushed Platinum	33 537 671-06 0010
	Dark Chrome	33 537 671-19 0010
	Matte Black	33 537 671-33 0010
	Brushed Chrome	33 537 671-93 0010
	Brushed Dark Platinum	33 537 671-99 0010

**IMO Single-lever lavatory mixer with extended shank without drain - Brushed
Light Gold**

IMO

33 537 671 Product version from 4/1/2024

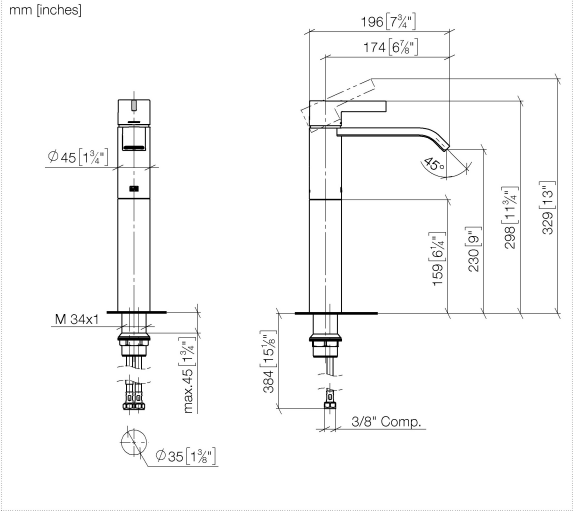

Codes & Standards

ADA

NSF372

NSF61

Certificates and sustainability

IAPMO_N-4976

IAPMO_6397

IMO Single-lever lavatory mixer with extended shank without drain - Brushed Light Gold

IMO

33 537 671 Product version from 4/1/2024

Parts for other
finishes can be found
here: [Chrome](#)

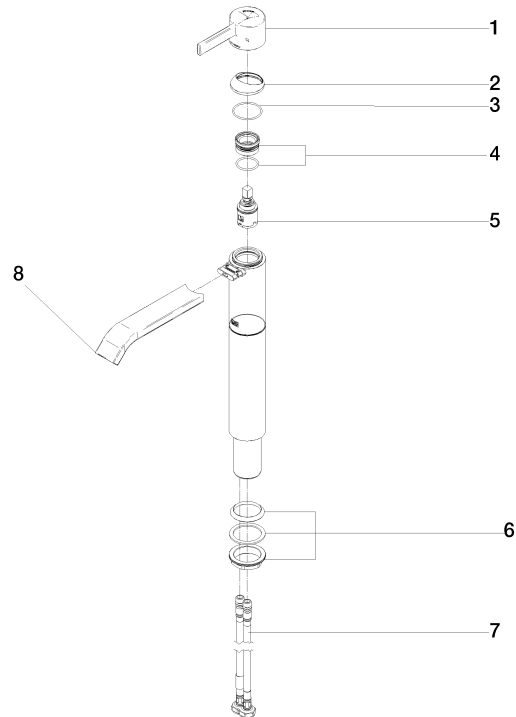

Spare parts list

Number	Item Number	Designation	Number of units	Lead time
8	90 28 22 440 01-27	spout	1.00	30
5	90 15 05 042 00 90	cartridge	1.00	2
6	04 23 10 044 07 90	fixing set	1.00	2
2	90 28 30 059 00-27	cover	1.00	-
Spare part can no longer be ordered, please order the replacement item				
3	09 14 10 102 90	seal	1.00	2
7	04 30 04 105 00 90	hose	2.00	2
1	90 20 67 019 00-27	handle	1.00	30
4	90 23 10 146 00 90	nut	1.00	2