

LOT Single-lever mixer - Brushed Dark Platinum

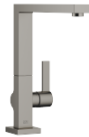





LOT

33 800 680
Product version from 3/1/2023



- 9-1/4" Projection
- Swiveling spout 360°
- Aerated stream
- Total height 11-1/2"
- Height to aerator/spout outlet 10-1/2"
- 1-3/8" hole diameter
- 2 x pressure hose with 3/8" compression fitting
- Water flow rate limited to max. 1.5 gpm
- lead-free
- This product can help a building meet the requirements of Green Building Rating Systems, e.g. LEED®, BREEAM®, DGNB

(ADA)  
Combination with side spray set or profi side spray set not possible.

	Brushed Dark Platinum	33 800 680-99 0010
	Chrome	33 800 680-00 0010
	Brushed Platinum	33 800 680-06 0010
	Platinum	33 800 680-08 0010
	Dark Chrome	33 800 680-19 0010
	Brushed Durabronze (23kt Gold)	33 800 680-28 0010
	Brushed Bronze	33 800 680-42 0010
	Brushed Champagne (22kt Gold)	33 800 680-46 0010
	Champagne (22kt Gold)	33 800 680-47 0010

Recommended article

	<b>Soap dispenser with flange - Brushed Dark Platinum</b>	82 439 970-99
---	---	---------------

Recommended article

	<b>AIR SWITCH operating button, trim parts only - Brushed Dark Platinum</b>	10 714 970-99
---	---	---------------



LOT Single-lever mixer - Brushed Dark Platinum

LOT

33 800 680 Product version from 3/1/2023

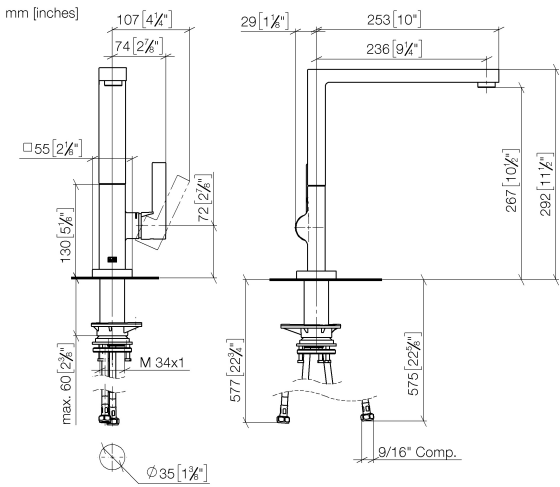

Codes & Standards

ADA	ASME A112.18.1	California Energy Commission (CEC)	cUPC
NSF372	NSF61		

Certificates and sustainability

IAPMO\_6397 IAPMO\_N-4976 IAPMO\_4976 (

## LOT Single-lever mixer - Brushed Dark Platinum

LOT

33 800 680 Product version from 3/1/2023

Parts for other  
finishes can be found  
here: [Chrome](#)

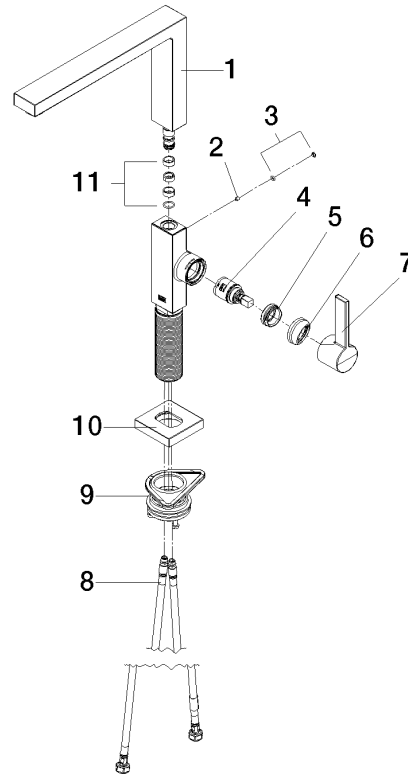

### Spare parts list

Number	Item Number	Designation	Number of units	Lead time
2	09 31 11 044 90	pin	1.00	2
11	90 28 10 207 00 90	gasket kit	1.00	2
5	09 24 04 266 90	nut	1.00	2
9	90 30 10 057 00 90	fixing set	1.00	2
3	90 31 20 087 00-99	plug	1.00	20
6	90 28 30 052 00-99	cover	1.00	20
7	90 20 86 004 00-99	handle	1.00	20
8	04 30 04 103 00 90	hose	2.00	2
10	90 27 86 004 00-99	rosette	1.00	20
1	90 11 06 218 01-99	spout	1.00	20
4	90 15 05 042 00 90	cartridge	1.00	2