

META SQUARE Single-lever mixer For sprayer / professional sprayer -
Brushed Durabronze (23kt Gold)

META SQUARE



33 826 861 Product version from 2/1/2023



- 9-1/4" Projection
- Swiveling spout 360°
- Optional restricted swivel available with swivel limiter set 12 820 970 90
- Aerated stream
- Water flow rate limited to max. 1.5 gpm
- lead-free
- This product can help a building meet the requirements of Green Building Rating Systems, e.g. LEED®, BREEAM®, DGNB

(ADA)

Single-lever mixer for use with rinsers and professional sprayers

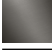
	Brushed Durabronze (23kt Gold)	33 826 861-28 0010
	Chrome	33 826 861-00 0010
	Brushed Platinum	33 826 861-06 0010
	Platinum	33 826 861-08 0010
	Durabronze (23kt Gold)	33 826 861-09 0010
	Dark Chrome	33 826 861-19 0010
	Matte Black	33 826 861-33 0010
	Brushed Bronze	33 826 861-42 0010
	Brushed Champagne (22kt Gold)	33 826 861-46 0010
	Champagne (22kt Gold)	33 826 861-47 0010
	Brushed Chrome	33 826 861-93 0010
	Brushed Dark Platinum	33 826 861-99 0010

Recommended article



Side spray set - Brushed Durabronze (23kt Gold)

27 731 970-28

META SQUARE Single-lever mixer For sprayer / professional sprayer -
Brushed Durabronze (23kt Gold)

META SQUARE

33 826 861 Product version from 2/1/2023
mm [inches] 104 [4 1/8"] 24

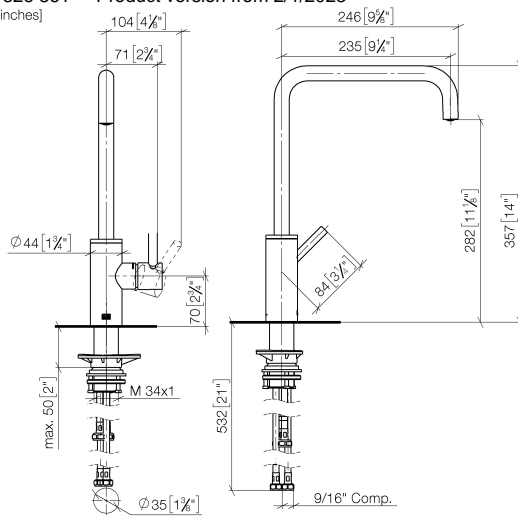

Codes & Standards

ADA	California Energy Commission (CEC)	NSF372	NSF61
-----	------------------------------------	--------	-------

Certificates and sustainability

IAPMO_6397 IAPMO_N-4976

META SQUARE Single-lever mixer For sprayer / professional sprayer - Brushed Durabronz (23kt Gold)

META SQUARE

33 826 861 Product version from 2/1/2023

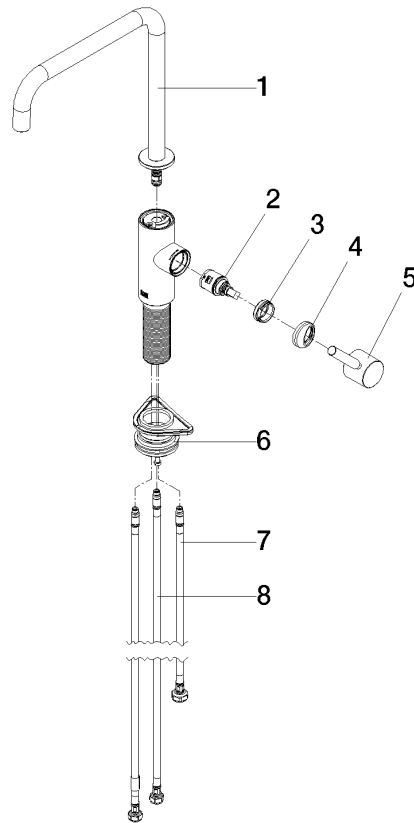

Spare parts list

Number	Item Number	Designation	Number of units	Lead time
1	90 28 22 284 01-28	spout	1.00	20
5	90 20 66 033 00-28	handle	1.00	20
7	04 30 04 103 00 90	hose	1.00	2
3	09 24 04 266 90	nut	1.00	2
4	90 28 30 052 00-28	cover	1.00	20
8	04 30 04 100 00 90	hose	2.00	2
2	90 15 05 042 00 90	cartridge	1.00	2
6	04 23 10 044 08 90	fixing set	1.00	2