









TARA ULTRA PIVOT Single-lever mixer - Platinum

TARA ULTRA

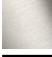
33 845 875 Product version from 3/11/2013 to 10/27/2020

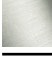
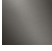

- 21-3/4" Projection
 - Swiveling spout 360°
 - Aerated stream
 - Total height 14-5/8"
 - Height to aerator/spout outlet 11-3/8"
 - Flange 2-1/8"
 - 1-1/8" hole diameter
 - 2 x pressure hose with 3/8" compression fitting
 - Water flow rate limited to max. 1.5 gpm
 - lead-free
 - This product can help a building meet the requirements of Green Building Rating Systems, e.g. LEED®, BREEAM®, DGNB
- (ADA)
- Combination with side spray set or profi side spray set not possible.

	Platinum	33 845 875-08 0010
	Chrome	33 845 875-00 0010
	Brushed Platinum	33 845 875-06 0010
	Durabronze (23kt Gold)	33 845 875-09 0010
	Dark Chrome	33 845 875-19 0010
	Brushed Durabronze (23kt Gold)	33 845 875-28 0010
	Brushed Bronze	33 845 875-42 0010
	Brushed Champagne (22kt Gold)	33 845 875-46 0010
	Champagne (22kt Gold)	33 845 875-47 0010
	Brushed Chrome	33 845 875-93 0010
	Brushed Dark Platinum	33 845 875-99 0010

Recommended article

	Soap dispenser with flange - Platinum	82 444 970-08
---	--	---------------

Recommended article

	AIR SWITCH operating button, trim parts only - Platinum	10 713 970-08
---	--	---------------

33 845 875 Product version from 3/11/2013 to 10/27/2020

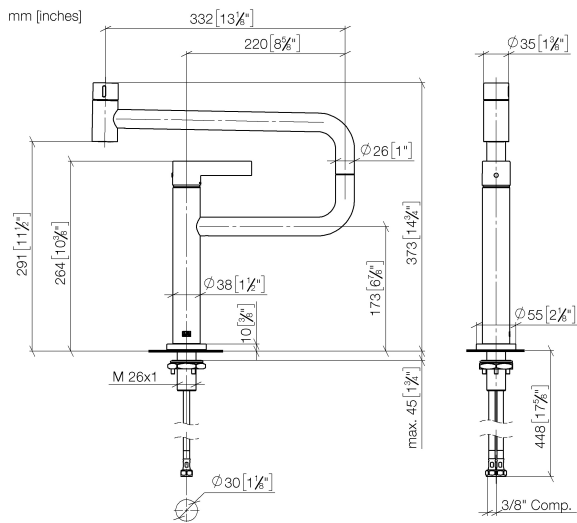

Flow rate chart

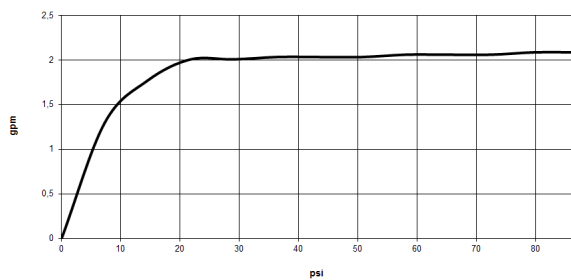

Codes & Standards

ADA

California Energy
Commission
(CEC)

NSF372

NSF61



TARA ULTRA PIVOT Single-lever mixer - Platinum

TARA ULTRA

33 845 875 Product version from 3/11/2013 to 10/27/2020

Certificates and sustainability

IAPMO_N-4976 IAPMO_6397

33 845 875 Product version from 3/11/2013 to 10/27/2020

Parts for other
finishes can be found
here: Chrome

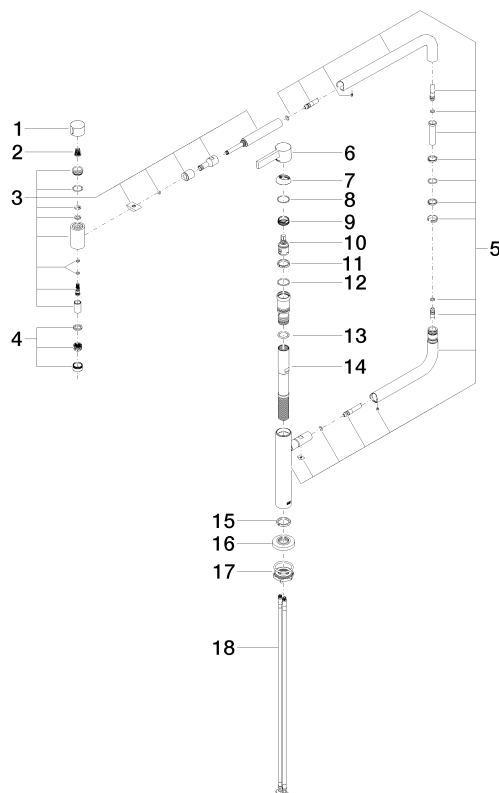

Spare parts list

Number	Item Number	Designation	Number of units	Lead time
8	09 14 10 091 90	seal	1.00	2
6	90 20 87 004 00-08	handle	1.00	40
4	90 23 01 026 08-08	aerator	1.00	40
1	09 20 62 025-08	handle	1.00	60
14	09 30 01 126 90	connection	1.00	2
7	09 28 30 013-08	cover	1.00	40
3	90 19 87 001 00-08	spout	1.00	40
11	09 28 10 156 90	ring	1.00	2
17	04 30 11 085 87 90	fixing set	1.00	2
13	09 14 10 081 90	seal	1.00	2
9	09 24 04 266 90	nut	1.00	2
15	09 28 10 159 90	ring	1.00	2
5	90 28 22 257 00-08	joint	1.00	40
18	04 30 04 103 00 90	hose	2.00	2
10	90 15 05 042 00 90	cartridge	1.00	2
16	09 27 87 033-08	rosette	1.00	40
2	90 12 12 002 00 90	fixing cap	1.00	2
12	90 14 10 063 00 90	seal	1.00	2