









TARA ULTRA PIVOT Single-lever mixer - Brushed Bronze

TARA ULTRA

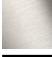
33 845 875    Product version from 10/27/2020

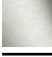
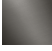

- 21-3/4" Projection
  - Swiveling spout 360°
  - Aerated stream
  - Total height 14-5/8"
  - Height to aerator/spout outlet 11-3/8"
  - Flange 2-1/8"
  - 1-1/8" hole diameter
  - 2 x pressure hose with 3/8" compression fitting
  - Water flow rate limited to max. 1.5 gpm
  - lead-free
  - This product can help a building meet the requirements of Green Building Rating Systems, e.g. LEED®, BREEAM®, DGNB (ADA)
- Combination with side spray set or profi side spray set not possible.

	Brushed Bronze	33 845 875-42 0010
	Chrome	33 845 875-00 0010
	Brushed Platinum	33 845 875-06 0010
	Platinum	33 845 875-08 0010
	Durabrass (23kt Gold)	33 845 875-09 0010
	Dark Chrome	33 845 875-19 0010
	Brushed Durabrass (23kt Gold)	33 845 875-28 0010
	Brushed Champagne (22kt Gold)	33 845 875-46 0010
	Champagne (22kt Gold)	33 845 875-47 0010
	Brushed Chrome	33 845 875-93 0010
	Brushed Dark Platinum	33 845 875-99 0010

Recommended article

**AIR SWITCH operating button, trim parts only - Brushed Bronze**    10 713 970-42



Recommended article

**Soap dispenser with flange - Brushed Bronze**    82 444 970-42



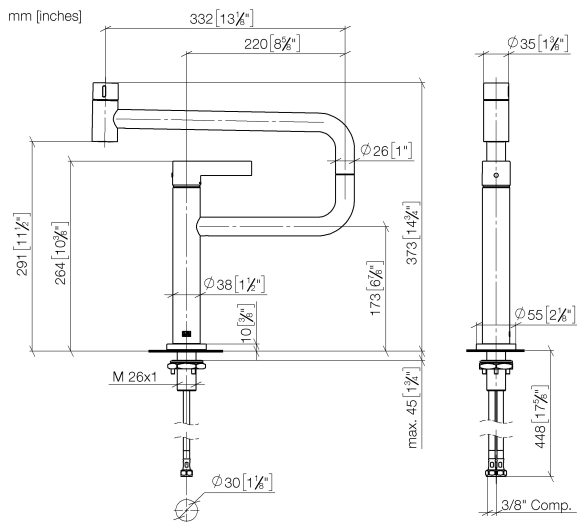

### Flow rate chart

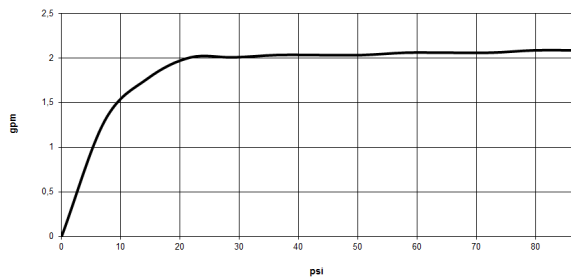

## Codes & Standards

ADA

California Energy  
Commission  
(CEC)

NSF372

NSF61



## TARA ULTRA PIVOT Single-lever mixer - Brushed Bronze

TARA ULTRA

33 845 875 Product version from 10/27/2020

### Certificates and sustainability

IAPMO\_N-4976

IAPMO\_6397

33 845 875 Product version from 10/27/2020

Parts for other  
finishes can be found  
here: [Chrome](#)

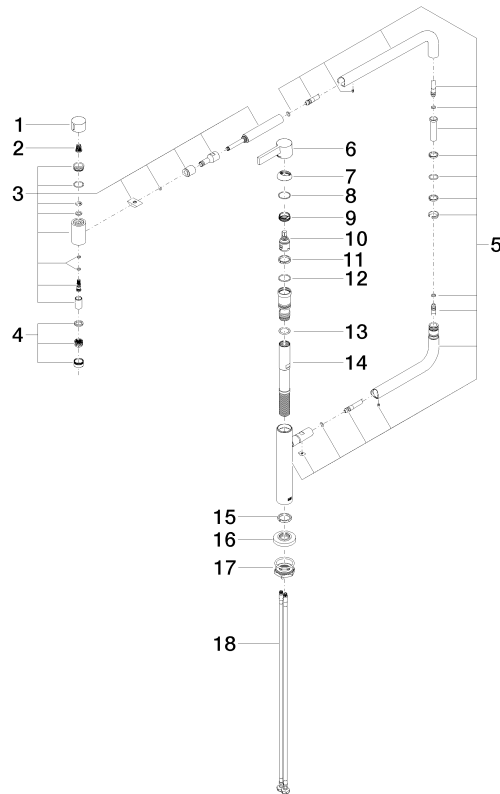

## Spare parts list

Number	Item Number	Designation	Number of units	Lead time
1	09 20 62 025-42	handle	1.00	60
7	09 28 30 013-42	cover	1.00	60
17	04 30 11 085 87 90	fixing set	1.00	2
16	09 27 87 033-42	rosette	1.00	60
2	90 12 12 002 00 90	fixing cap	1.00	2
13	09 14 10 081 90	seal	1.00	2
6	90 20 87 004 00-42	handle	1.00	30
11	09 28 10 156 90	ring	1.00	2
14	09 30 01 126 90	connection	1.00	2
4	90 23 01 026 08-42	aerator	1.00	30
5	90 28 22 257 00-42	joint	1.00	30
10	90 15 05 042 00 90	cartridge	1.00	2
3	90 19 87 001 00-42	spout	1.00	30
8	09 14 10 091 90	seal	1.00	2
12	90 14 10 063 00 90	seal	1.00	2
15	09 28 10 159 90	ring	1.00	2
9	09 24 04 266 90	nut	1.00	2
18	04 30 04 103 00 90	hose	2.00	2