

META Tub thermostat for wall-mounted installation with hand shower set -
Chrome

META

34 234 979 Product version from 7/1/2023



- Spout: Round aerated stream
 - Water flow rate limited to max. 4.5 gpm
 - Hand-held shower: COMPACT RAIN, flow rate max. 1.8 gpm (at 3 bar)
 - Hand shower set with anti-scale technology
 - Diverter with integrated volume control
 - Flanges Ø 2-3/8"
 - 8-1/4" Projection
 - 1/2" connection
 - Center to center 5-7/8" ± 5/8"
 - Metal shower hose 49-1/4" with anti-twist device
 - Showerhead holder with rosette, Ø 2-1/4"
- Internal backflow preventer.**

Internal backflow preventer.

	Chrome	34 234 979-00
	Brushed Platinum	34 234 979-06
	Dark Chrome	34 234 979-19
	Light gold	34 234 979-26
	Brushed Light Gold	34 234 979-27
	Matte Black	34 234 979-33
	Brushed Dark Brass	34 234 979-39
	Brushed Bronze	34 234 979-42
	Brushed Champagne (22kt Gold)	34 234 979-46
	Champagne (22kt Gold)	34 234 979-47
	Brushed Chrome	34 234 979-93
	Brushed Dark Platinum	34 234 979-99

Required article

Rough-in adapter -

- Please order 2 adapters

35 080 970-90
0010



META Tub thermostat for wall-mounted installation with hand shower set - Chrome

META

34 234 979 Product version from 7/1/2023
mm [inches]



Flow rate chart

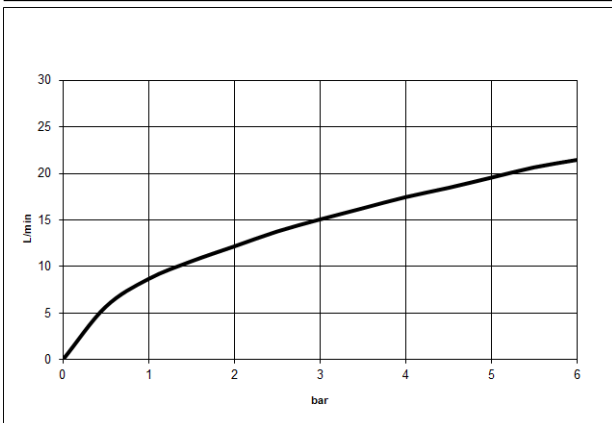

Codes & Standards

California Energy
Commission
(CEC)

DIN 4109

EN 1717

ISO 3822

Ü-Zeichen



META Tub thermostat for wall-mounted installation with hand shower set - Chrome

META

34 234 979 Product version from 7/1/2023

Certificates and sustainability

LGA_18

Belgaqua_21-032-2

META Tub thermostat for wall-mounted installation with hand shower set - Chrome

META

34 234 979 Product version from 7/1/2023

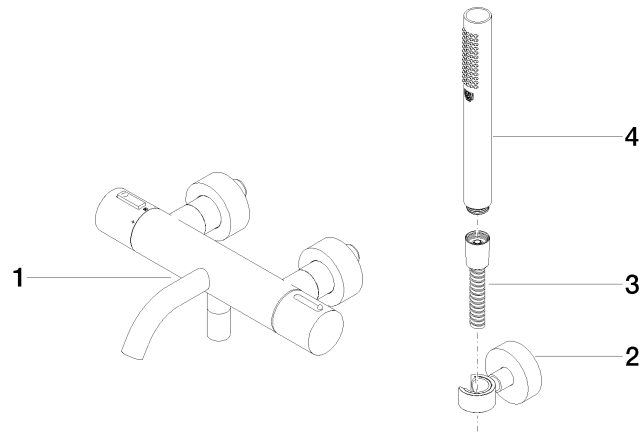

Spare parts list

Number	Item Number	Designation	Number of units	Lead time
4	28 019 979-00	Hand shower - Chrome	1.00	60
2	28 050 920-00	holder	1.00	60
3	90 30 02 072 00-00	Metal shower hose 1/2" x 3/8" x 49-1/4" - Chrome	1.00	10
1	34 201 979-00	META Tub thermostat for wall-mounted installation without hand shower set - Chrome	1.00	10