

Shower thermostat For wall mounting - Brushed Chrome
SERIES-VARIOUS

34 443 979
Product version from 5/1/2022











- 3/8" Shower outlet
- Flanges Ø 2-3/4"
- 1/2" connection
- Center to center 5-7/8" ± 1/2"
- with volume control

Internal backflow preventer.

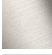
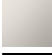
Can be combined with hand shower sets and slide bar sets.

Internal backflow preventer.

Can be combined with hand shower sets and slide bar sets.

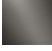
	Brushed Chrome	34 443 979-93
	Chrome	34 443 979-00
	Brushed Platinum	34 443 979-06
	Platinum	34 443 979-08
	Dark Chrome	34 443 979-19
	Brushed Durabrass (23kt Gold)	34 443 979-28
	Matte Black	34 443 979-33
	Brushed Dark Brass	34 443 979-39
	Brushed Champagne (22kt Gold)	34 443 979-46
	Champagne (22kt Gold)	34 443 979-47
	Brushed Dark Platinum	34 443 979-99

Required article



Rough-in adapter -

- Please order 2 adapters

35 080 970-90
0010

Required article



**TARA Volume control handle -
Brushed Chrome**

11 431 892-93

34 443 979 Product version from 5/1/2022

mm [inches]

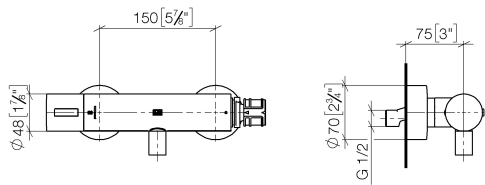

Flow rate chart

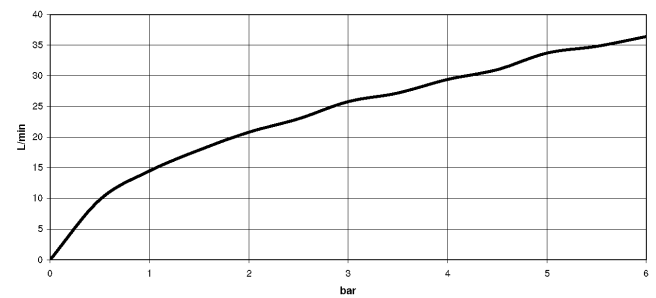

Codes & Standards

DIN 4109	EN 1717	ISO 3822	Scottish Water Byelaws
UK Water Supply Regulations	Ü-Zeichen		



Shower thermostat For wall mounting - Brushed Chrome

SERIES-VARIOUS

34 443 979 Product version from 5/1/2022

Certificates and sustainability

Belgaqua_22_281_2 LGA_29 WRAS_2204

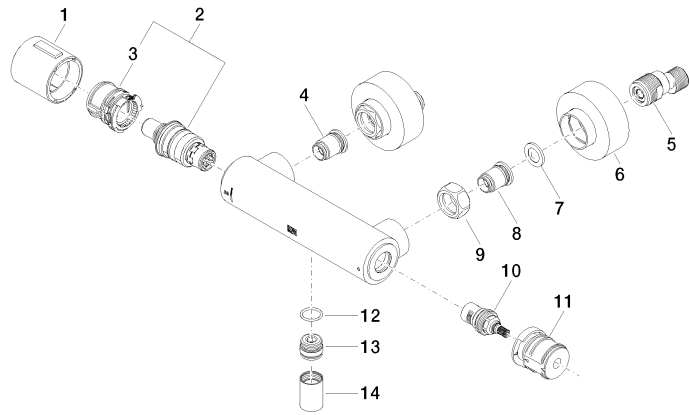

Spare parts list

Number	Item Number	Designation	Number of units	Lead time
4	04 31 20 530 00 90	insert	1.00	2
3	90 30 40 010 00 90	regulator	1.00	2
1	90 17 33 015 00-93	handle	1.00	20
11	90 30 40 017 00 90	base	1.00	2
5	04 11 04 030 00 90	connection	2.00	2
13	09 31 20 511-93	nipple	1.00	20
6	90 31 20 512 00-93	rosette	2.00	20
10	90 90 03 236 00 90	top	1.00	2
8	04 31 20 540 00 90	insert	1.00	2
9	09 24 77 008-00	nut	2.00	10
2	90 15 02 070 00 90	cartridge	1.00	2
7	09 29 30 050 90	sieve	2.00	2
14	90 21 02 069 00-93	cover	1.00	20
12	90 14 10 010 00 90	seal	1.00	2