

Exposed shower set with shower thermostat without hand shower - Brushed Champagne (22kt Gold)

34 459 979 Product version from 7/1/2023



- Projection 17-7/8"
 - Rainshower
 - Rain shower with descaling system
 - Rain shower diameter 8-5/8"
 - Rain shower water flow rate limited to max. 1.8 gpm (at 3 bar)
 - Diverter with integrated volume control
 - Height from center of faucet to top of shower arm 45-1/4"
 - Flanges Ø 2-3/4"
 - Height from center of faucet to bottom of rainhead 39-3/4"
 - Center to center 5-7/8" ± 1/2"
 - Metal shower hose 68-7/8" with anti-twist device
 - 1/2" connection
 - Slide bar
 - Pipe diameter 7/8"
 - with drip prevention
 - This product reduces water consumption by 28% (compared to requirements of EPAct '92)
 - This product contributes to meeting the requirements of the LEED® Green Building Rating
- Internal backflow preventer.**

NOTE: Hand shower sold separately. Please see hand shower options under the miscellaneous articles section of each series.

Internal backflow preventer.

NOTE: Hand shower sold separately. Please see hand shower options under the miscellaneous articles section of each series.

| | | |
|--|--------------------------------|--------------------|
| | Brushed Champagne (22kt Gold) | 34 459 979-46 0010 |
| | Chrome | 34 459 979-00 0010 |
| | Brushed Platinum | 34 459 979-06 0010 |
| | Platinum | 34 459 979-08 0010 |
| | Dark Chrome | 34 459 979-19 0010 |
| | Light gold | 34 459 979-26 0010 |
| | Brushed Light Gold | 34 459 979-27 0010 |
| | Brushed Durabronze (23kt Gold) | 34 459 979-28 0010 |
| | Matte Black | 34 459 979-33 0010 |
| | Brushed Bronze | 34 459 979-42 0010 |
| | Champagne (22kt Gold) | 34 459 979-47 0010 |
| | Brushed Chrome | 34 459 979-93 0010 |
| | Brushed Dark Platinum | 34 459 979-99 0010 |

Required article

- Rough-in adapter -**
• Please order 2 adapters

35 080 970-90
0010



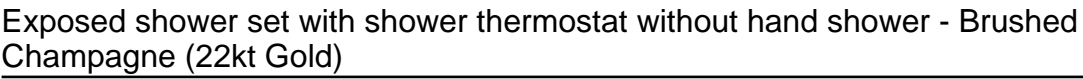

mm [inches]
1:10

The graph shows a non-linear relationship between p_i and p_m . The curve starts at the origin (0,0) and increases rapidly at first, then more gradually, approaching a horizontal asymptote at $p_m = 1.8$. The x-axis is labeled p_i and ranges from 0 to 80. The y-axis is labeled p_m and ranges from 0.0 to 2.5.

| | |
|---------------------------------|--|
| ASME A112.18.1/CSA B125.1 | California Energy Commission (CEC) |
|---------------------------------|--|

Exposed shower set with shower thermostat without hand shower - Brushed Champagne (22kt Gold)

34 459 979 Product version from 7/1/2023

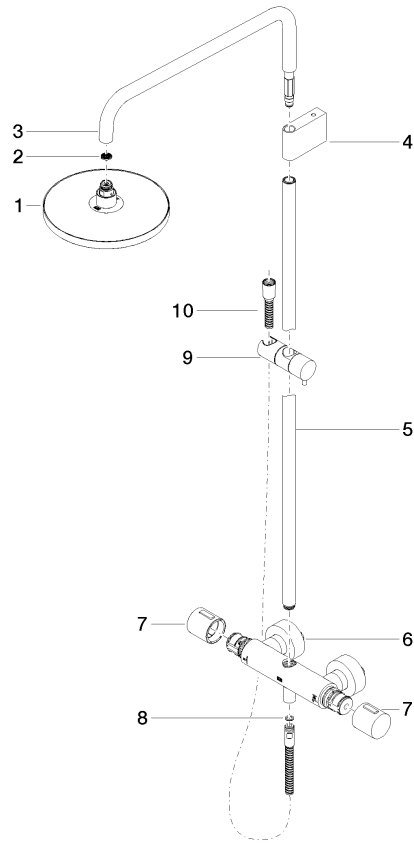

Spare parts list

| Number | Item Number | Designation | Number of units | Lead time |
|--------|--------------------|---|-----------------|-----------|
| 1 | 04 12 05 092 10-46 | shower | 1 | 60 |
| 2 | 09 23 01 039 90 | sieve | 1 | 2 |
| 3 | 90 28 22 348 00-46 | pipe | 1 | 30 |
| 4 | 90 17 11 150 00-46 | holder | 1 | 30 |
| 5 | 90 28 22 349 00-46 | pipe | 1 | 30 |
| 6 | 04 17 01 250 00-46 | connection | 1 | 60 |
| 7 | 90 17 33 015 00-46 | handle | 2 | 30 |
| 8 | 90 14 20 026 00 90 | seal | 1 | 2 |
| 9 | 12 570 970-46 | Slider - Brushed Champagne (22kt Gold) | 1 | 30 |
| 10 | 28 322 970-46 | Metal shower hose 1/2" x 3/8" x 68-7/8" - Brushed Champagne (22kt Gold) | 1 | 30 |