

## Exposed shower set with shower thermostat without hand shower - Brushed Platinum

SERIES SPECIFIC

34 459 980 Product version from 6/1/2024



- Projection 17-7/8"
- Rainshower
- 11-3/4" x 9-1/2" Rain showerhead
- Rain shower with descaling system
- Rain shower water flow rate limited to max. 1.8 gpm (at 3 bar)
- Function from: 1.6 gpm
- Diverter with integrated volume control
- Flanges Ø 2-3/4"
- Height from center of faucet to bottom of rainhead 39-3/4"
- Height from center of faucet to top of shower arm 45-1/4"
- Center to center 5-7/8" ± 1/2"
- Metal shower hose 68-7/8" with anti-twist device
- 1/2" connection
- Slide bar
- Pipe diameter 7/8"
- with drip prevention
- This product reduces water consumption by 28% (compared to requirements of EPA '92)
- This product contributes to meeting the requirements of the LEED® Green Building Rating

**Internal backflow preventer.**  
**NOTE: Hand shower sold separately. Please see hand shower options under the miscellaneous articles section of each series.**

Internal backflow preventer.

NOTE: Hand shower sold separately. Please see hand shower options under the miscellaneous articles section of each series.

|  |                               |                    |
|--|-------------------------------|--------------------|
|  | Brushed Platinum              | 34 459 980-06 0010 |
|  | Chrome                        | 34 459 980-00 0010 |
|  | Platinum                      | 34 459 980-08 0010 |
|  | Dark Chrome                   | 34 459 980-19 0010 |
|  | Brushed Light Gold            | 34 459 980-27 0010 |
|  | Brushed Durabrass (23kt Gold) | 34 459 980-28 0010 |
|  | Matte Black                   | 34 459 980-33 0010 |
|  | Brushed Champagne (22kt Gold) | 34 459 980-46 0010 |
|  | Champagne (22kt Gold)         | 34 459 980-47 0010 |
|  | Brushed Chrome                | 34 459 980-93 0010 |
|  | Brushed Dark Platinum         | 34 459 980-99 0010 |

### Required article

|  |                                                       |                    |
|--|-------------------------------------------------------|--------------------|
|  | <b>Rough-in adapter -</b><br>•Please order 2 adapters | 35 080 970-90 0010 |
|--|-------------------------------------------------------|--------------------|

### Required article

|  |                                                            |                    |
|--|------------------------------------------------------------|--------------------|
|  | <b>Hand shower FlowReduce -</b><br><b>Brushed Platinum</b> | 28 016 979-06 0010 |
|--|------------------------------------------------------------|--------------------|

### Required article

|  |                                                                           |                    |
|--|---------------------------------------------------------------------------|--------------------|
|  | <b>SERIES-VARIOUS Hand shower</b><br><b>FlowReduce - Brushed Platinum</b> | 28 027 979-06 0010 |
|--|---------------------------------------------------------------------------|--------------------|

### Required article

|  |                                                                           |                    |
|--|---------------------------------------------------------------------------|--------------------|
|  | <b>SERIES-VARIOUS Hand shower</b><br><b>FlowReduce - Brushed Platinum</b> | 28 025 979-06 0010 |
|--|---------------------------------------------------------------------------|--------------------|

### Required article

|  |                                                            |                    |
|--|------------------------------------------------------------|--------------------|
|  | <b>Hand shower FlowReduce -</b><br><b>Brushed Platinum</b> | 28 012 979-06 0010 |
|--|------------------------------------------------------------|--------------------|

### Required article

|  |                                                            |                    |
|--|------------------------------------------------------------|--------------------|
|  | <b>Hand shower FlowReduce -</b><br><b>Brushed Platinum</b> | 28 018 979-06 0010 |
|--|------------------------------------------------------------|--------------------|

### Required article

|  |                                                                           |                    |
|--|---------------------------------------------------------------------------|--------------------|
|  | <b>SERIES-VARIOUS Hand shower</b><br><b>FlowReduce - Brushed Platinum</b> | 28 029 979-06 0010 |
|--|---------------------------------------------------------------------------|--------------------|



## Exposed shower set with shower thermostat without hand shower - Brushed Platinum

SERIES SPECIFIC

34 459 980 Product version from 6/1/2024

mm [inches]

1:10

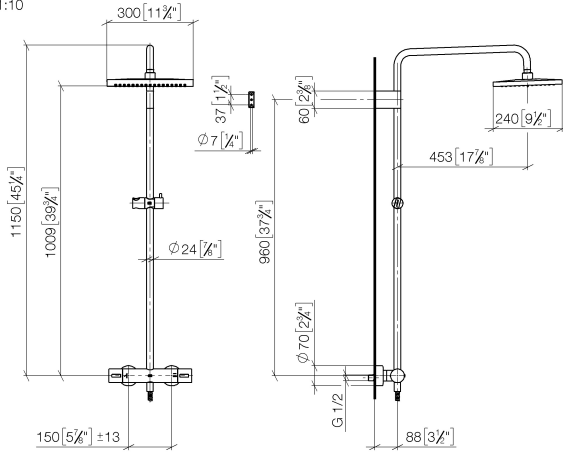

### Codes & Standards

California Energy  
Commission  
(CEC)

## Exposed shower set with shower thermostat without hand shower - Brushed Platinum

SERIES SPECIFIC

34 459 980 Product version from 6/1/2024

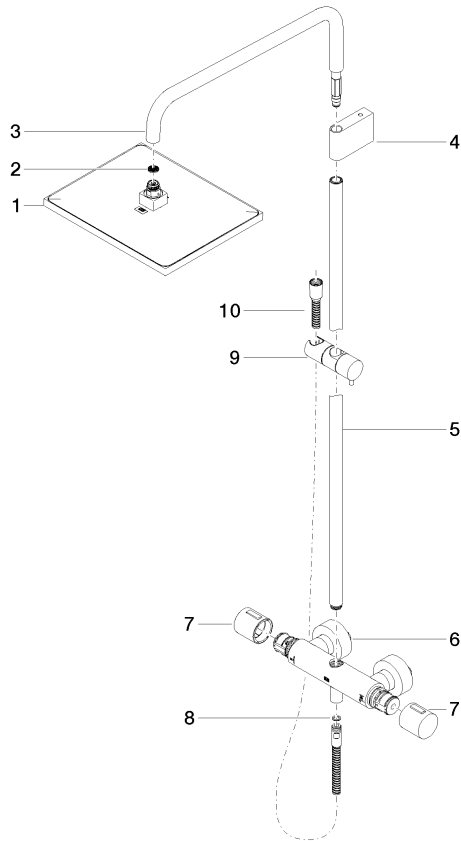

### Spare parts list

| Number | Item Number        | Designation                                                | Number of units | Lead time |
|--------|--------------------|------------------------------------------------------------|-----------------|-----------|
| 7      | 90 17 33 015 00-06 | handle                                                     | 1.00            | 10        |
| 9      | 12 570 970-06      | Slider - Brushed Platinum                                  | 1.00            | 10        |
| 4      | 90 17 11 150 00-06 | holder                                                     | 1.00            | 10        |
| 2      | 09 23 01 039 90    | sieve                                                      | 1.00            | 2         |
| 5      | 90 28 22 349 00-06 | pipe                                                       | 1.00            | 10        |
| 1      | 04 12 05 063 10-06 | shower                                                     | 1.00            | 10        |
| 6      | 04 17 01 250 00-06 | connection                                                 | 1.00            | 10        |
| 10     | 28 322 970-06      | Metal shower hose 1/2" x 3/8" x 68-7/8" - Brushed Platinum | 1.00            | 2         |
| 3      | 90 28 22 348 00-06 | pipe                                                       | 1.00            | 10        |
| 8      | 90 14 20 026 00 90 | seal                                                       | 1.00            | 2         |