



EDITION PRO Exposed shower set with shower thermostat with hand shower set - Chrome

EDITION PRO

34 461 626

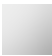

- Projection 21-1/4"
- Rainshower
- Rain shower diameter 11-3/4"
- Rain shower with descaling system
- Rain shower water flow rate limited to max. 3.7 gpm (at 3 bar)
- Hand shower: 3 individual sprays (standard, soft, massage) + 2 combinations (standard+soft, soft+massage)
- Ø 3-7/8"
- Hand shower water flow rate limited to max. 4 gpm (at 3 bar)
- Diverter with integrated volume control
- Flanges Ø 2-3/4"
- Height from center of faucet to bottom of rainhead 39-3/4"
- Height from center of faucet to top of shower arm 45-1/4"
- Center to center 5-7/8" ± 1/2"
- Metal shower hose 68-7/8" with anti-twist device
- 1/2" connection
- Slide bar
- Pipe diameter 7/8"

	Chrome	34 461 626-00
	Matte Black	34 461 626-33
	Brushed Chrome	34 461 626-93

34 461 626

mm [inches]

1:10

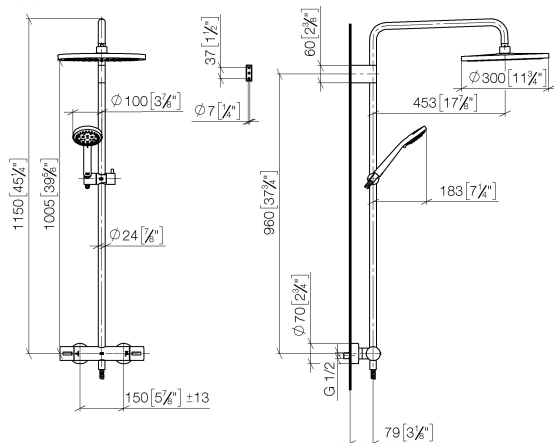

Flow rate chart

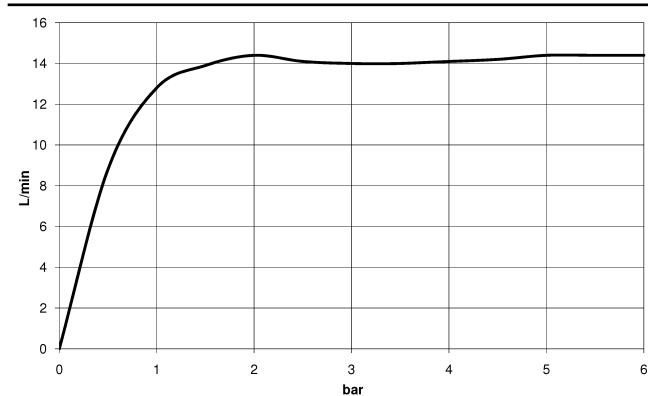

Codes & Standards

DIN 4109

ISO 3822

Ü-Zeichen



EDITION PRO Exposed shower set with shower thermostat with hand shower set - Chrome

EDITION PRO

34 461 626

Certificates and sustainability

LGA_29

34 461 626
Parts for other
finishes can be found
here: [Matte Black](#)

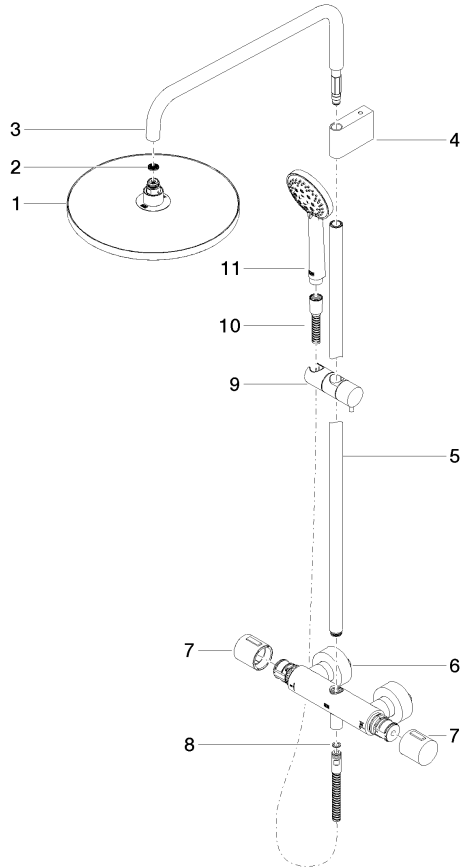

Spare parts list

Number	Item Number	Designation	Number of units	Lead time
2	09 23 01 039 90	sieve	1.00	2
1	04 12 05 091 00-00	shower	1.00	10
10	28 322 626-00	EDITION PRO Metal shower hose 1/2" x 3/8" x 68-7/8" - Chrome	1.00	10
9	12 570 970-00	Slider - Chrome	1.00	10
11	28 018 626-00	EDITION PRO Hand shower - Chrome	1.00	10
5	90 28 22 349 00-00	pipe	1.00	10
3	90 28 22 348 00-00	pipe	1.00	10
4	90 17 11 150 00-00	holder	1.00	10
7	90 17 33 015 00-00	handle	1.00	10
6	04 17 01 350 00-00	connection	1.00	10
8	90 14 20 026 00 90	seal	1.00	2