

META Wall mounted three-way diverter - Brushed Chrome

META

36 210 661

Product version from 4/1/2022



- Manual diverter
 - Handle Ø 2-3/8"

(ADA)

Does not allow for simultaneous use of functions

(ADA)

Does not allow for simultaneous use of functions

	Brushed Chrome	36 210 661-93 0010
	Chrome	36 210 661-00 0010
	Brushed Platinum	36 210 661-06 0010
	Light gold	36 210 661-26 0010
	Brushed Light Gold	36 210 661-27 0010
	Matte Black	36 210 661-33 0010
	Brushed Dark Brass	36 210 661-39 0010
	Brushed Bronze	36 210 661-42 0010
	Brushed Champagne (22kt Gold)	36 210 661-46 0010
	Brushed Dark Platinum	36 210 661-99 0010

Required article



- Wall mounted three-way diverter -

35 203 970-90

 - Max. rough in depth 6-1/4"
 - Min. rough in depth 4-1/2"

0010



META Wall mounted three-way diverter - Brushed Chrome

META

36 210 661 Product version from 4/1/2022

mm [inches]

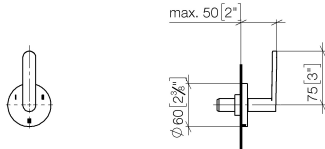

Codes & Standards

ADA	ASME A112.18.1	California Energy Commission (CEC)	cUPC
-----	----------------	------------------------------------	------

Certificates and sustainability

IAPMO_4976 (

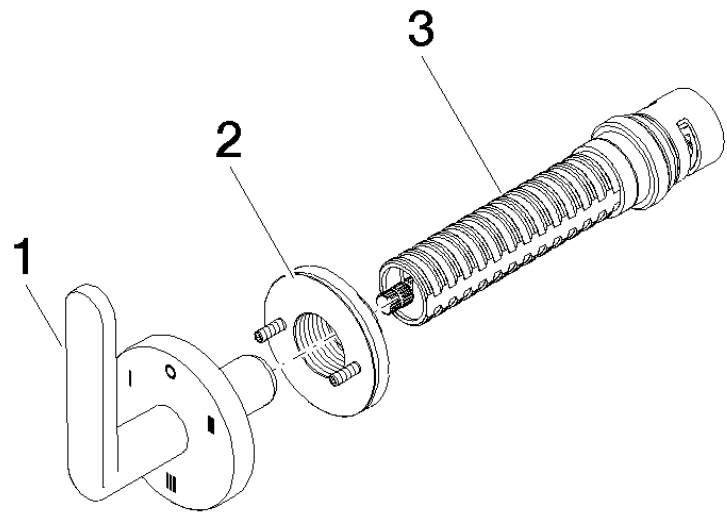

Spare parts list

Number	Item Number	Designation	Number of units	Lead time
1	90 20 66 014 03-93	handle	1.00	20
2	90 21 02 181 00 90	disc	1.00	2
3	90 90 03 305 10 90	diverter	1.00	2