

**TARA Volume Control clockwise-closing 1/2" - Chrome**

TARA

36 607 892    Product version up to 10/27/2020



- Flange diameter 2-1/8"
- Ceramic disc cartridge  
**(ADA)**
- (ADA)

	Chrome	36 607 892-00
	Brushed Platinum	36 607 892-06
	Platinum	36 607 892-08
	Dark Chrome	36 607 892-19
	Brushed Durabrass (23kt Gold)	36 607 892-28
	Matte Black	36 607 892-33
	Brushed Dark Brass	36 607 892-39
	Brushed Bronze	36 607 892-42
	Brushed Champagne (22kt Gold)	36 607 892-46
	Champagne (22kt Gold)	36 607 892-47
	Brushed Chrome	36 607 892-93
	Brushed Dark Platinum	36 607 892-99

**Required article**



- Rough for volume control 1/2" -**    35 607 970-90  
 •Max. rough in depth 5-3/4"    0010  
 •Min. rough in depth 3-3/8"



TARA Volume Control clockwise-closing 1/2" - Chrome

TARA

36 607 892    Product version up to 10/27/2020

mm [inches]

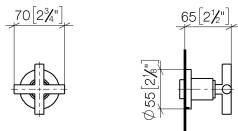

Codes & Standards

ADA	ASME A112.18.1	cUPC	DIN 4109
EN 1111	EN 200	ISO 3822	Scottish Water Byelaws
UK Water Supply Regulations	Ü-Zeichen		

Certificates and sustainability

DVGW_DW-6501DN0	WRAS_2011	LGA_29	WRAS_2010	DVGW_DW-6512DN0
LGA_29	IAPMO_4976 (			



## Spare parts list

Number	Item Number	Designation	Number of units	Lead time
11	09 21 02 144-00	sleeve	1.00	10
1	90 90 03 143 00 90	top	1.00	2
10	90 12 12 002 00 90	fixing cap	1.00	2
16	09 20 89 010-00	handle	1.00	60
8	09 29 06 022 90	spindle	1.00	2
7	09 24 05 002 90	nipple	1.00	2
3	90 21 02 108 00 90	disc	1.00	2
15	90 12 12 007 00-00	base	1.00	10
4	09 27 89 108-00	rosette	1.00	10
5	90 31 11 007 00 90	pin	1.00	2
12	90 20 89 010 10-00	handle	1.00	10
6	90 14 15 020 03 90	ring	1.00	2
14	90 30 11 029 00 90	disc	1.00	2
9	90 14 10 060 00 90	seal	1.00	2
2	90 23 30 023 00 90	nut	1.00	2
13	90 30 30 075 00 90	screw	1.00	2