







CL.1 Volume Control counter-clockwise closing hot 1/2" - Chrome

CL.1

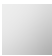
36 627 707 Product version up to 10/14/2020



- CASCADE structure
 - Flange 2-3/8" x 2-3/8"
 - with marking for hot
 - Ceramic disc cartridge
(ADA)
- (ADA)

	Chrome	36 627 707-00
	Brushed Platinum	36 627 707-06
	Dark Chrome	36 627 707-19
	Brushed Champagne (22kt Gold)	36 627 707-46
	Champagne (22kt Gold)	36 627 707-47
	Brushed Dark Platinum	36 627 707-99

Required article



- Rough for volume control 1/2" -** 35 607 970-90
•Max. rough in depth 5-7/8" 0010
•Min. rough in depth 4-1/8"



CL.1 Volume Control counter-clockwise closing hot 1/2" - Chrome

CL.1

36 627 707 Product version up to 10/14/2020

mm [inches]

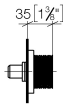
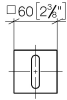

Codes & Standards

ADA	ASME A112.18.1	cUPC	DIN 4109
EN 200	ISO 3822	Scottish Water Byelaws	UK Water Supply Regulations
Ü-Zeichen			

Certificates and sustainability

DVGW_DW- 6501DN0	LGA_29	WRAS_2010	LGA_29	IAPMO_4976 (
---------------------	--------	-----------	--------	--------------

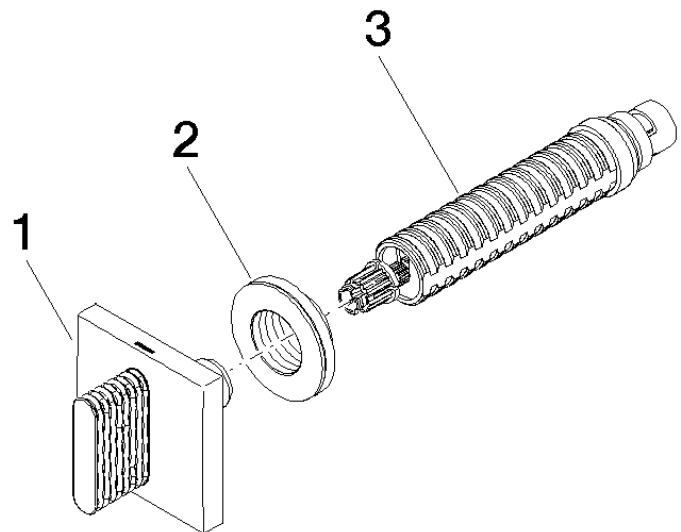

Spare parts list

Number	Item Number	Designation	Number of units	Lead time
2	09 21 02 108 90	disc	1.00	60
1	90 20 70 053 03-00	handle (hot)	1.00	10
3	90 90 03 142 00 90	top	1.00	2