











CL.1 Volume Control counter-clockwise closing hot 1/2" - Brushed Dark Platinum

CL.1

36 627 707	Product version up to 10/14/2020		
	<ul style="list-style-type: none"><li>• CASCADE structure</li><li>• Flange 2-3/8" x 2-3/8"</li><li>• with marking for hot</li><li>• Ceramic disc cartridge (ADA)</li></ul>		
	(ADA)		Brushed Dark Platinum 36 627 707-99
			Chrome 36 627 707-00
			Brushed Platinum 36 627 707-06
			Dark Chrome 36 627 707-19
			Brushed Champagne (22kt Gold) 36 627 707-46
			Champagne (22kt Gold) 36 627 707-47

Required article

	<b>Rough for volume control 1/2" -</b>	35 607 970-90
	<ul style="list-style-type: none"><li>•Max. rough in depth 5-7/8"</li><li>•Min. rough in depth 4-1/8"</li></ul>	0010



CL.1 Volume Control counter-clockwise closing hot 1/2" - Brushed Dark Platinum

CL.1

36 627 707    Product version up to 10/14/2020

mm [inches]



Codes & Standards			
ADA	ASME A112.18.1	cUPC	DIN 4109
EN 200	ISO 3822	Scottish Water Byelaws	UK Water Supply Regulations
Ü-Zeichen			

Certificates and sustainability				
DVGW_DW-6501DN0	LGA_29	WRAS_2010	LGA_29	IAPMO_4976 (

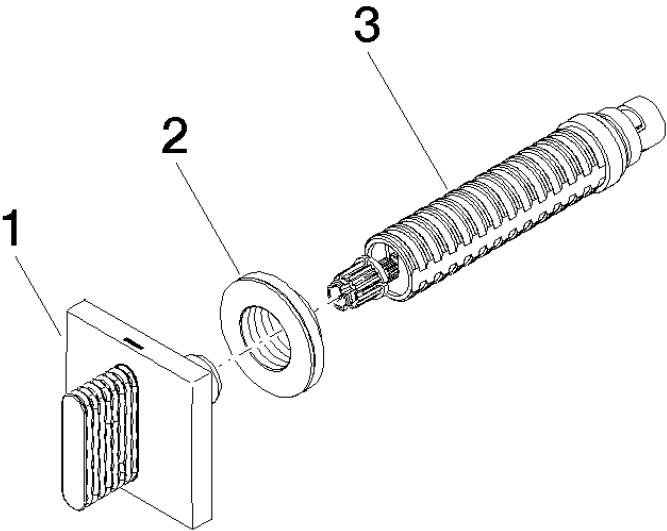

Spare parts list

Number	Item Number	Designation	Number of units	Lead time
3	90 90 03 142 00 90	top	1.00	2
1	90 20 70 053 03-99	handle ( hot )	1.00	20
2	09 21 02 108 90	disc	1.00	60