



MEM Wall-mounted three-hole lavatory mixer without drain - Platinum

36 707 782 Product version from 10/27/2020



- 6-3/4" Projection
 - Rigid spout
 - Rectangular aerated stream
 - Valve hole diameter 1-5/8"
 - Spout hole diameter 1-5/8"
 - Individual flanges 2-3/8" x 2-3/8"
 - Water flow rate limited to max. 1.2 gpm
 - lead-free
 - This product can help a building meet the requirements of Green Building Rating Systems, e.g. LEED®, BREEAM®, DGNB
- (ADA)**

(ADA)

Required article



- Rough for wall-mounted faucet ,
spout in center -** 35 700 970-90
0010
- Max. rough in depth "
 - Min. rough in depth "

Required article



- Rough for wall-mounted faucet
flexible positioning -** 35 720 970-90
0010
- Max. rough in depth "
 - Min. rough in depth "



MEM Wall-mounted three-hole lavatory mixer without drain - Platinum

36 707 782 Product version from 10/27/2020

mm [inches]

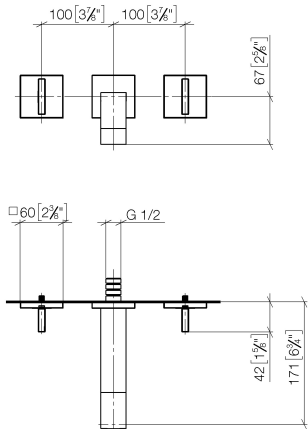

Codes & Standards

ADA	ASME A112.18.1	ASME A112.18.1/CSA B125.1	California Energy Commission (CEC)
cUPC	EPA WaterSense	NSF/ANSI 372	NSF/ANSI/CAN 61
NSF372	NSF61	Water Sense	WaterSense



Certificates

IAPMO_N-4976	IAPMO_6397	IAPMO_8834	IAPMO_4976 (
--------------	------------	------------	--------------

MEM Wall-mounted three-hole lavatory mixer without drain - Platinum

36 707 782 Product version from 10/27/2020

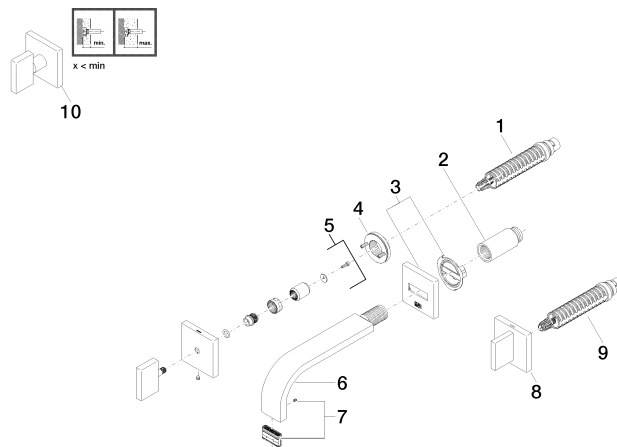

Spare parts list

Number	Item Number	Designation	Number of units	Lead time
1	90 90 03 156 00 90	top	1	2
2	09 24 03 081 10 90	extension	1	2
3	90 27 78 035 00-08	rosette	1	40
4	90 21 02 108 00 90	disc	2	2
5	90 20 78 002 07-08	handle (hot)	1	40
6	04 28 22 150 10-08	spout	1	40
7	90 29 03 118 00 90	aerator	1	2
8	90 20 78 002 06-08	handle (cold)	1	40
9	90 90 03 157 00 90	top	1	2
10	90 20 78 002 01-08	handle	1	40